









-  STONE RIPRAP
-  SURFACE REMOVAL 2" - SPECIAL
-  REMOVE AND REPLACE PAVEMENT AND SIDEWALK
-  CLASS D PATCHES
-  SCARIFY EXISTING SURFACE
-  PIPE AND INLET PROTECTION
-  PERIMETER EROSION BARRIER

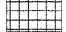

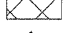
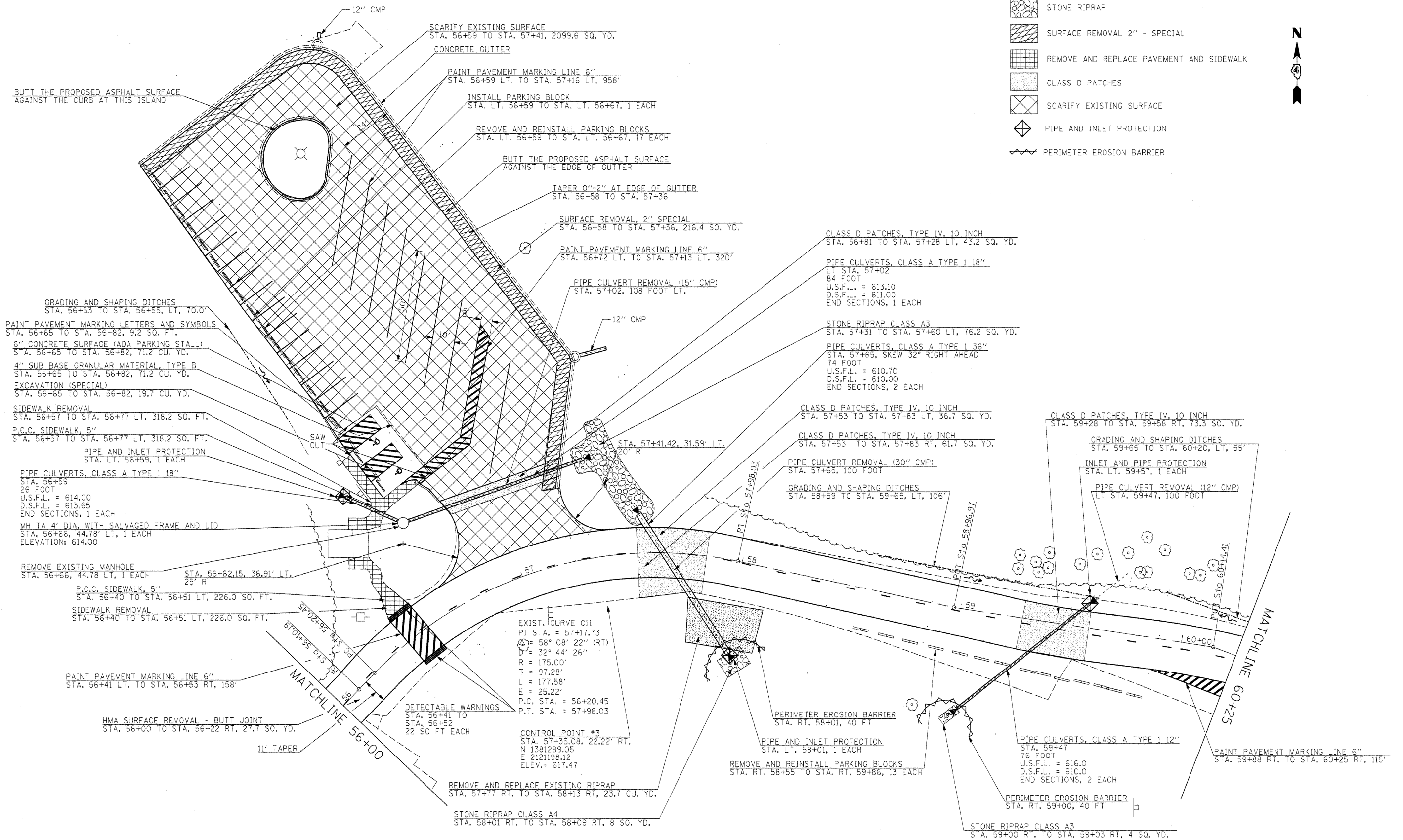
FILE NAME =	USER NAME = #USER#	DESIGNED - R.H.D.	REVISED -	STATE OF ILLINOIS DEPARTMENT OF TRANSPORTATION	ARGYLE LAKE STATE PARK	F.A. RTE.	SECTION	COUNTY	TOTAL SHEETS	SHEET NO.	
#FILE#		DRAWN - J.T.T.	REVISED -			ARGYLE LAKE STATE PARK	MCDONOUGH	162	28		
		CHECKED - T.T.P.	REVISED -			CONTRACT NO. 46158					
		DATE - 12/09/10	REVISED -			SCALE: 1" = 20'		SHEET NO. 28 OF 162 SHEETS		STA. 56+00 TO STA. 60+25	
						FED. ROAD DIST. NO.		ILLINOIS FED. AID PROJECT			