

TREE REMOVAL (EXISTING)		
STA.	OFFSET	SIZE
102+09.29LT	14'	9"
102+14.57LT	15'	17"
102+15.23LT	22'	7"
102+19.13LT	13'	15"
102+19.86LT	35'	15"
102+28.30LT	30'	17"
102+31.68LT	19'	7"
102+33.26RT	22'	18"
102+34.09RT	17'	6"
102+37.51LT	17'	14"
102+43.72LT	21'	9"
102+45.58LT	29'	19"
102+58.08LT	26'	24"
102+58.43LT	35'	9"
102+70.94LT	22'	10"
102+71.79LT	25'	12"
106+19.52RT	13'	17"

- TEMPORARY DITCH CHECK
- PERIMETER EROSION BARRIER
- STEEL PLATE BEAM GUARDRAIL REMOVAL
- PAVEMENT REMOVAL
- STONE RIPRAP

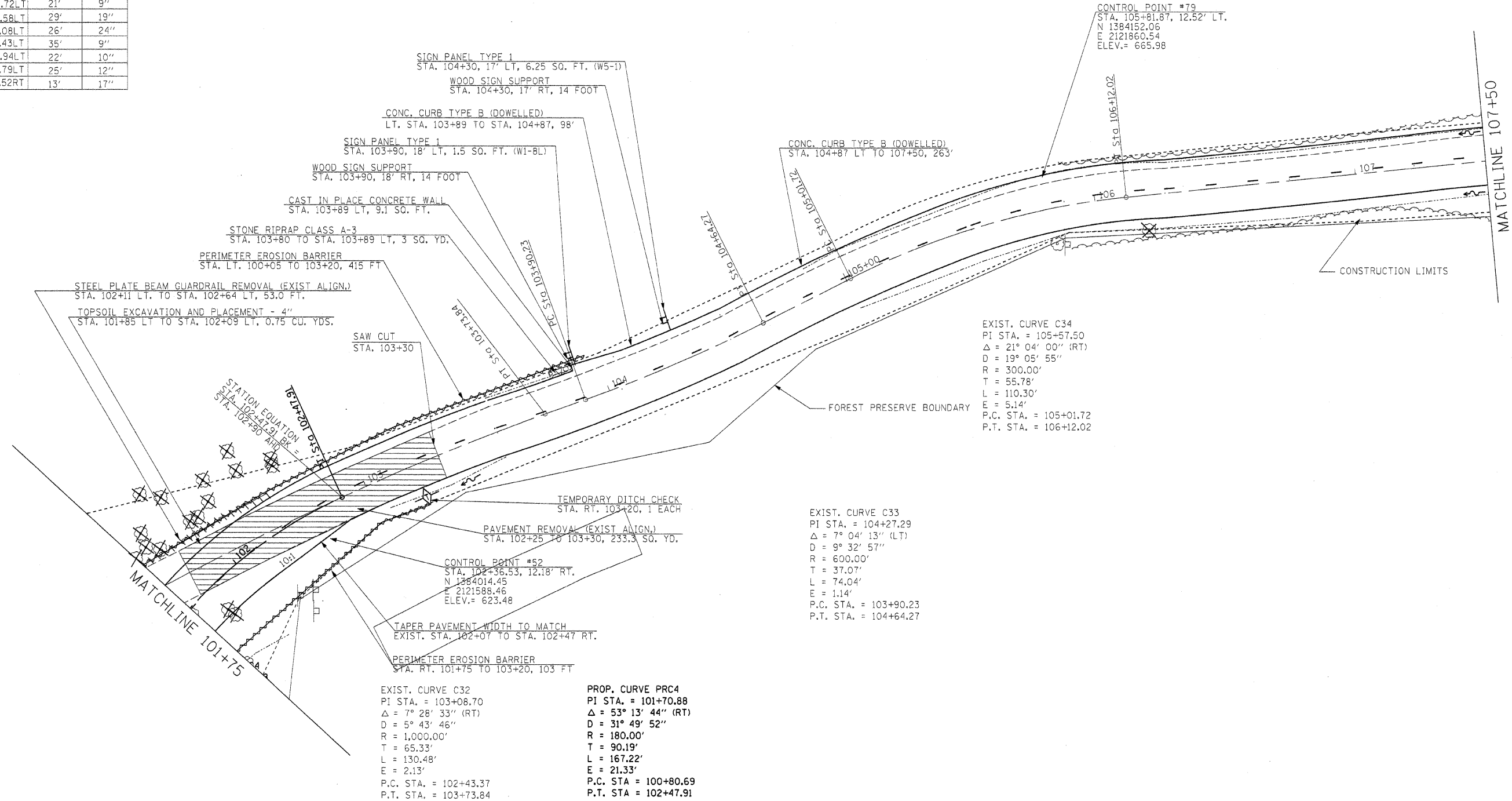

EXIST. CURVE C34
 PI STA. = 105+57.50
 $\Delta = 21^\circ 04' 00''$ (RT)
 $D = 19^\circ 05' 55''$
 $R = 300.00'$
 $T = 55.78'$
 $L = 110.30'$
 $E = 5.14'$
 P.C. STA. = 105+01.72
 P.T. STA. = 106+12.02

EXIST. CURVE C33
 PI STA. = 104+27.29
 $\Delta = 7^\circ 04' 13''$ (LT)
 $D = 9^\circ 32' 57''$
 $R = 600.00'$
 $T = 37.07'$
 $L = 74.04'$
 $E = 1.14'$
 P.C. STA. = 103+90.23
 P.T. STA. = 104+64.27

EXIST. CURVE C32
 PI STA. = 103+08.70
 $\Delta = 7^\circ 28' 33''$ (RT)
 $D = 5^\circ 43' 46''$
 $R = 1,000.00'$
 $T = 65.33'$
 $L = 130.48'$
 $E = 2.13'$
 P.C. STA. = 102+43.37
 P.T. STA. = 103+73.84

PROP. CURVE PRC4
 PI STA. = 101+70.88
 $\Delta = 53^\circ 13' 44''$ (RT)
 $D = 31^\circ 49' 52''$
 $R = 180.00'$
 $T = 90.19'$
 $L = 167.22'$
 $E = 21.33'$
 P.C. STA = 100+80.69
 P.T. STA = 102+47.91

FILE NAME =	USER NAME = #USER#	DESIGNED - R.H.D.	REVISED -	STATE OF ILLINOIS DEPARTMENT OF TRANSPORTATION	ARGYLE LAKE STATE PARK	F.A. RTE.	SECTION	COUNTY	TOTAL SHEETS	SHEET NO.
#FILEL#		DRAWN - J.T.T.	REVISED -			ARGYLE LAKE STATE PARK	MCDONOUGH	162	37	
PLOT SCALE = #SCALE#		CHECKED - T.T.P.	REVISED -			CONTRACT NO. 46158				
PLOT DATE = #DATE#		DATE - 12/09/10	REVISED -			SCALE: 1" = 20'	SHEET NO. 37 OF 162 SHEETS	STA. 101+75 TO STA. 107+50	FED. ROAD DIST. NO.	ILLINOIS FED. AID PROJECT