

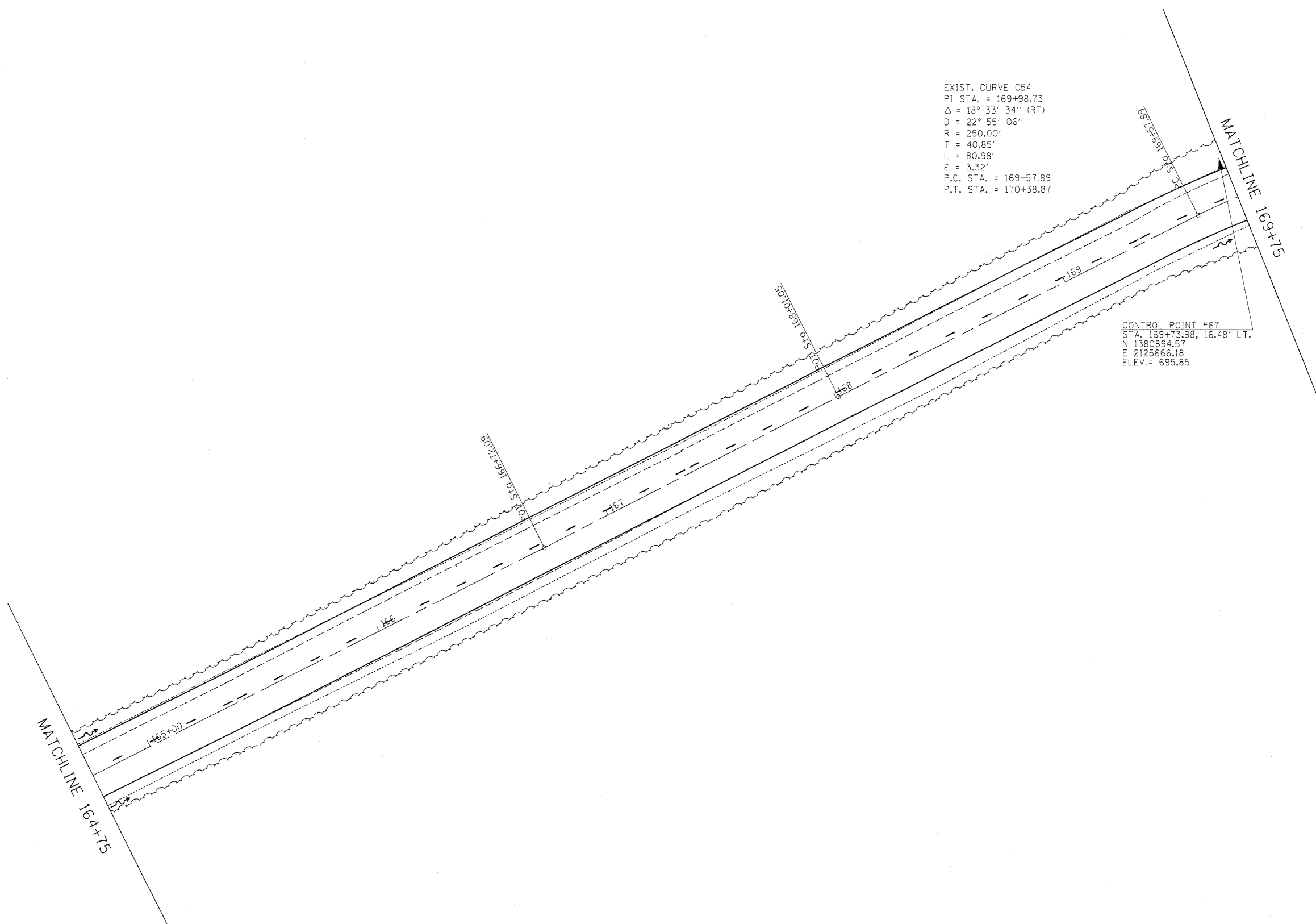

EXIST. CURVE C54
 PI STA. = 169+98.73
 $\Delta = 18^\circ 33' 34''$ (RT)
 $D = 22^\circ 55' 06''$
 $R = 250.00'$
 $T = 40.85'$
 $L = 80.98'$
 $E = 3.32'$
 P.C. STA. = 169+57.89
 P.T. STA. = 170+38.87

CONTROL POINT #67
 STA. 169+73.98, 16.48' LT.
 N 1380894.57
 E 2125666.18
 ELEV. = 695.85



FILE NAME =	USER NAME = #USER#	DESIGNED - R.H.D.	REVISED -
#FILE#		DRAWN - J.T.T.	REVISED -
	PLOT SCALE = #SCALE#	CHECKED - T.T.P.	REVISED -
	PLOT DATE = #DATE#	DATE - 12/09/10	REVISED -

**STATE OF ILLINOIS
 DEPARTMENT OF TRANSPORTATION**

**ARGYLE LAKE STATE PARK
 MAIN ROAD**

SCALE: 1" = 20' SHEET NO. 48 OF 162 SHEETS STA. 164+75 TO STA. 169+75

F.A. RTE.	SECTION	COUNTY	TOTAL SHEETS	SHEET NO.
	ARGYLE LAKE STATE PARK	MCDONOUGH	162	48
			CONTRACT NO. 46158	
FED. ROAD DIST. NO.		ILLINOIS FED. AID PROJECT		