

FINAL SURVEY	SURVEYED	BY	DATE
NOTE BOOK	PLOTTED		
NO.	TEMP. LATE		
	AREAS CHECKED		

ORIGINAL SURVEY	SURVEYED	BY	DATE
NOTE BOOK	PLOTTED		
NO.	TEMP. LATE		
	AREAS CHECKED		

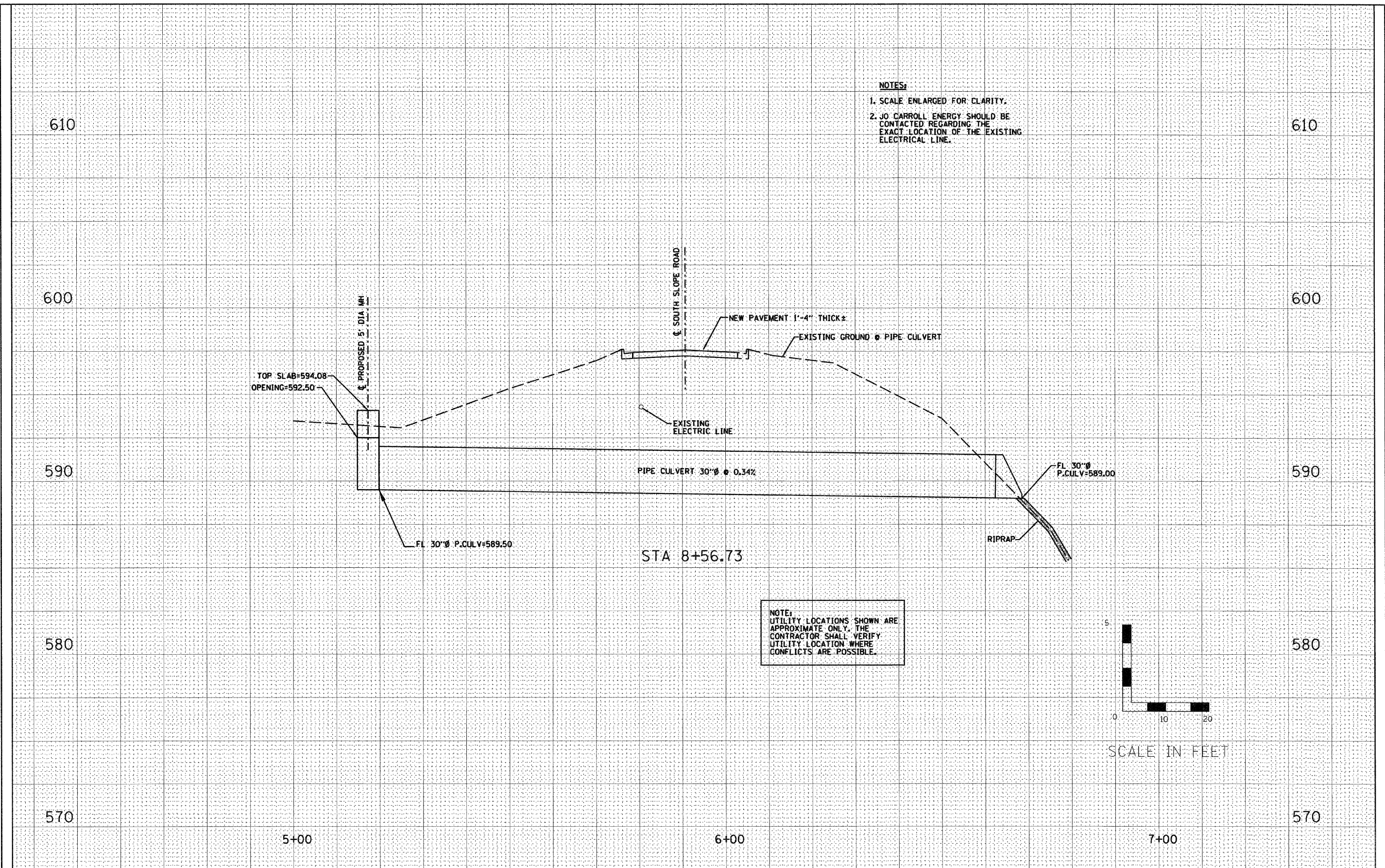

- NOTES:**
1. SCALE ENLARGED FOR CLARITY.
 2. JO CARROLL ENERGY SHOULD BE CONTACTED REGARDING THE EXACT LOCATION OF THE EXISTING ELECTRICAL LINE.

NOTE:
UTILITY LOCATIONS SHOWN ARE APPROXIMATE ONLY. THE CONTRACTOR SHALL VERIFY UTILITY LOCATION WHERE CONFLICTS ARE POSSIBLE.

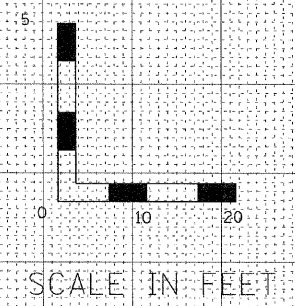

FILE NAME =	USER NAME = #USER*	DESIGNED - PJM	REVISED -	STATE OF ILLINOIS DEPARTMENT OF TRANSPORTATION	SOUTH SLOPE ROAD PIPE CULVERT CROSS SECTION		F.A. RTE.	SECTION	COUNTY	TOTAL SHEETS	SHEET NO.
#FILE#		DRAWN - DRR	REVISED -		SCALE:	SHEET NO. 21A OF 36 SHEETS	STA.		JO CARROLL	36	21A
		CHECKED - PJM	REVISED -				TO STA.		CONTRACT NO. 46166		
		DATE - 03-14-11	REVISED -					FED. ROAD DIST. NO.	ILLINOIS FED. AID PROJECT		