

MATCH LINE SEE DRAWING EX-10 WEST FRONTAGE CONNECTOR STA. 6064+50.00  
 MATCH LINE SEE DRAWING EX-10 ARSENAL RD STA. 947+00.00

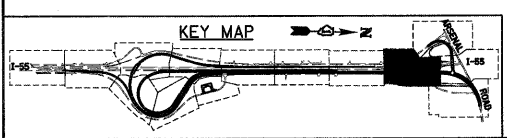
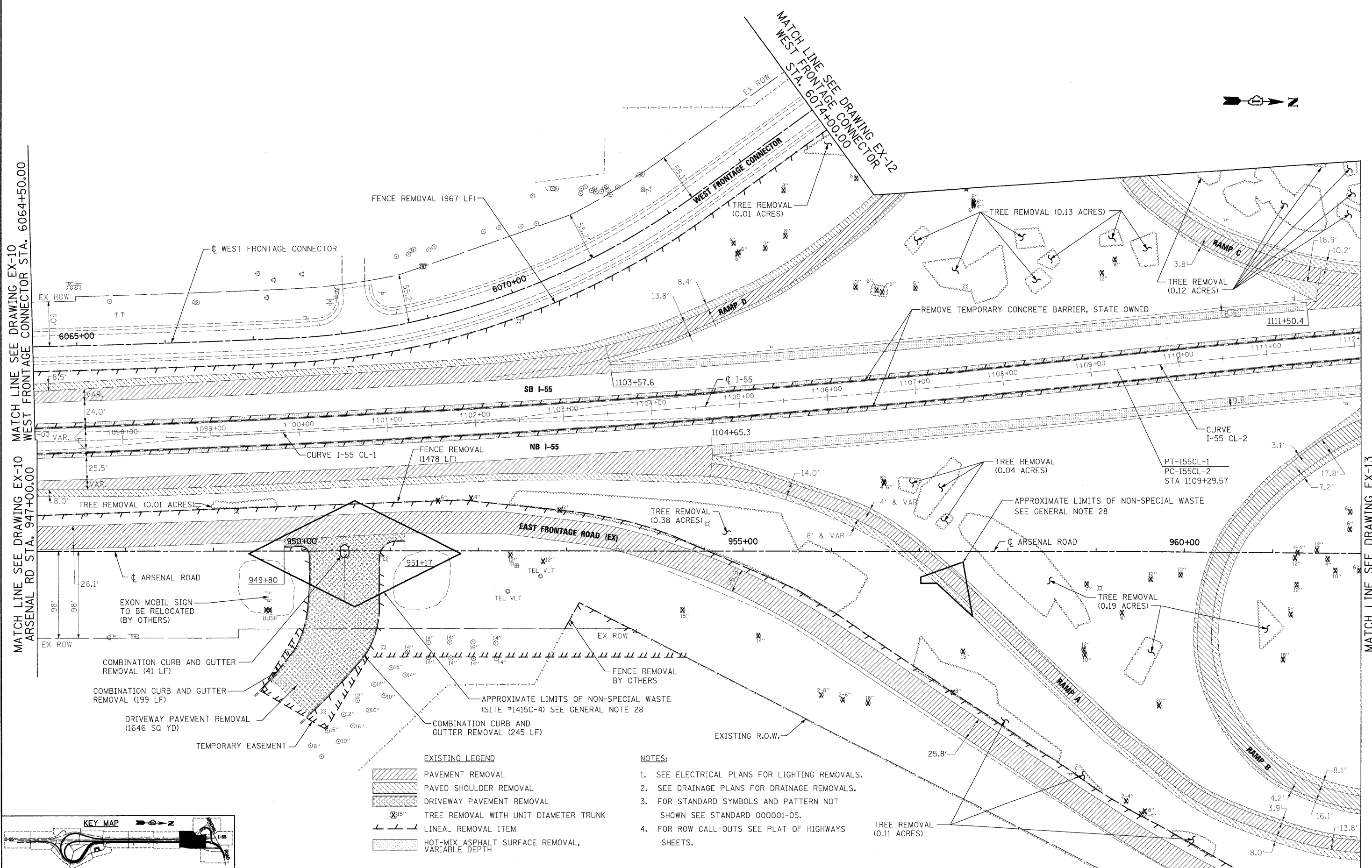

**EXISTING LEGEND**

[Hatched Pattern]	PAVEMENT REMOVAL
[Dotted Pattern]	PAVED SHOULDER REMOVAL
[Cross-hatched Pattern]	DRIVEWAY PAVEMENT REMOVAL
[Circle with X]	TREE REMOVAL WITH UNIT DIAMETER TRUNK
[Dashed Line]	LINEAL REMOVAL ITEM
[Stippled Pattern]	HOT-MIX ASPHALT SURFACE REMOVAL, VARIABLE DEPTH

- NOTES:**
1. SEE ELECTRICAL PLANS FOR LIGHTING REMOVALS.
  2. SEE DRAINAGE PLANS FOR DRAINAGE REMOVALS.
  3. FOR STANDARD SYMBOLS AND PATTERN NOT SHOWN SEE STANDARD 000001-05.
  4. FOR ROW CALL-OUTS SEE PLAT OF HIGHWAYS SHEETS.

FILE NAME = D16212-SHT-REM1.dgn  
 USER NAME = TK.uegl

DESIGNED - JTF  
 DRAWN - JTF  
 CHECKED - DLT  
 DATE - 2/4/11

REVISED -  
 REVISED -  
 REVISED -  
 REVISED -

**STATE OF ILLINOIS  
 DEPARTMENT OF TRANSPORTATION**

**EXISTING PLAN AND REMOVALS**

SCALE: 1"=50' SHEET NO. 11 OF 15 SHEETS STA. TO STA.

F.A.I. RTE.	SECTION	COUNTY	TOTAL SHEETS	SHEET NO.
55	99-2HB-28-1	WILL	756	53
CONTRACT NO. 60F12				
FED. ROAD DIST. NO. 1 ILLINOIS FED. AID PROJECT				

MATCH LINE SEE DRAWING EX-13 ARSENAL RD STA. 962+00.00