

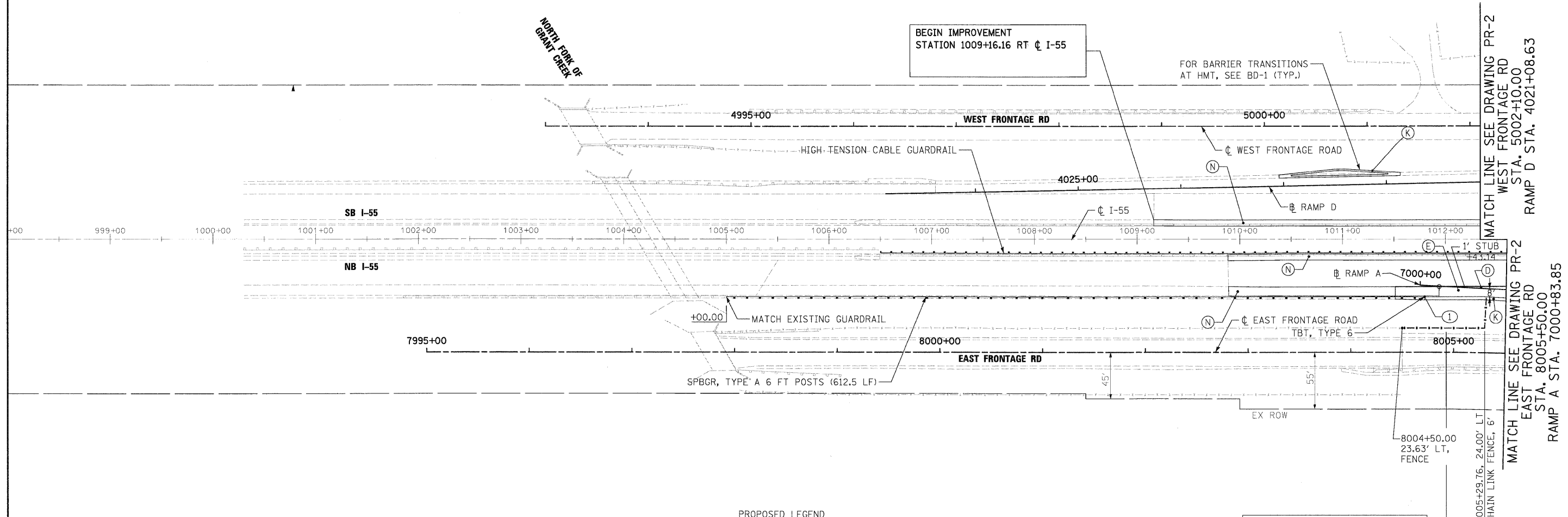

NO.	STATION	OFFSET
①	7000+05.00	11.16' RT



- PROPOSED LEGEND**
- (A) PCC PAVEMENT 10" (JOINTED)
 - (B) PCC SHOULDERS, 10"
 - (C) AGGREGATE SHOULDERS, TYPE B 10"
 - (D) HMA PAVEMENT (SEE TYPICAL SECTIONS)
 - (E) HMA SHOULDERS (SEE TYPICAL SECTIONS)
 - (F) CONCRETE MEDIAN SURFACE, 4 INCH
 - (G) CONCRETE MEDIAN RAMP NOSE (SEE STD 606301-04)
PAID FOR AS CONCRETE MEDIAN, TYPE SB-6.24 (MODIFIED)
 - (H) CONCRETE MEDIAN, TYPE SB 6.24 (MODIFIED)
 - (I) COMBINATION CONCRETE CURB & GUTTER TYPE B-6.24
 - (J) COMBINATION CONCRETE CURB & GUTTER TYPE M-2.24
 - (K) CONCRETE BARRIER, DOUBLE FACE, 42" HEIGHT
 - (L) IMPACT ATTENUATOR FULLY REDIRECTIVE NARROW TEST LEVEL 3
 - (M) CORRUGATED MEDIAN
 - (N) HMA SHOULDER CROSS SLOPE CORRECTION
 - (Z) STATION OFFSET
- FENCE AS INDICATED IN PLANS

STA 1012+00.78, 45.91' RT @ I-55 =
STA 7000+25.37 @ RAMP A

NOTE:
1. FOR CURVE DATA SEE ALIGNMENTS, TIES AND BENCHMARKS DRAWING NOS. AT-1 TO AT-9
2. FOR ROW CALL-OUTS SEE PLAT OF HIGHWAY SHEETS

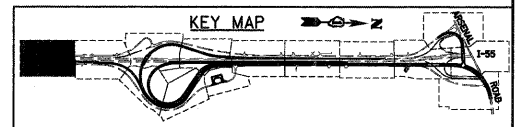

McDonough Associates Inc.
 Engineers / Architects
 130 East Randolph Street, Chicago, Illinois 60601

FILE NAME = D160F12-SH1-PLAN01.dgn	USER NAME = TKluagel	DESIGNED - JTF	REVISED -
		DRAWN - JTF	REVISED -
		CHECKED - DLT	REVISED -
		DATE - 2/4/11	REVISED -

**STATE OF ILLINOIS
DEPARTMENT OF TRANSPORTATION**

PROPOSED PLAN

SCALE: 1"=50' SHEET NO. 1 OF 15 SHEETS STA. TO STA.

F.A.I. RTE.	SECTION	COUNTY	TOTAL SHEETS	SHEET NO.
55	99-2HB-2B-1	WILL	756	59

CONTRACT NO. 60F12

FED. ROAD DIST. NO. 1 ILLINOIS FED. AID PROJECT