

MAINTENANCE OF TRAFFIC LEGEND

- WORK ZONE (CURRENT STAGE)
- WORK ZONE (CONTD. FROM PREVIOUS STAGE)
- DIRECTION OF TRAFFIC
- PLASTIC DRUMS, SPACING AS SHOWN
- TEMPORARY PAVEMENT (INSTALLED IN CURRENT STAGE)
- TEMPORARY PAVEMENT (INSTALLED IN PREVIOUS STAGE)
- ARROW BOARD
- TEMPORARY IMPACT ATTENUATOR, TL 3
- TEMP. CONC. BARRIER W/ PRISMATIC REFLECTORS @ 25 FT CTRS.
- VERTICAL PANELS, SPACING AS SHOWN

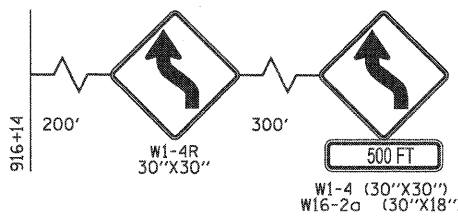

SOUTHBOUND ARSENAL ROAD
(ADVANCE LANE SHIFT SIGNS)

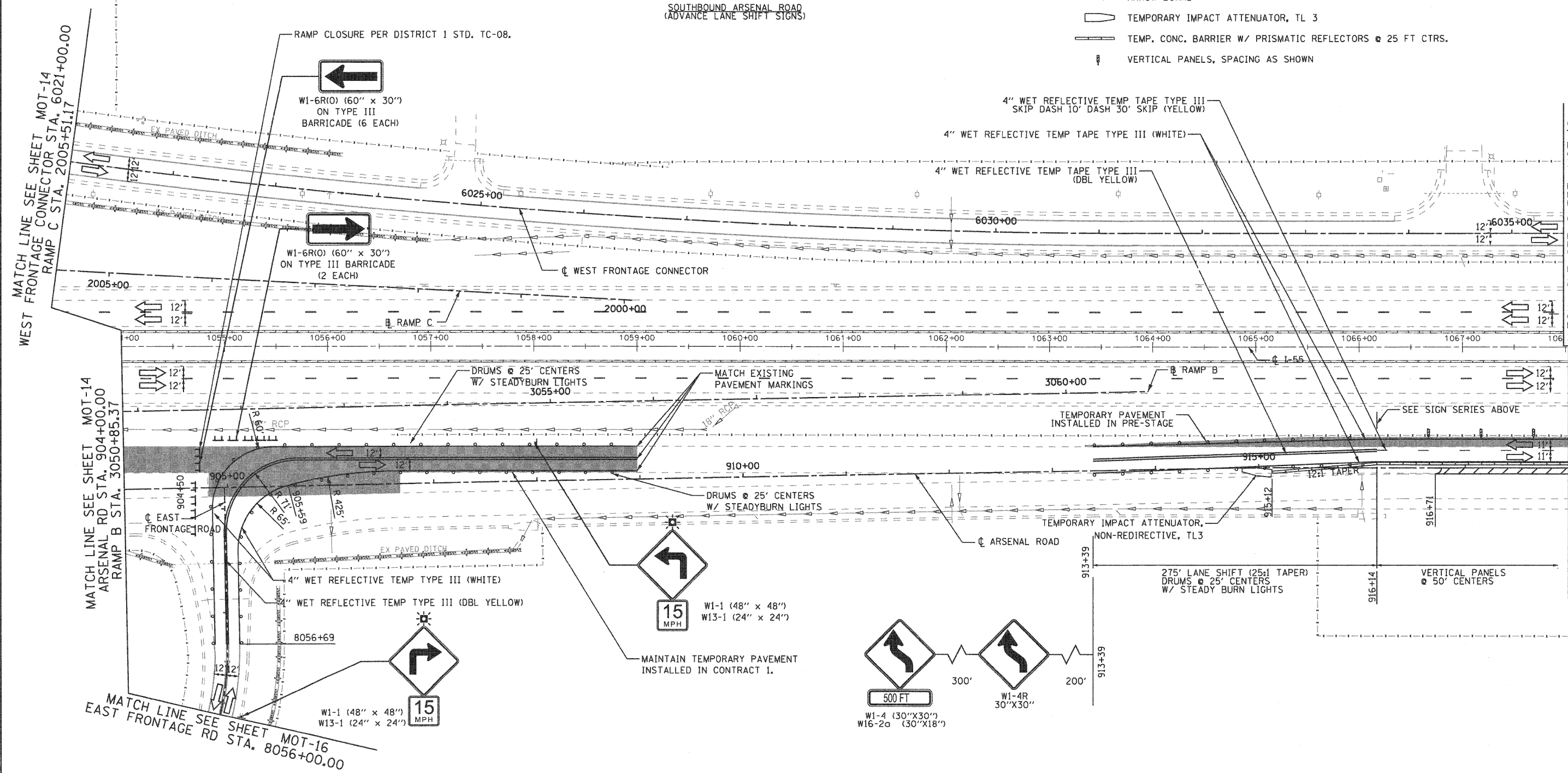

MATCH LINE SEE SHEET MOT-14
WEST FRONTAGE CONNECTOR STA. 6021+00.00
RAMP C STA. 2005+51.17

MATCH LINE SEE SHEET MOT-18
WEST FRONTAGE CONNECTOR STA. 6035+50.00
MATCH LINE SEE SHEET MOT-18
ARSENAL RD STA. 918+00.00

MATCH LINE SEE SHEET MOT-16
EAST FRONTAGE RD STA. 8056+00.00

EJM ENGINEERING, INC.
411 South Wells Street Suite 800
Chicago, Illinois 60607

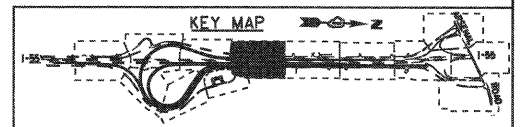

FILE NAME = ...ND168F12-SHT-STAGING108.dgn	USER NAME = gao	DESIGNED - GR	REVISED -
		DRAWN - GR	REVISED -
		CHECKED - RY	REVISED -
		DATE - 02/04/2011	REVISED -

STATE OF ILLINOIS
DEPARTMENT OF TRANSPORTATION

MAINTENANCE OF TRAFFIC
STAGE 1

SCALE: 1"=50' SHEET NO. 7 OF 13 SHEETS STA. TO STA.

F.A.I. RTE. 55	SECTION 99-2HB-2B-1	COUNTY WILL	TOTAL SHEETS 756	SHEET NO. 103
FED. ROAD DIST. NO. 1 ILLINOIS FED. AID PROJECT			CONTRACT NO. 60F12	

FINAL