

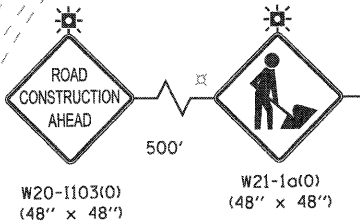

NOTE
 1. BUILD EMBANKMENT FOR WEST FRONTAGE CONNECTOR FROM STA. 6083+00 TO STA. 6087+00.

- MAINTENANCE OF TRAFFIC LEGEND**
- WORK ZONE (CURRENT STAGE)
 - WORK ZONE (CONTD. FROM PREVIOUS STAGE)
 - DIRECTION OF TRAFFIC
 - PLASTIC DRUMS, SPACING AS SHOWN
 - TEMPORARY PAVEMENT (INSTALLED IN CURRENT STAGE)
 - TEMPORARY PAVEMENT (INSTALLED IN PREVIOUS STAGE)
 - ARROW BOARD
 - TEMPORARY IMPACT ATTENUATOR, TL 3
 - TEMP. CONC. BARRIER W/ PRISMATIC REFLECTORS @ 25 FT CTRS.
 - VERTICAL PANELS, SPACING AS SHOWN

PROVIDE CONTRACTOR ACCESS TO INTERCHANGE INFIELD FOR BUILDING EMBANKMENT FOR WEST FRONTAGE CONNECTOR. INSTALLATION AND MAINTENANCE OF CONTRACTOR ACCESS SHALL BE INCIDENTAL TO TRAFFIC CONTROL AND PROTECTION PAY ITEM. ACCESS TO WORK ZONE IN INTERCHANGE INFIELD SHALL NOT BE ALLOWED FROM THE RAMPS.

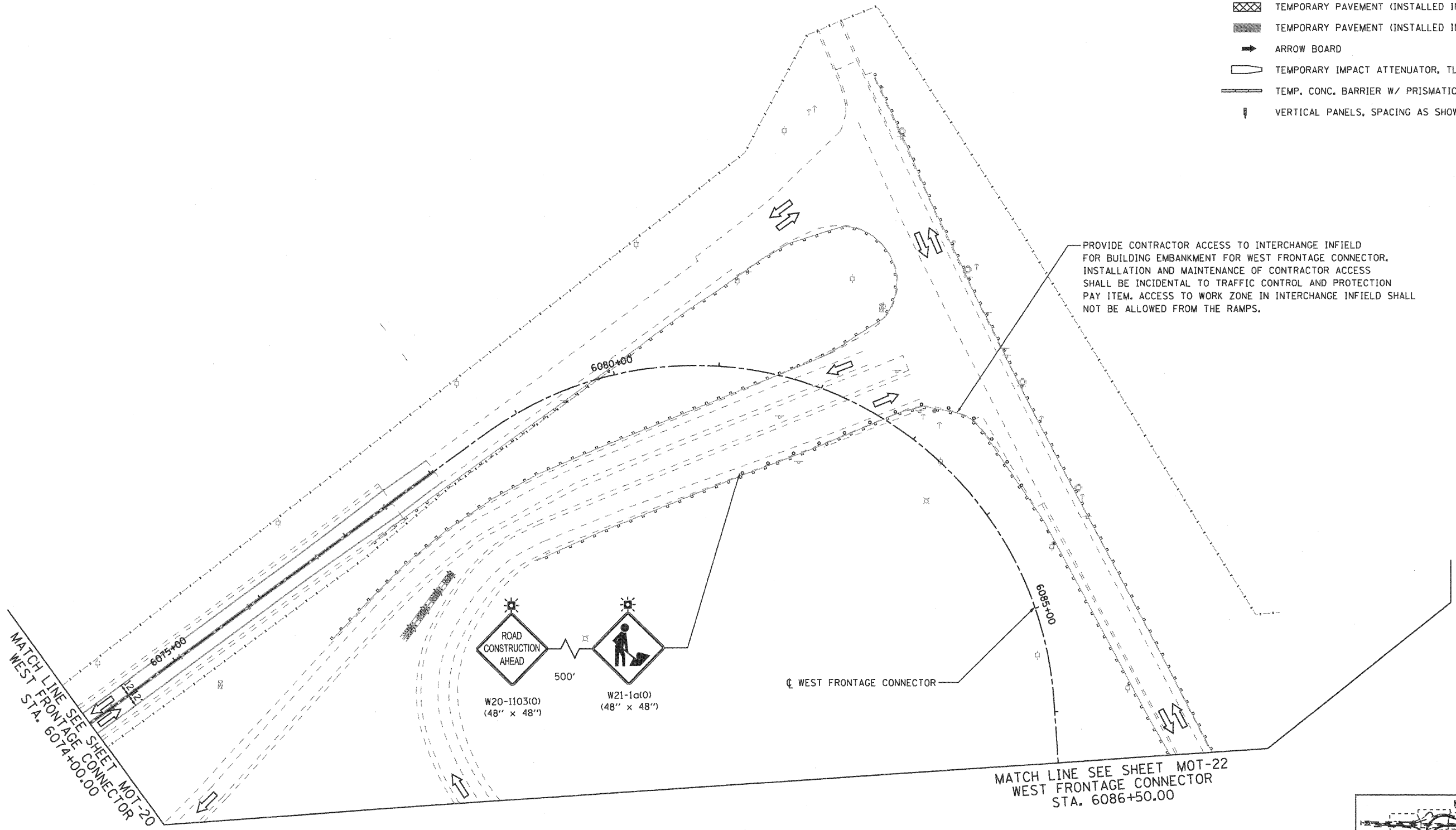

EJM ENGINEERING, INC.
 411 South Wells Street Suite 800
 Chicago, Illinois 60607



MATCH LINE SEE SHEET MOT-20
 WEST FRONTAGE CONNECTOR
 STA. 6074+00.00

MATCH LINE SEE SHEET MOT-22
 WEST FRONTAGE CONNECTOR
 STA. 6086+50.00

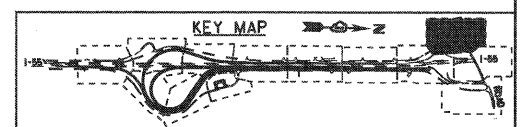

FILE NAME = ...\\D160F12-SHT-STAGING112.dgn	USER NAME = gpa1	DESIGNED - GR	REVISED -
		DRAWN - GR	REVISED -
		CHECKED - RY	REVISED -
		DATE - 02/04/2011	REVISED -

**STATE OF ILLINOIS
 DEPARTMENT OF TRANSPORTATION**

**MAINTENANCE OF TRAFFIC
 STAGE 1**

SCALE: 1"=50' SHEET NO. 11 OF 13 SHEETS STA. TO STA.

F.A.I. RTE.	SECTION	COUNTY	TOTAL SHEETS	SHEET NO.
55	99-2HB-2B-1	WILL	756	107
				CONTRACT NO. 60F12
FED. ROAD DIST. NO. 1 ILLINOIS FED. AID PROJECT				

FINAL