

- MAINTENANCE OF TRAFFIC LEGEND**
- WORK ZONE (CURRENT STAGE)
 - WORK ZONE (CONTD. FROM PREVIOUS STAGE)
 - DIRECTION OF TRAFFIC
 - PLASTIC DRUMS, SPACING AS SHOWN
 - TEMPORARY PAVEMENT (INSTALLED IN CURRENT STAGE)
 - TEMPORARY PAVEMENT (INSTALLED IN PREVIOUS STAGE)
 - ARROW BOARD
 - TEMPORARY IMPACT ATTENUATOR, TL 3
 - TEMP. CONC. BARRIER W/ PRISMATIC REFLECTORS @ 25 FT CTRS.
 - VERTICAL PANELS, SPACING AS SHOWN

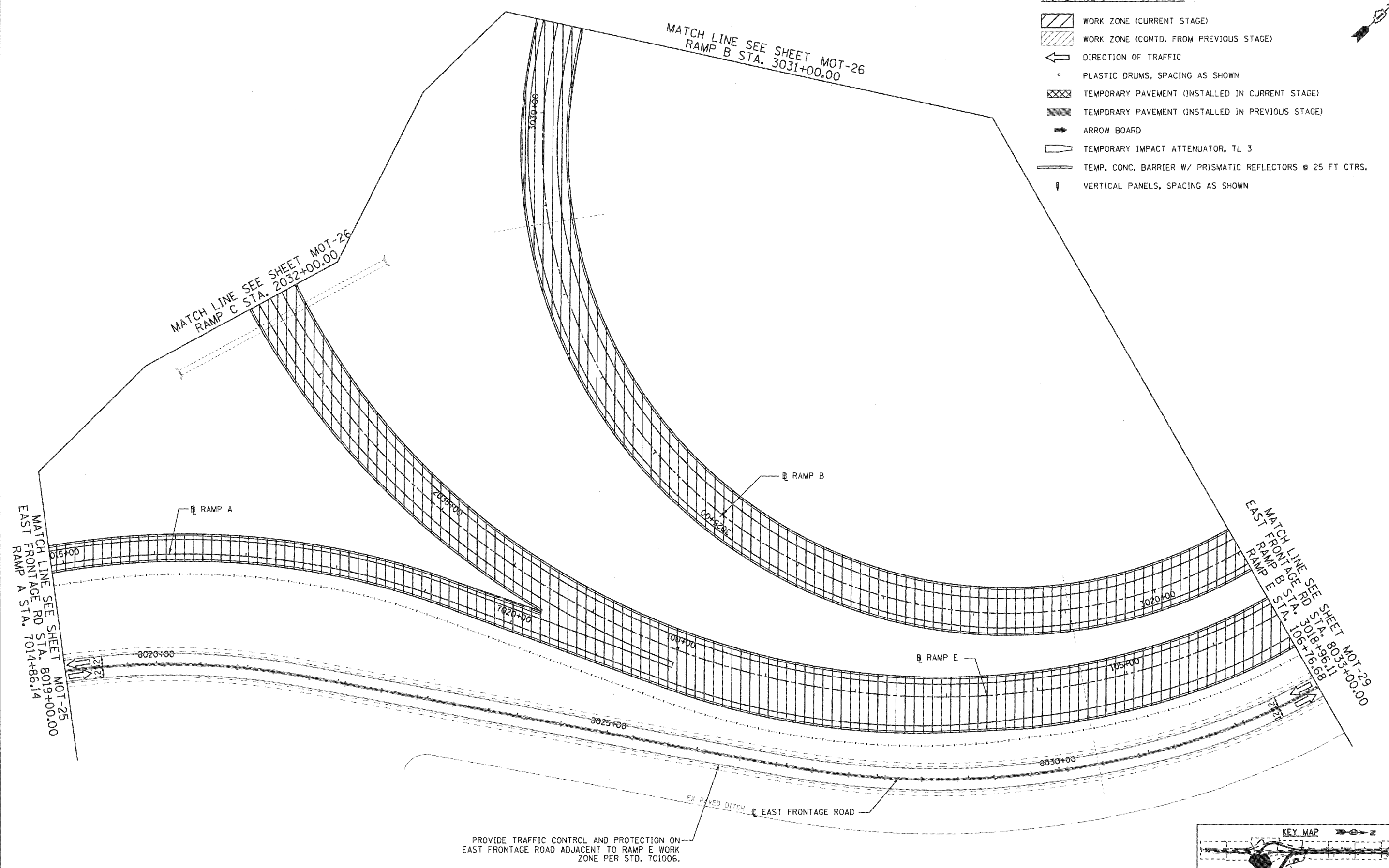

PROVIDE TRAFFIC CONTROL AND PROTECTION ON EAST FRONTAGE ROAD ADJACENT TO RAMP E WORK ZONE PER STD. 701006.

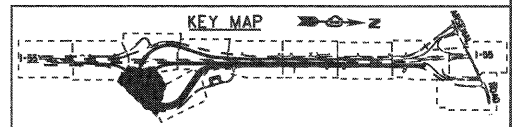

EJM ENGINEERING, INC.
411 South Wells Street Suite 800
Chicago, Illinois 60607



FILE NAME =	USER NAME = grs
...\\D168F12-SHT-STAGING204.dgn	

DESIGNED - GR	REVISED -
DRAWN - GR	REVISED -
CHECKED - RY	REVISED -
DATE - 02/04/2011	REVISED -

DESIGNED - GR	REVISED -
DRAWN - GR	REVISED -
CHECKED - RY	REVISED -
DATE - 02/04/2011	REVISED -

**STATE OF ILLINOIS
DEPARTMENT OF TRANSPORTATION**

**MAINTENANCE OF TRAFFIC
STAGE 2**

SCALE: 1"=50' SHEET NO. 4 OF 12 SHEETS STA. TO STA.

F.A.1 RTE.	SECTION	COUNTY	TOTAL SHEETS	SHEET NO.
55	99-2HB-2B-1	WILL	756	113
FED. ROAD DIST. NO. 1 ILLINOIS FED. AID PROJECT			CONTRACT NO. 60F12	

FINAL