

- MAINTENANCE OF TRAFFIC LEGEND**
- WORK ZONE (CURRENT STAGE)
  - WORK ZONE (CONTD. FROM PREVIOUS STAGE)
  - DIRECTION OF TRAFFIC
  - PLASTIC DRUMS, SPACING AS SHOWN
  - TEMPORARY PAVEMENT (INSTALLED IN CURRENT STAGE)
  - TEMPORARY PAVEMENT (INSTALLED IN PREVIOUS STAGE)
  - ARROW BOARD
  - TEMPORARY IMPACT ATTENUATOR, TL 3
  - TEMP. CONC. BARRIER W/ PRISMATIC REFLECTORS @ 25 FT CTRS.
  - VERTICAL PANELS, SPACING AS SHOWN

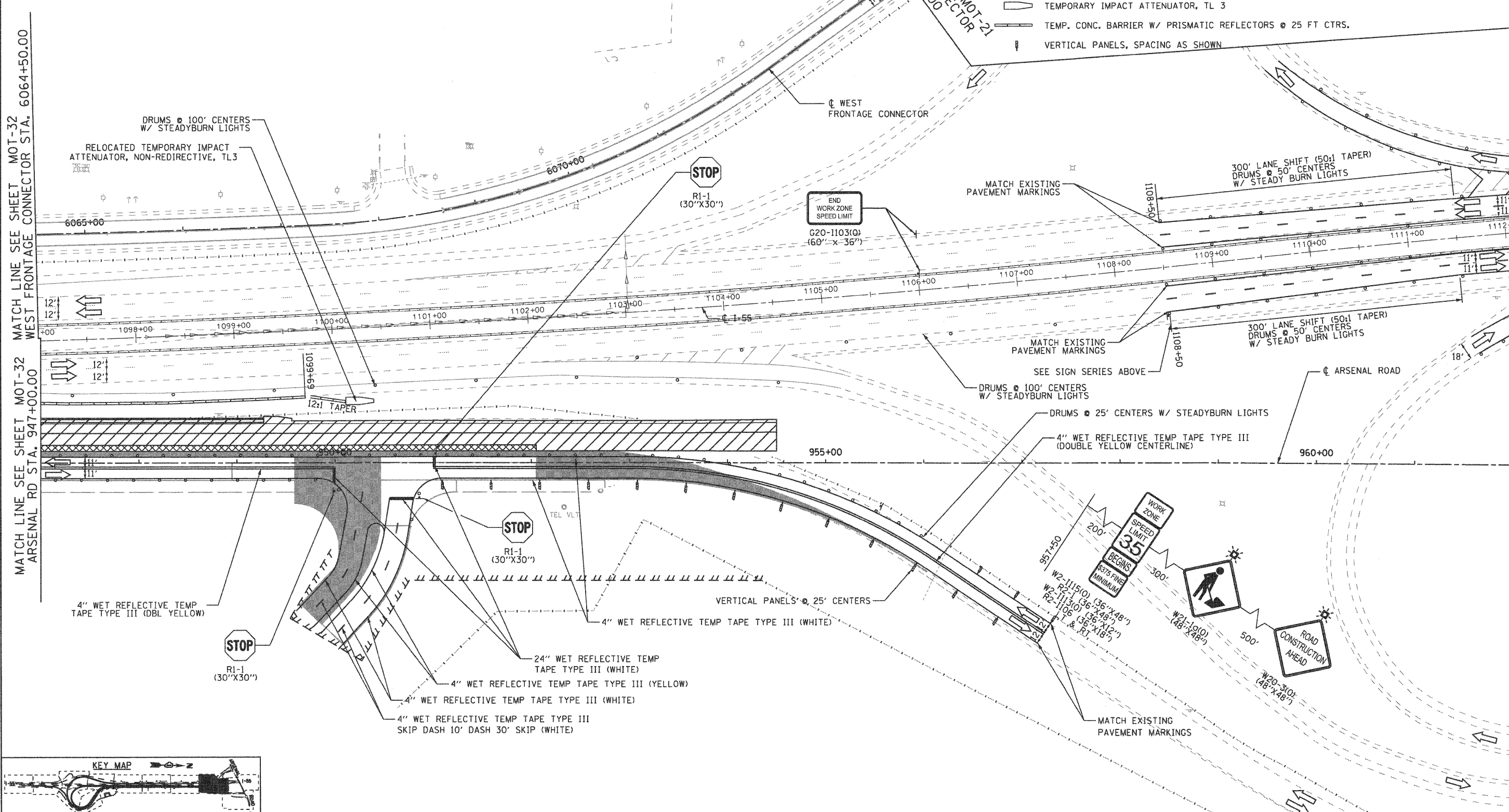

MATCH LINE SEE SHEET MOT-32 WEST FRONTAGE CONNECTOR STA. 6064+50.00

MATCH LINE SEE SHEET MOT-34 ARSENAL RD STA. 962+00.00



**EJM ENGINEERING, INC.**  
411 South Wells Street Suite 800  
Chicago, Illinois 60607

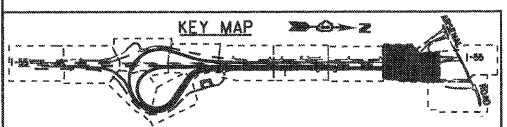

FILE NAME = ...ND168F12-SHT-STAGING211.dgn	USER NAME = gra	DESIGNED - GR	REVISED -
		DRAWN - GR	REVISED -
		CHECKED - RY	REVISED -
		DATE - 02/04/2011	REVISED -

**STATE OF ILLINOIS  
DEPARTMENT OF TRANSPORTATION**

**MAINTENANCE OF TRAFFIC  
STAGE 2**

SCALE: 1"=50'    SHEET NO. 10 OF 12 SHEETS    STA.    TO STA.

F.A.I. RTE. 55	SECTION 99-2HB-2B-1	COUNTY WILL	TOTAL SHEETS 756	SHEET NO. 119
FED. ROAD DIST. NO. 1 ILLINOIS FED. AID PROJECT			CONTRACT NO. 60F12	

**FINAL**