

SINGH
 300 W. ADAMS ST.
 CHICAGO, IL 60606
 TEL: (312) 629-0240
 SINGH & ASSOCIATES, INC.
 CONSULTING ENGINEERS
 FAX: (312) 629-8449

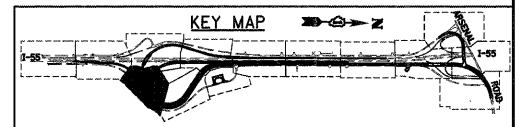
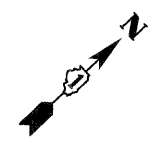
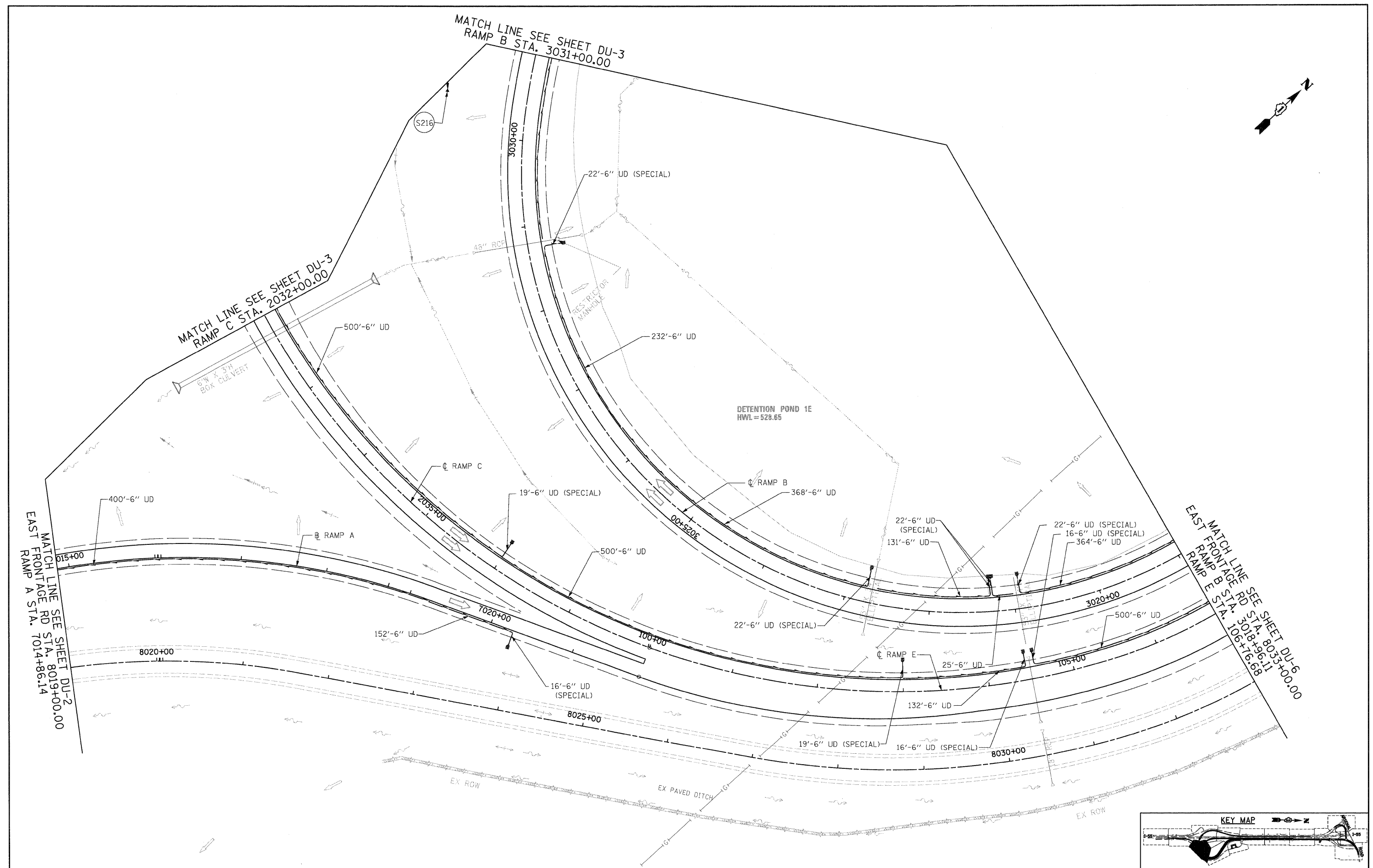

FILE NAME = D162F12-SHT-DRAIN24.dgn	USER NAME = TKLuegel	DESIGNED - PKT	REVISED -	STATE OF ILLINOIS DEPARTMENT OF TRANSPORTATION	DRAINAGE AND UTILITY PLAN		F.A.I. RTE. 55	SECTION 99-2HB-2B-1	COUNTY WILL	TOTAL SHEETS 756	SHEET NO. 170	
PLOT SCALE = 1:50	CHECKED - CL	REVISOR -	REVISOR -		SCALE: 1"=50'	SHEET NO. 4 OF 25 SHEETS	STA. TO STA.	CONTRACT NO. 60F12				
PLOT DATE = 2/3/2011	DATE - 2/4/11	REVISOR -	REVISOR -		FED. ROAD DIST. NO. 1 ILLINOIS FED. AID PROJECT							