

**EJM ENGINEERING, INC.**  
 411 South Wells Street Suite 800  
 Chicago, Illinois 60607

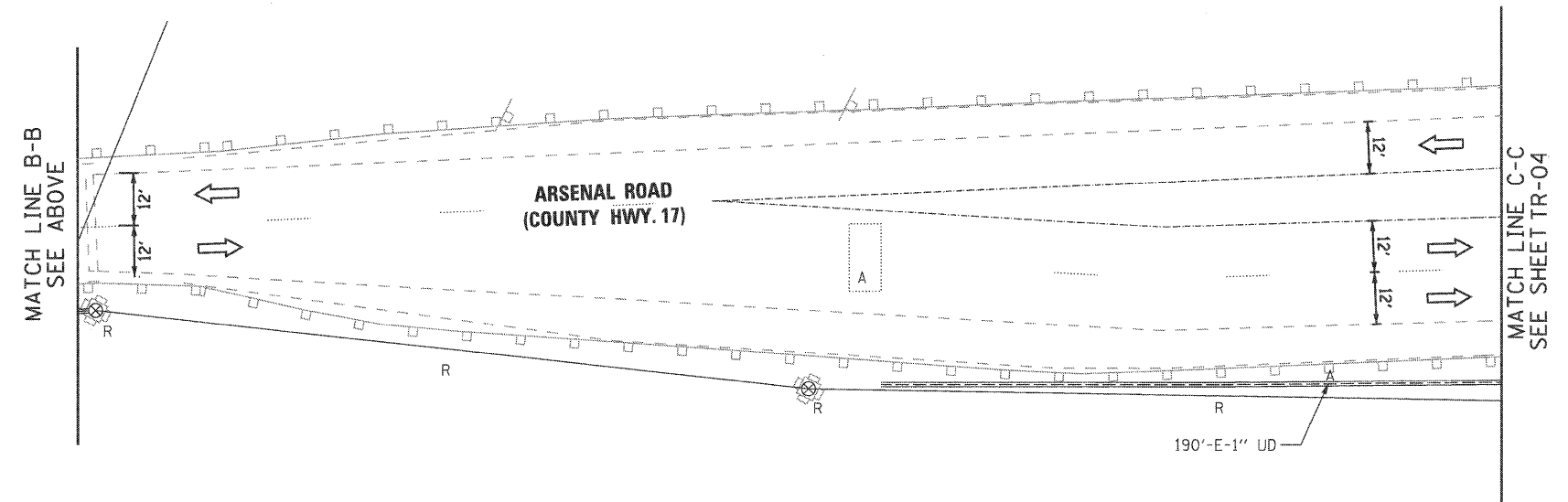

**LEGEND**

- WORK ZONE
- TEMPORARY PAVEMENT (IN PLACE)
- 'X'-E-'Y' 'X' FT. OF EXISTING 'Y' IN. CONDUIT

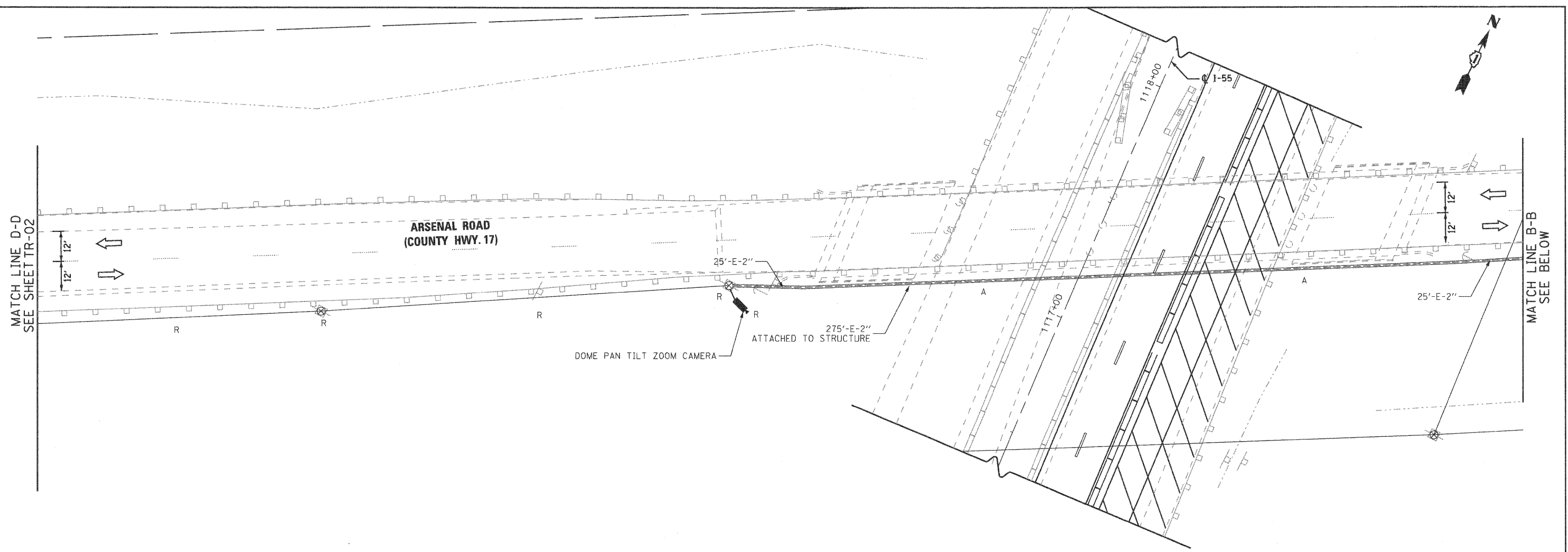
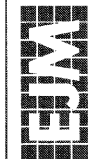

**REMOVE EXISTING INTERCONNECT EQUIPMENT  
 STAGE 3**

**REMOVE EXISTING TRAFFIC SIGNAL EQUIPMENT PLAN  
 STAGE 3**

**STATE OF ILLINOIS  
 DEPARTMENT OF TRANSPORTATION**

FILE NAME = ...\\D160F12-SHT-TR02-12.dgn	USER NAME = gra1	DESIGNED - GR	REVISED -
		DRAWN - GR	REVISED -
		CHECKED - RY	REVISED -
		DATE - 02/04/2011	REVISED -

SCALE: 1"=20'	SHEET NO. 3 OF 9 SHEETS	F.A.I. RTE. 55	SECTION 99-2HB-2B-1	COUNTY WILL	TOTAL SHEETS 756	SHEET NO. 340
		CONTRACT NO. 60F12		FED. ROAD DIST. NO. 1   ILLINOIS   FED. AID PROJECT		

**FINAL**