

NOTES:

1. SEE DRAWING GE-1 FOR ELECTRICAL SYMBOL LIST AND ABBREVIATIONS. SEE DRAWING GE-2 FOR ELECTRICAL GENERAL NOTES AND SUGGESTED LIGHTING PHASING NOTES.
2. THE CONTRACTOR SHALL REMOVE HIGH MAST LIGHT TOWER. THIS WORK SHALL BE INCLUDED IN THE "REMOVAL OF EXISTING HIGH MAST LIGHT TOWER, SALVAGE" PAY ITEM. SEPARATE PAYMENT WILL NOT BE MADE.
3. THE CONTRACTOR SHALL REMOVE HIGH MAST LIGHT TOWER FOUNDATION. ABANDON UNDERGROUND WIRING AS SHOWN. THIS WORK SHALL BE INCLUDED IN THE "FOUNDATION REMOVAL" PAY ITEM. SEPARATE PAYMENT WILL NOT BE MADE.
4.  INDICATES TEMPORARY PAVEMENT INSTALLATION LIMITS. SEE MAINTENANCE OF TRAFFIC DRAWINGS FOR CONSTRUCTION STAGING INFORMATION.

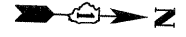

LIMIT OF DEMOLITION WORK
W. FRONTAGE CONN. 6064+50.00

LIMIT OF DEMOLITION WORK
ARSENAL RD 947+00.00

MATCH LINE SEE DRAWING RL1-6
ARSENAL RD STA. 962+00.00

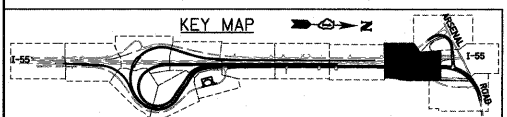
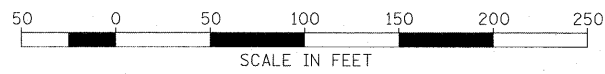
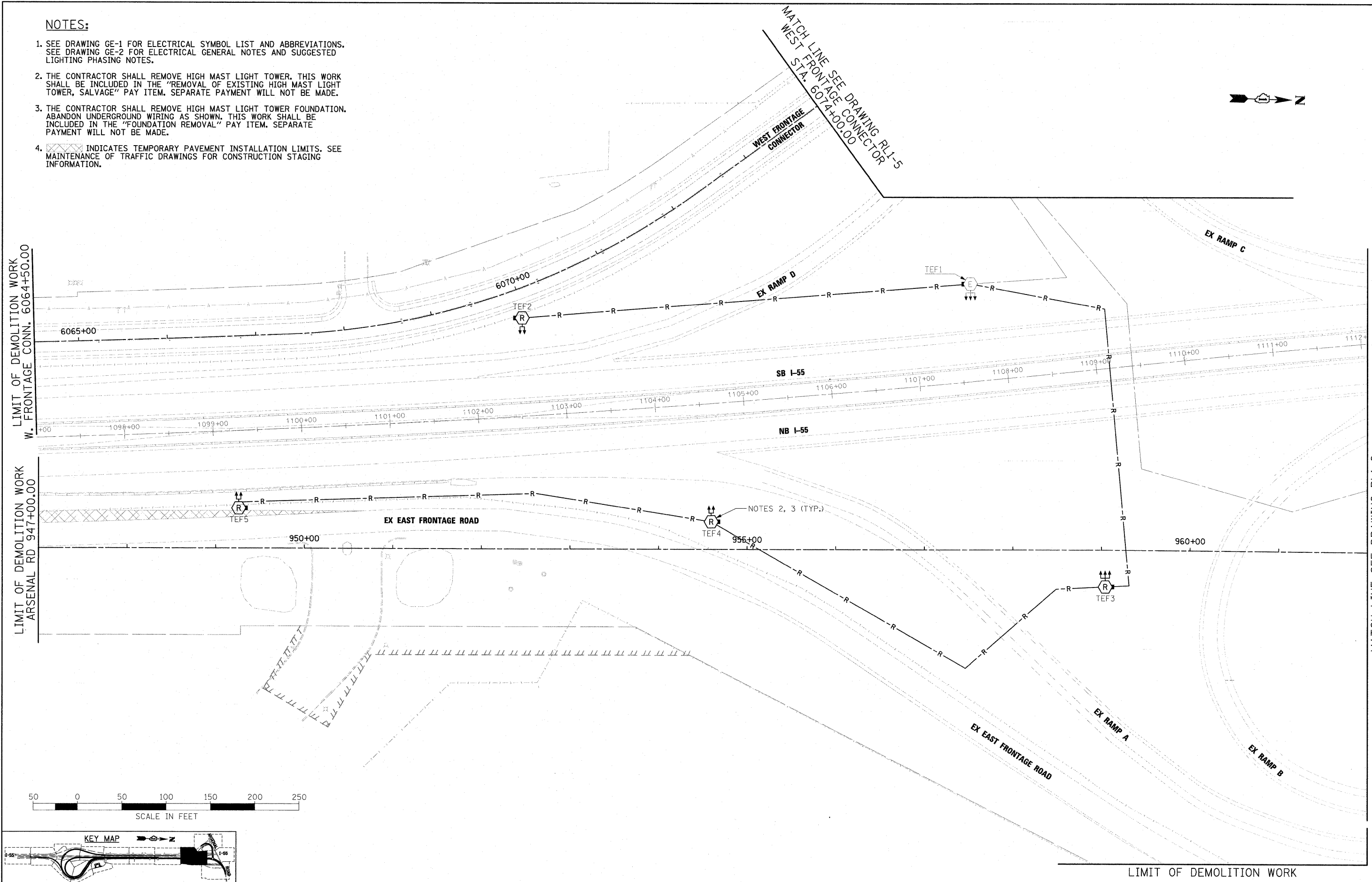

McDonough Associates Inc.
 Engineers / Architects
 130 East Randolph Street, Chicago, Illinois 60601

FILE NAME = D:\62\F12-SHT-RL1-4.dgn	USER NAME = TK.uegel	DESIGNED - JLW	REVISED -	STATE OF ILLINOIS DEPARTMENT OF TRANSPORTATION	I-55 AT ARSENAL ROAD PROPOSED ROADWAY LIGHTING PLAN-STAGE 1 DEMOLITION		F.A.I. RTE. 55	SECTION 99-2HB-2B-1	COUNTY WILL	TOTAL SHEETS 756	SHEET NO. 352	
PLLOT SCALE = 1/8"=1'	CHECKED - KMY	DATE - 2/4/11	REVISED -		SCALE: 1" = 50'	SHEET NO. 4 OF 10 SHEETS	STA. TO STA.	CONTRACT NO. 60F12				
PLLOT DATE = 3/3/2011			REVISED -		FED. ROAD DIST. NO. 1 ILLINOIS FED. AID PROJECT							