

**NOTES:**

1. SEE DRAWING GE-1 FOR ELECTRICAL SYMBOL LIST AND ABBREVIATIONS. SEE DRAWING GE-2 FOR ELECTRICAL GENERAL NOTES AND SUGGESTED LIGHTING PHASING NOTES.
2. SEE DRAWINGS RL2-5 AND RL3-4 FOR ADDITIONAL WORK ASSOCIATED WITH WALL MOUNTED LIGHT TOWER FOUNDATIONS AND CONDUIT INSTALLATION.
3. SEE DRAWINGS S-1 AND ED-1 FOR HIGH MAST LIGHT TOWER FOUNDATIONS INTEGRAL WITH RETAINING WALL DETAILS.
4. SEE IDOT STANDARD DRAWINGS BE-505a, BE-505b, AND BE-505c FOR HIGH MAST LIGHT TOWER INSTALLATION DETAILS. THIS WORK SHALL BE INCLUDED IN "LIGHT TOWER, 120 FOOT MOUNTING HEIGHT, LUMINAIRE MT. - 12" PAY ITEM. SEPARATE PAYMENT WILL NOT BE MADE.
5. CONDUIT PREVIOUSLY INSTALLED IN STAGE 2 AS SHOWN ON DRAWING RL2-5. NO ADDITIONAL PAYMENT WILL BE MADE.



LIMIT OF ELECTRICAL WORK  
W. FRONTAGE CONN. 6008+00.00  
SB EXIT RAMP 2018+67.70

MATCH LINE SEE DRAWING RL4-2  
W. FRONTAGE CONN. 6021+00.00  
SB EXIT RAMP 2005+51.17

MATCH LINE SEE DRAWING RL4-2  
ARSENAL ROAD 904+00.00  
NB ENTRANCE RAMP 3050+85.37

LIMIT OF ELECTRICAL WORK  
NB ENTRANCE RAMP 3037+00.00

6. BUCK-BOOST TRANSFORMERS TO BE INSTALLED AT THE DISCRETION OF THE ENGINEER. AFTER HIGH MAST LIGHT TOWERS 3 AEF5, 2 AEF6, AND 2 AEF7, SHOWN ON DRAWING RL4-2, ARE INSTALLED, THE CONTRACTOR SHALL TEST THE CIRCUITS BEFORE THE BUCK-BOOST TRANSFORMERS ARE INSTALLED. IN CASE COMED IS PROVIDING VOLTAGE SIGNIFICANTLY HIGHER THAN EXPECTED AND THE BUCK-BOOST TRANSFORMER INSTALLATION CAN BE OMITTED. SHOULD THE ENGINEER DETERMINE THAT BUCK-BOOST TRANSFORMERS ARE REQUIRED, SEE DRAWING ED-5 FOR BUCK-BOOST TRANSFORMER INSTALLATION DETAILS. TESTING OF THE CIRCUITS TO DETERMINE IF BUCK-BOOST TRANSFORMERS ARE NECESSARY SHALL BE CONSIDERED INCIDENTAL TO THE COST OF THE APPLICABLE CABLE PAY ITEM. SEPARATE PAYMENT WILL NOT BE MADE. IF BUCK-BOOST TRANSFORMERS ARE REQUIRED, THE BUCK-BOOST TRANSFORMER, OVERCURRENT PROTECTION DEVICES, ENCLOSURE, MOUNTING HARDWARE, WIRING AND ALL INCIDENTALS NECESSARY FOR A COMPLETE AND FUNCTIONAL INSTALLATION SHALL BE INCLUDED IN THE "BUCK-BOOST TRANSFORMER, 1.5KVA, 240V PRIMARY, 24V SECONDARY" PAY ITEM. SEPARATE PAYMENT WILL NOT BE MADE.

LIMIT OF ELECTRICAL WORK  
NB I-55 ENTRANCE 3005+00.00  
SB I-55 EXIT 121+62.75

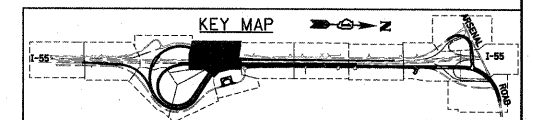
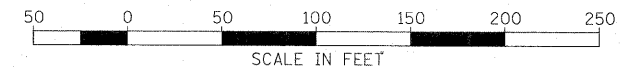
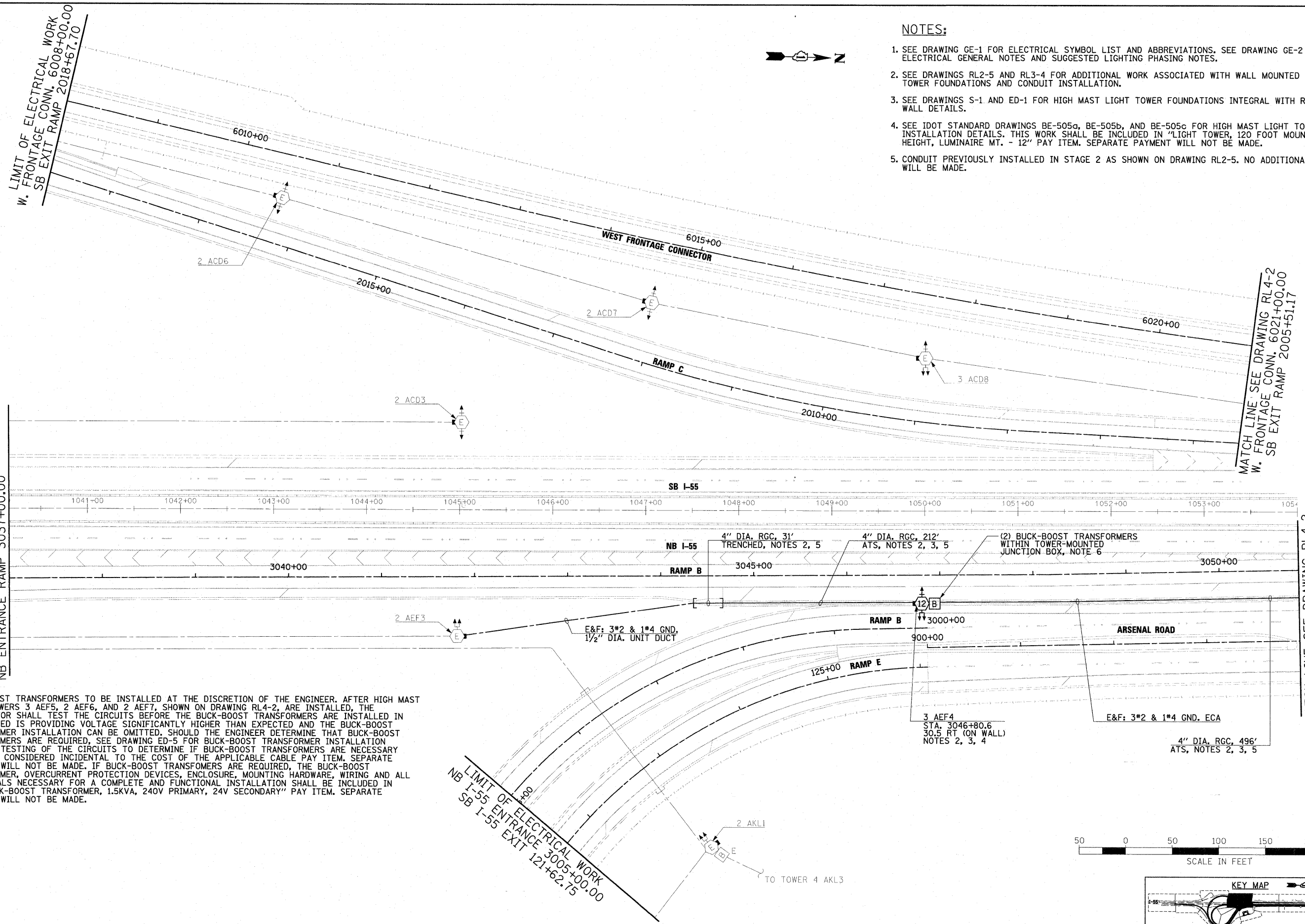

FILE NAME =	USER NAME = TKluegel
D:\62\F12-SHT-RL4-1.dgn	
PLOT SCALE = 1:50	
PLOT DATE = 3/3/2011	

DESIGNED - JLW	REVISD -
DRAWN - CJM	REVISD -
CHECKED - KMY	REVISD -
DATE - 2/4/11	REVISD -

STATE OF ILLINOIS  
DEPARTMENT OF TRANSPORTATION

I-55 AT ARSENAL ROAD  
PROPOSED ROADWAY LIGHTING PLAN-STAGE 4

SCALE: 1" = 50' SHEET NO. 1 OF 8 SHEETS STA. TO STA.

F.A.I. RTE.	SECTION	COUNTY	TOTAL SHEETS	SHEET NO.
55	99-2HB-2B-1	WILL	756	382
CONTRACT NO. 60F12				
FED. ROAD DIST. NO. 1 ILLINOIS FED. AID PROJECT				