

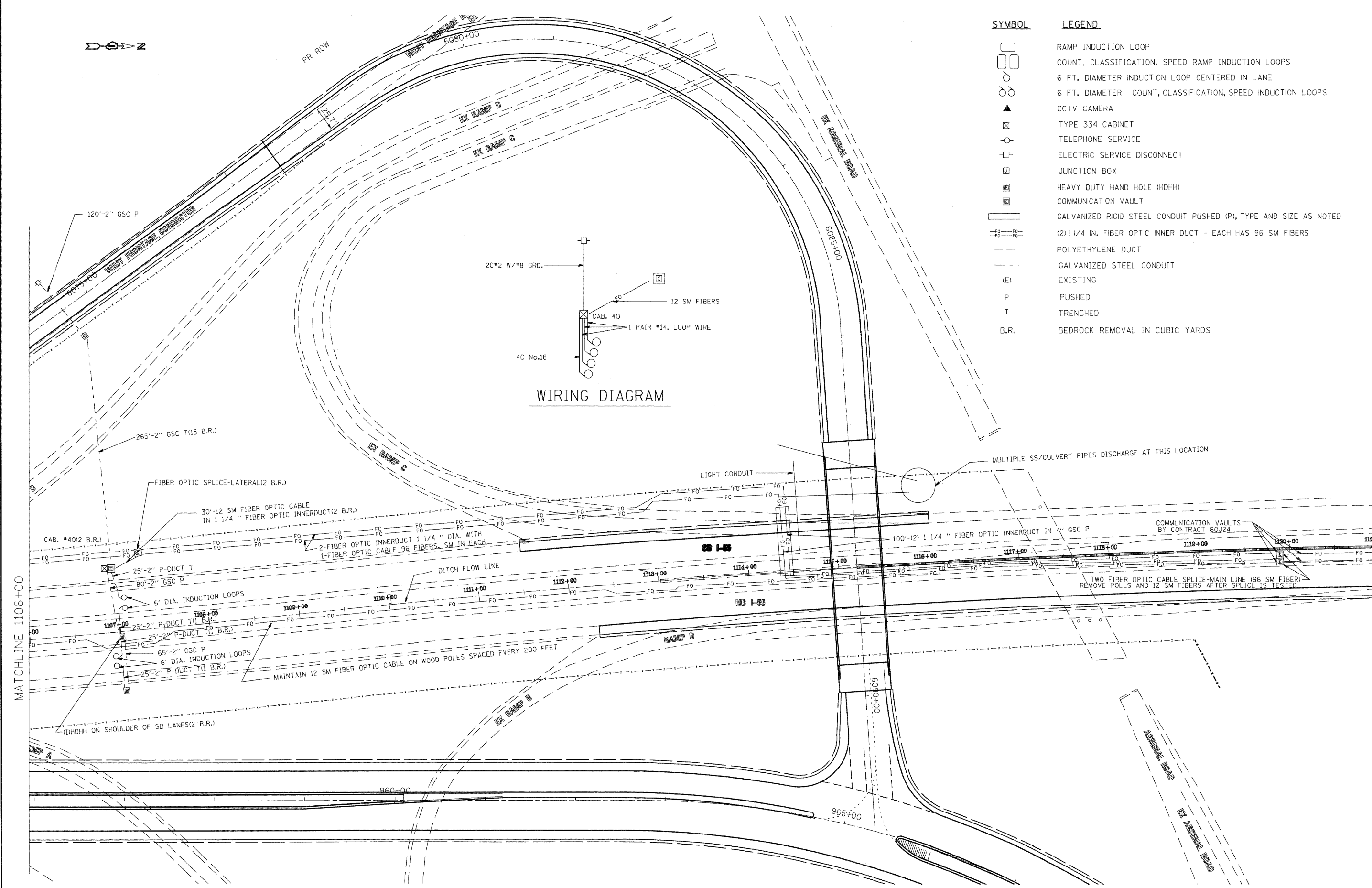

SYMBOL

LEGEND

- RAMP INDUCTION LOOP
- COUNT, CLASSIFICATION, SPEED RAMP INDUCTION LOOPS
- 6 FT. DIAMETER INDUCTION LOOP CENTERED IN LANE
- 6 FT. DIAMETER COUNT, CLASSIFICATION, SPEED INDUCTION LOOPS
- CCTV CAMERA
- TYPE 334 CABINET
- TELEPHONE SERVICE
- ELECTRIC SERVICE DISCONNECT
- JUNCTION BOX
- HEAVY DUTY HAND HOLE (HDHH)
- COMMUNICATION VAULT
- GALVANIZED RIGID STEEL CONDUIT PUSHED (P), TYPE AND SIZE AS NOTED
- (2) 1/4 IN. FIBER OPTIC INNER DUCT - EACH HAS 96 SM FIBERS
- POLYETHYLENE DUCT
- GALVANIZED STEEL CONDUIT
- (E) EXISTING
- P PUSHED
- T TRENCHED
- B.R. BEDROCK REMOVAL IN CUBIC YARDS



WIRING DIAGRAM

FILE NAME = C:\155 AT ARSENAL RD\SHEETS.DGN
 USER NAME = mezag
 PLOT SCALE = 100.0000' / IN.
 PLOT DATE = 7/2/2010

DESIGNED - J.G.
 DRAWN - G.M.
 CHECKED - J.C.
 DATE - 03/16/2010

REVISED - _____
 REVISED - _____
 REVISED - _____
 REVISED - _____

STATE OF ILLINOIS
DEPARTMENT OF TRANSPORTATION
 TRAFFIC SYSTEMS CENTER

TRAFFIC SURVEILLANCE
SOUTH OF DES PLAINES RIVER

SCALE: _____ SHEET NO. ____ OF ____ SHEETS STA. _____ TO STA. _____

F.A. RTE.	SECTION	COUNTY	TOTAL SHEETS	SHEET NO.
55	99-2HB-2B-1	WILL	756	464
CONTRACT NO. 60F12				
1 ILLINOIS FED. AID PROJECT				