

STATE OF ILLINOIS
DEPARTMENT OF TRANSPORTATION

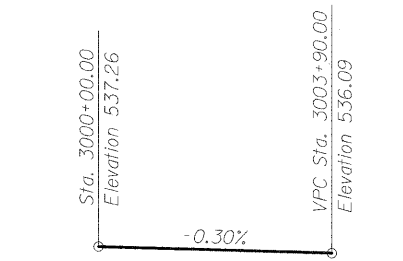

PROFILE GRADE - RAMP B
(Ramp East of Wall)

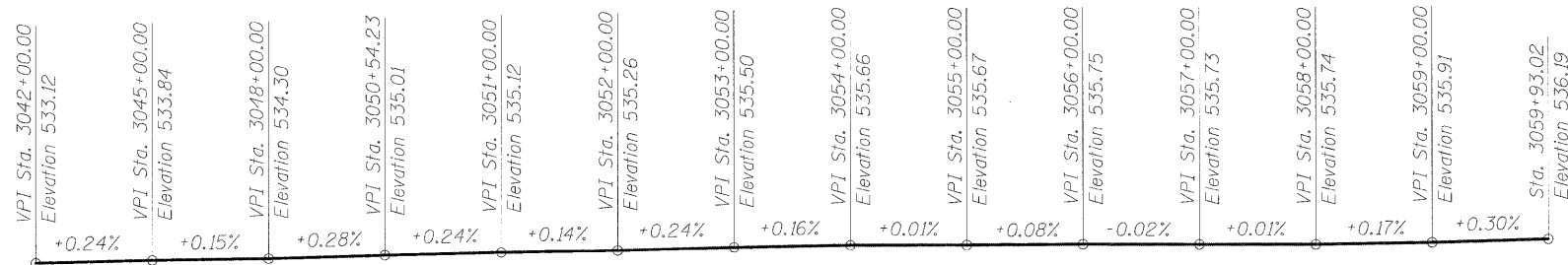

PROFILE GRADE - RAMP B
(Ramp West of Wall)

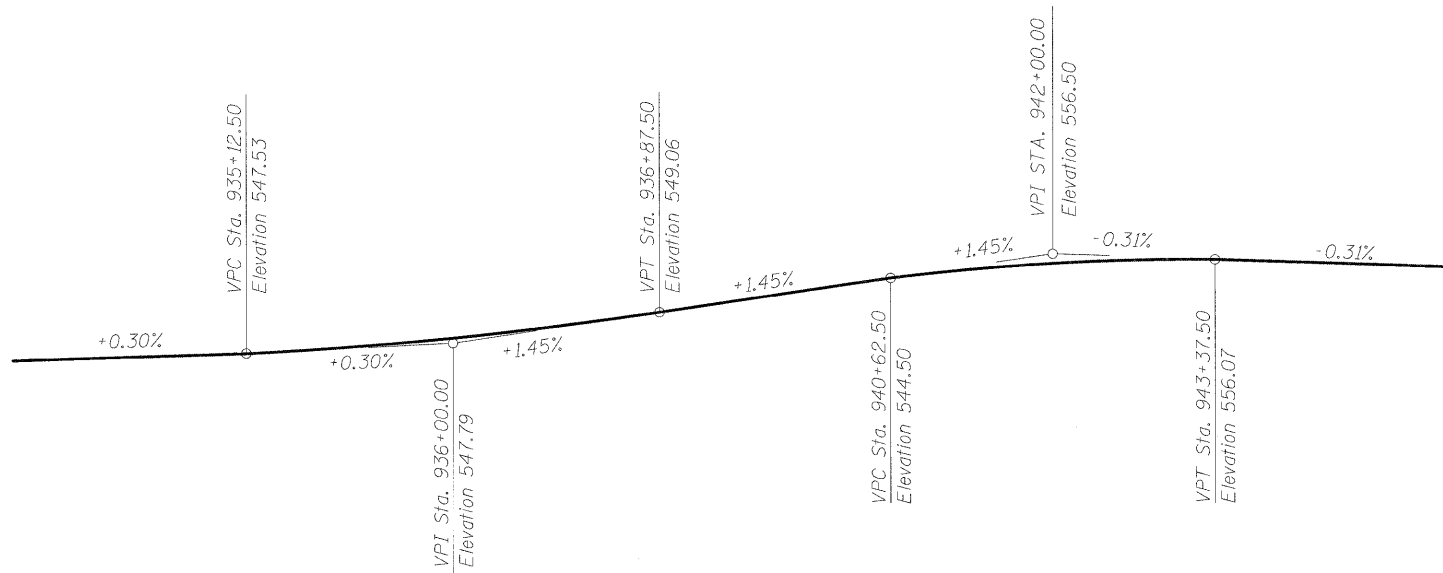

PROFILE GRADE - ARSENAL ROAD

INDEX OF SHEETS

1. General Plan & Elevation - 1
2. General Plan & Elevation - 2
3. General Plan & Elevation - 3
4. General Plan & Elevation - 4
5. General Plan & Elevation - 5
6. General Details & Bill of Material
7. Plan and Elevation - 1
8. Plan and Elevation - 2
9. Plan and Elevation - 3
10. Plan and Elevation - 4
11. Plan and Elevation - 5
12. Plan and Elevation - 6
13. Plan and Elevation - 7
14. Section and Details
15. Section and Details
16. Section and Details
17. Section and Details
18. Section and Details
19. Bill of Material
20. Soil Borings
21. Soil Borings
22. Soil Borings
23. Soil Borings
24. Soil Borings
25. Soil Borings
26. Soil Borings
27. Soil Borings
28. Soil Borings
29. Soil Borings
30. Soil Borings
31. Soil Borings

TOTAL BILL OF MATERIAL

ITEM	UNIT	TOTAL
Porous Granular Embankment	Cu Yd	3,889
Structure Excavation	Cu Yd	11,600
Rock Excavation for Structures	Cu Yd	2,440
Removal and Disposal of Unsuitable Material for Structures	Cu Yd	2,000
Concrete Structures	Cu Yd	5,399.6
Reinforcement Bars, Epoxy Coated	Pound	593,590
Geocomposite Wall Drain	Sq Yd	4,623
Pipe Drains 4"	Foot	33
Pipe Underdrains for Structures 4"	Foot	4,043

GENERAL NOTES

1. Reinforcement bars shall conform to the requirements of ASTM A 706 Gr 60. See Special Provisions.
2. Reinforcement bars designated (E) shall be epoxy coated.
3. Construction joints shall be bonded.
4. The back face of Retaining Wall shall be waterproofed according to Article 503.18 of the Standard Specifications.

DESIGN STRESSES

FIELD UNITS

$f'_c = 3,500$ psi
 $f_y = 60,000$ psi (Reinforcement)

DESIGN SPECIFICATIONS

2002 AASHTO Standard Specifications
for Highway Bridges

GENERAL DETAILS & BILL OF MATERIAL
STRUCTURE NO. 099-W027

DESIGNED	PMH
CHECKED	MJL
DRAWN	PMH
CHECKED	BB



McDonough Associates Inc.
Engineers / Architects
130 East Randolph Street
Chicago, Illinois 60601
(312) 946-8600

SHEET NO. RW2-6 SHEETS RW2-31	F.A.I. RTE.	SECTION	COUNTY	TOTAL SHEETS	SHEET NO.
	55	(99-1&2) R-6	WILL	756	470
FED. ROAD DIST. NO.			ILLINOIS	FED. AID PROJECT	
CONTRACT NO. 60F12					