

STATE OF ILLINOIS
DEPARTMENT OF TRANSPORTATION

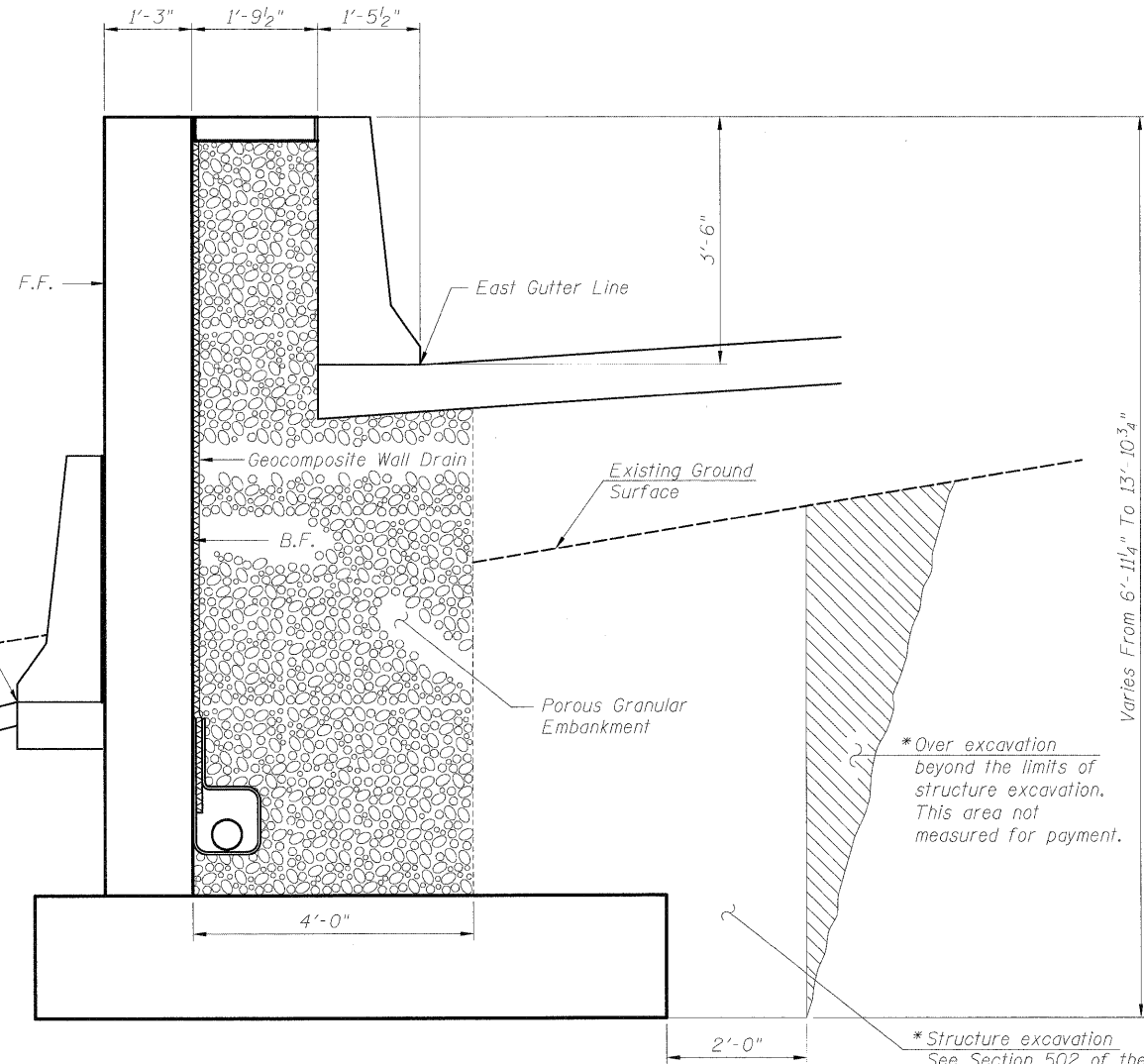

TYPICAL SECTION THRU RETAINING WALL

(Arsenal Rd. Sta. 934+47.18 to Sta. 934+92.67)

* Backfill remainder of structure excavation and over excavation with same material specified for roadway embankment.

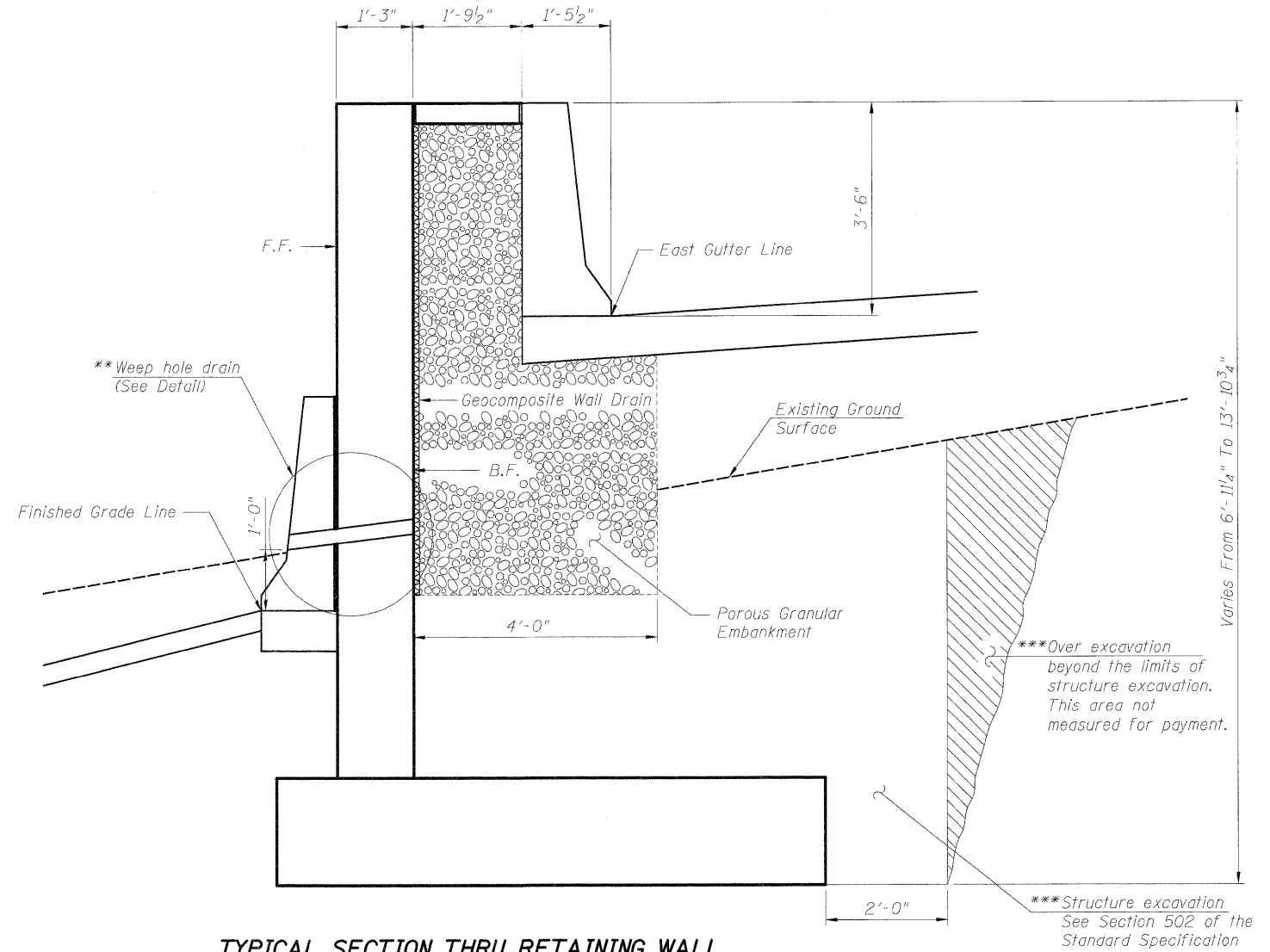

TYPICAL SECTION THRU RETAINING WALL

(Arsenal Rd. Sta. 934+97.33 to Sta. 949+27.33)

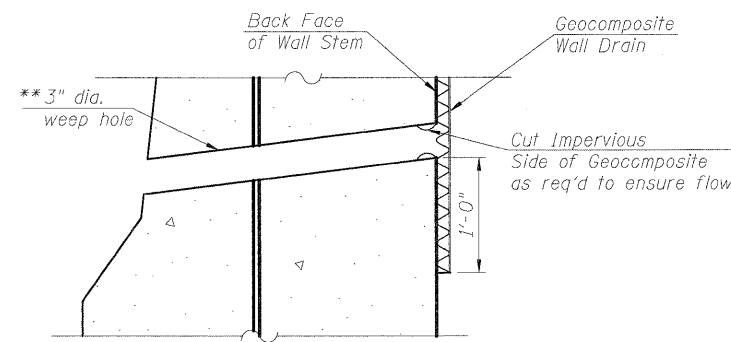

WEEP HOLE DRAIN DETAIL

** Weep hole spacing shall be at ±8'-0" horizontally. Weep holes included in cost of "Concrete Structures."

*** Backfill remainder of structure excavation and over excavation with same material specified for roadway embankment.

LEGEND:

F.F. = Front Face of Wall
B.F. = Back Face of Wall
E.F. = Each Face of Wall

**SECTION AND DETAILS
STRUCTURE NO. 099-W027**

DESIGNED	PMH
CHECKED	MJL
DRAWN	PMH
CHECKED	BB



McDonough Associates Inc.
Engineers / Architects
130 East Randolph Street
Chicago, Illinois 60601
(312) 946-8600

SHEET NO. RW2-15 SHEETS RW2-31	F.A.I. RTE.	SECTION	COUNTY	TOTAL SHEETS	SHEET NO.
	55	(99-1&2) R-6	WILL	756	479
FED. ROAD DIST. NO.			ILLINOIS FED. AID PROJECT		
CONTRACT NO. 60F12					