

STATE OF ILLINOIS
DEPARTMENT OF TRANSPORTATION

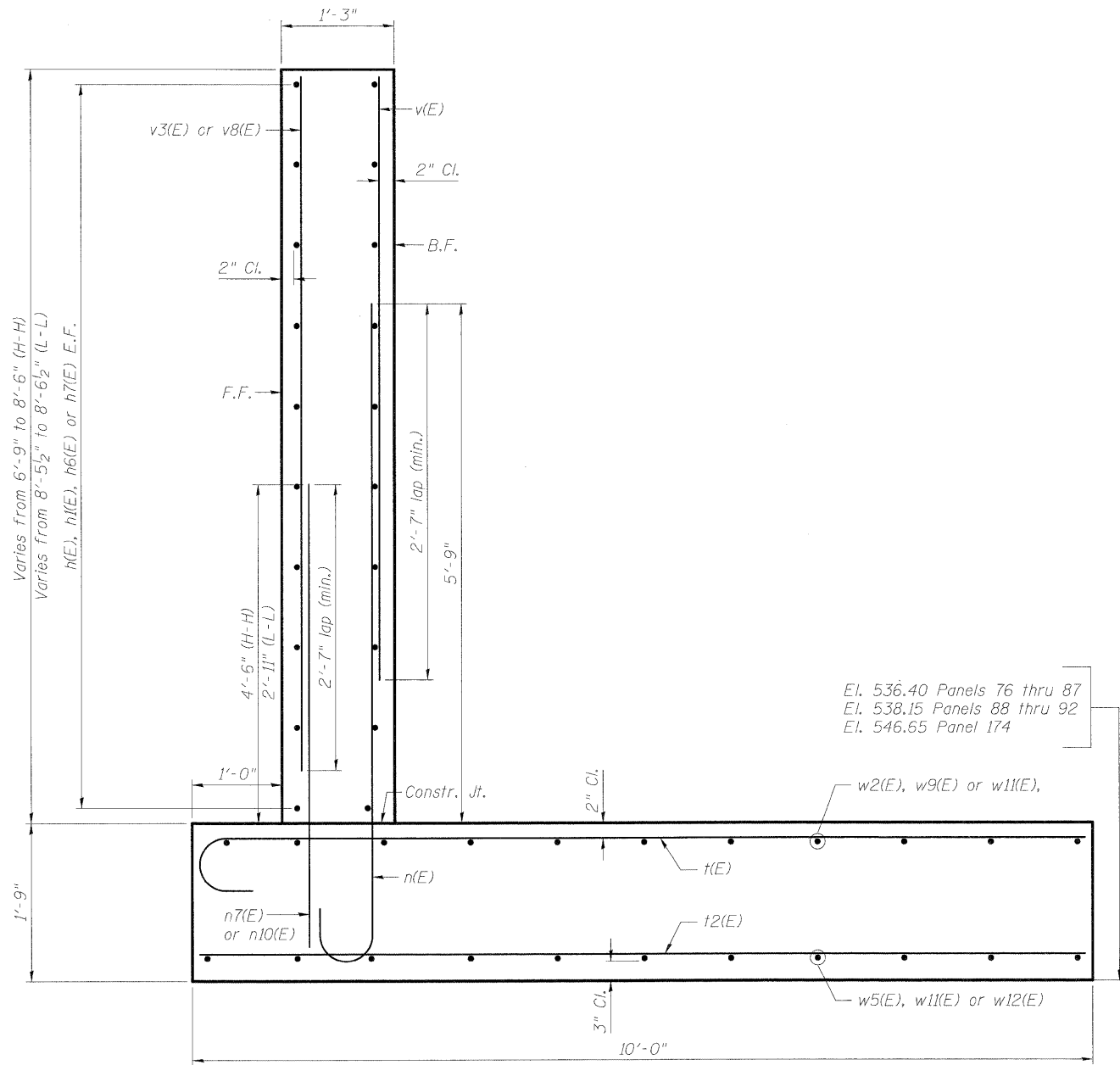

SECTION H-H & SECTION L-L
PANELS 76 THRU 92 (H-H)
PANEL 174 (L-L)

Max. Soil Pressure = 2.47 ksf

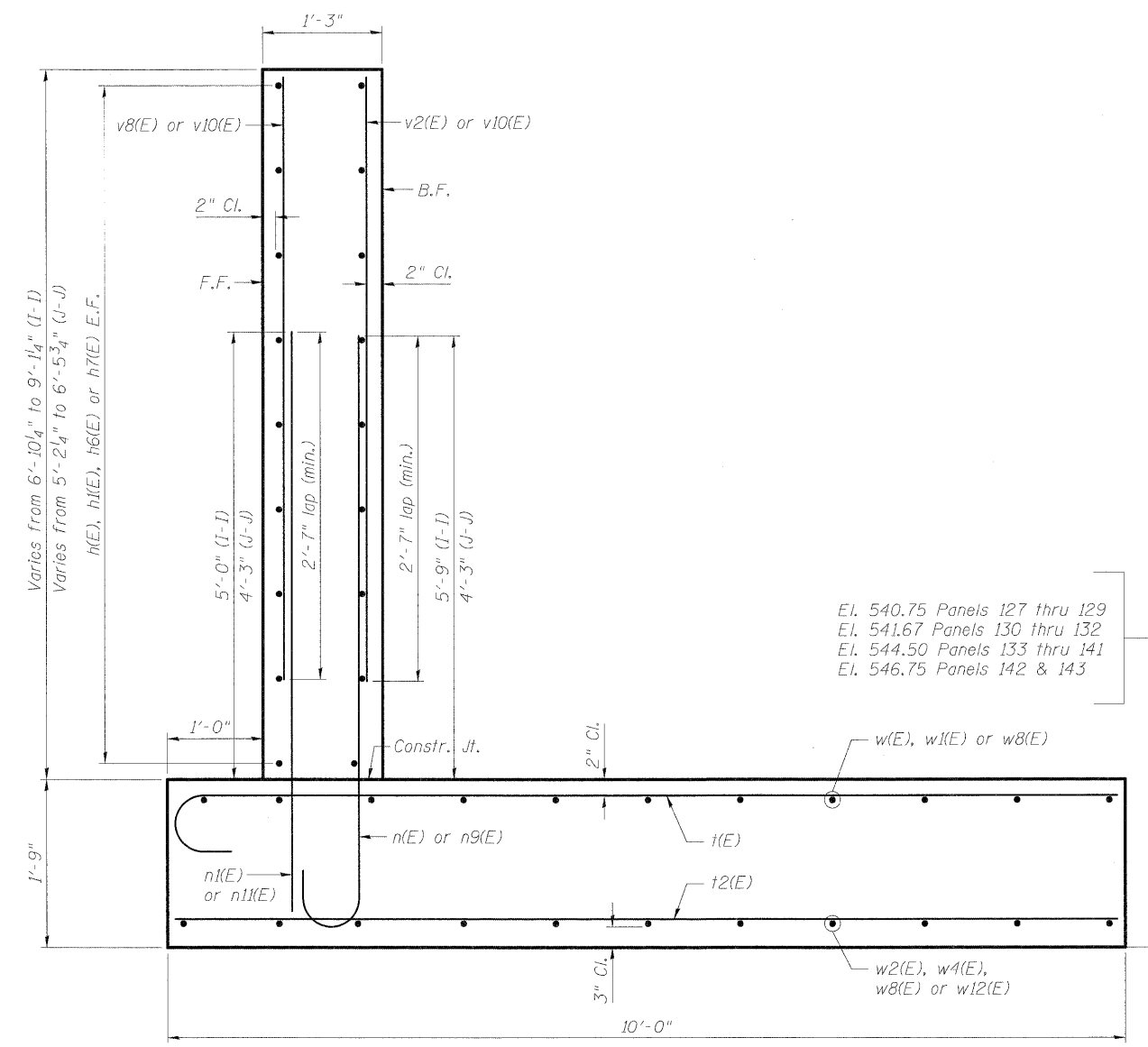

SECTION I-I & SECTION J-J
PANELS 127 THRU 132 & 139 THRU 143 (I-I)
PANELS 133 THRU 135 (J-J)

Max. Soil Pressure = 2.47 ksf

- NOTES:**
1. For Bill of Material see Sheet RW2-19.
 2. Reinforcement Bars designated (E) shall be Epoxy Coated.

- LEGEND:**
- F.F. = Front Face of Wall
 - B.F. = Back Face of Wall
 - E.F. = Each Face of Wall

DESIGNED	PMH
CHECKED	MJL
DRAWN	PMH
CHECKED	MJL

McDonough Associates Inc.
Engineers / Architects
130 East Randolph Street
Chicago, Illinois 60601
(312) 946-8600

SHEET NO. RW2-18 SHEETS RW2-31	F.A.I. RTE.	SECTION	COUNTY	TOTAL SHEETS	SHEET NO.
	55	(99-1&2) R-6	WILL	756	482
FED. ROAD DIST. NO.			ILLINOIS	FED. AID PROJECT	
CONTRACT NO. 60F12					

SECTION AND DETAILS
STRUCTURE NO. 099-W027