

STATE OF ILLINOIS
DEPARTMENT OF TRANSPORTATION

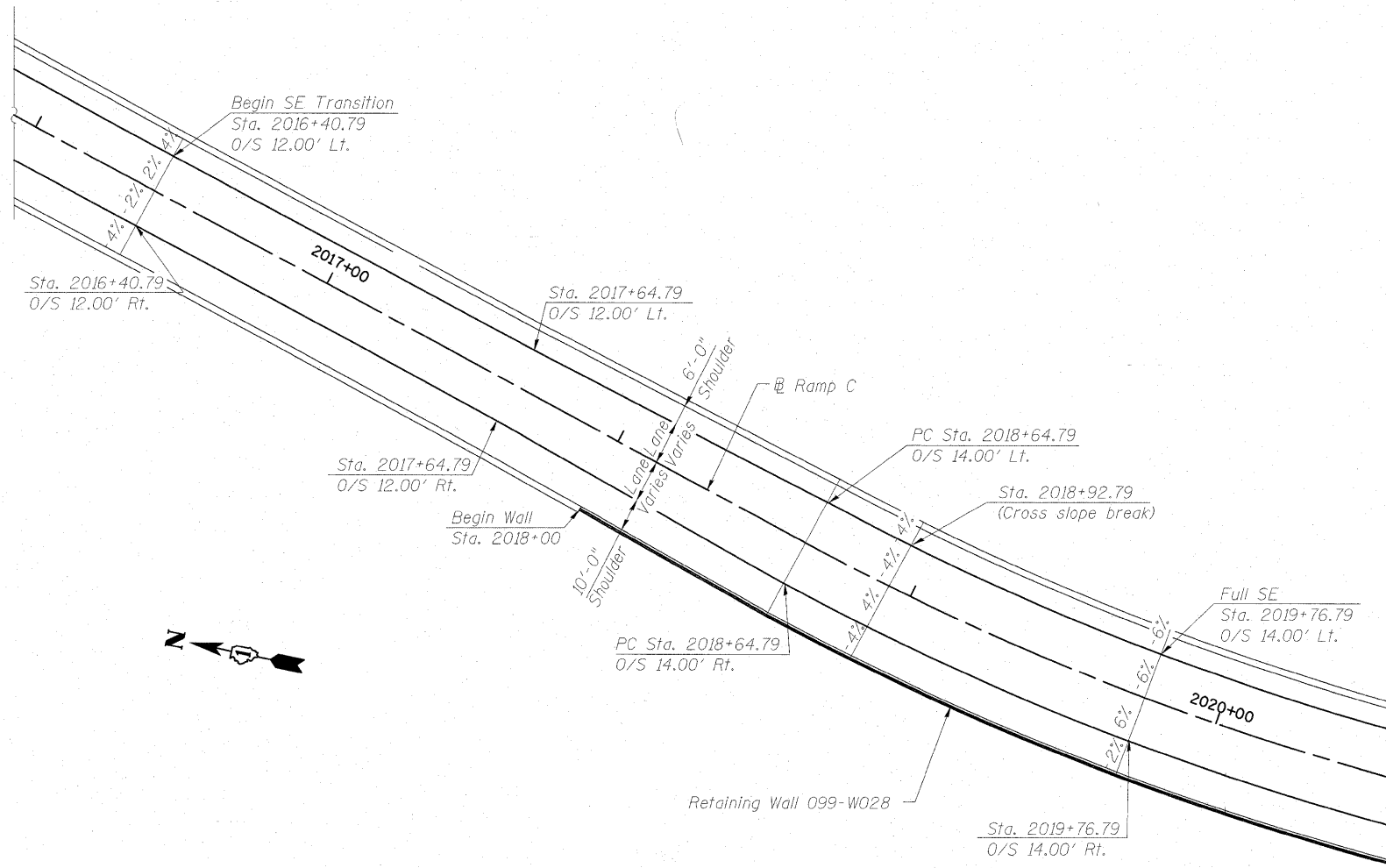

TRANSITION PLAN

INDEX OF SHEETS

1. General Plan & Elevation
2. General Details & Bill of Material
3. MSE Wall- Plan & Elevation
4. MSE Wall- Plan & Elevation
5. MSE Wall- Plan & Elevation
6. Sections and Details
7. Sections and Details

GENERAL NOTES

1. Reinforcement bars shall conform to the requirements of ASTM A 706 Gr 60. See Special Provisions.
2. Reinforcement bars designated (E) shall be epoxy coated.
3. Place the top most layer of soil reinforcement 3 feet below the gutter line elevation.
4. Verify all drainage information regarding catch basins, manholes & pipes from drainage plans prior to fabrication or construction.

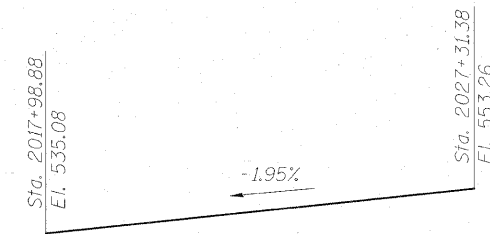

PROFILE GRADE - RAMP C

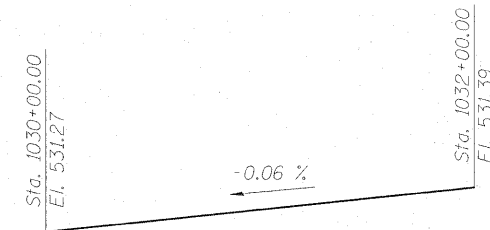

PROFILE GRADE - NB & SB I-55

TOTAL BILL OF MATERIAL

ITEM	UNIT	TOTAL
Concrete Structures	Cu. Yd.	473.9
Reinforcement Bars, Epoxy Coated	Pound	64,430

DESIGNED	PMH
CHECKED	MJL
DRAWN	RJ
CHECKED	BKB

**GENERAL DETAILS & BILL OF MATERIAL
STRUCTURE NO. 099-W028**

McDonough Associates Inc.
Engineers / Architects
130 East Randolph Street
Chicago, Illinois 60601
(312) 946-8600

SHEET NO. RW3-2 SHEETS RW3-7	F.A.I. RTE.	SECTION	COUNTY	TOTAL SHEETS	SHEET NO.
	55	(99-1&2) R-6	WILL	756	497
FED. ROAD DIST. NO.			ILLINOIS FED. AID PROJECT		
CONTRACT NO. 60F12					