

DATE	
BY	
FINAL SURVEY	
NOTE BOOK	
NO.	

DATE	
BY	
ORIGINAL SURVEY	
NOTE BOOK	
NO.	

McDonough Associates Inc.  
 Engineers / Architects  
 538 East Randolph Street Chicago, Illinois 60601

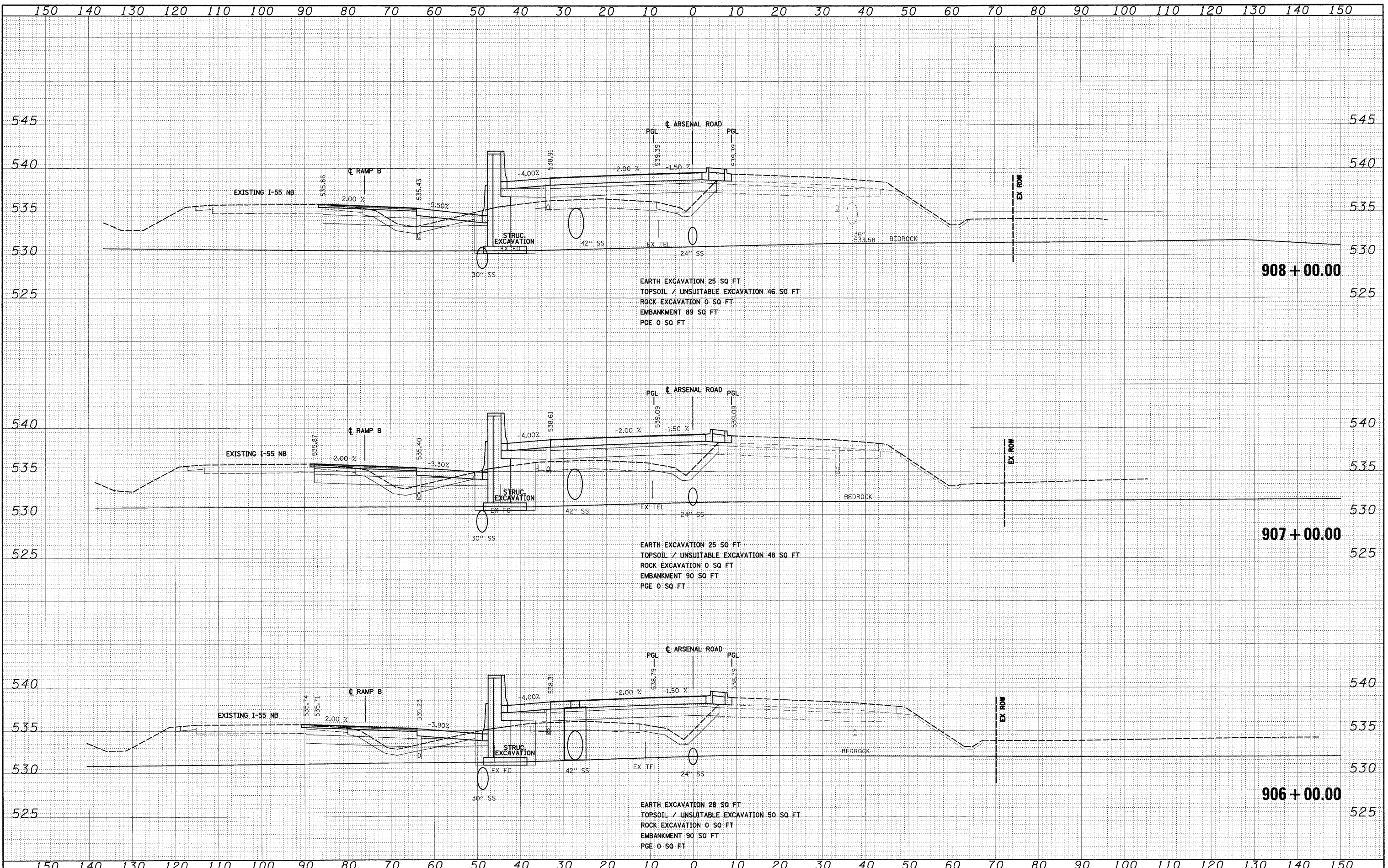

EARTH EXCAVATION 25 SQ FT  
 TOPSOIL / UNSUITABLE EXCAVATION 46 SQ FT  
 ROCK EXCAVATION 0 SQ FT  
 EMBANKMENT 89 SQ FT  
 PGE 0 SQ FT

EARTH EXCAVATION 25 SQ FT  
 TOPSOIL / UNSUITABLE EXCAVATION 48 SQ FT  
 ROCK EXCAVATION 0 SQ FT  
 EMBANKMENT 90 SQ FT  
 PGE 0 SQ FT

EARTH EXCAVATION 28 SQ FT  
 TOPSOIL / UNSUITABLE EXCAVATION 50 SQ FT  
 ROCK EXCAVATION 0 SQ FT  
 EMBANKMENT 90 SQ FT  
 PGE 0 SQ FT

FILE NAME = D162F12-SHT-XSSHT01.dgn	USER NAME = TKLuegel	DESIGNED - TRK	REVISED -	<b>STATE OF ILLINOIS DEPARTMENT OF TRANSPORTATION</b>	<b>ARSENAL ROAD CROSS SECTIONS</b>	F.A.I. RTE. 55	SECTION 99-2HB-2B-1	COUNTY WILL	TOTAL SHEETS 756	SHEET NO. 604		
PLOT SCALE = 1"=10'	CHECKED - DLT	REVISED -	SCALE: 1"=10'H; 1"=5'V			SHEET NO. 3 OF 62 SHEETS	STA. 906+00.00 TO STA. 908+00.00	CONTRACT NO. 60F12		ILLINOIS FED. AID PROJECT		
PLOT DATE = 2/3/2011	DATE = 2/4/11	REVISED -										