

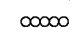

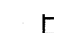



LEGEND

-  WORK AREA
-  IMPACT ATTENUATORS, TEMPORARY (FULLY REDIRECTIVE, NARROW), TEST LEVEL 3
-  TYPE III BARRICADE
-  TEMPORARY CONCRETE BARRIER
-  DRUM WITH STEADY BURN MONODIRECTIONAL LIGHT AT 25' CENTERS.
-  DIRECTION INDICATOR BARRICADE WITH STEADY BURN MONODIRECTIONAL LIGHT AT 20' CENTERS.
-  SIGN
-  ARROW BOARD

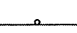
ENTRANCE DRUMS SHOWN FOR INFORMATION ONLY; FINAL LOCATION TO BE ADJUSTED AS NECESSARY IN THE FIELD (TYP.)

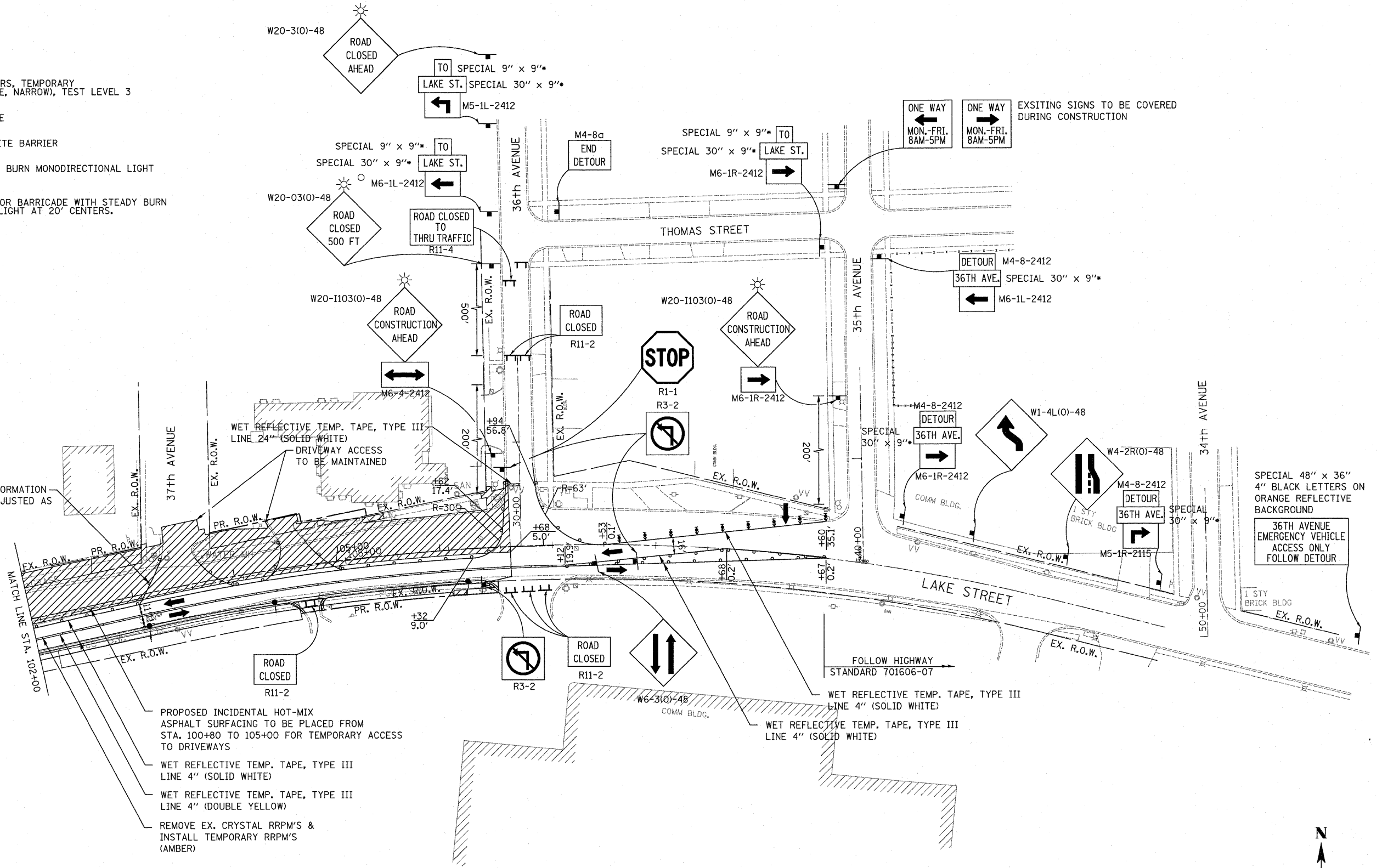

- PROPOSED INCIDENTAL HOT-MIX ASPHALT SURFACING TO BE PLACED FROM STA. 100+80 TO 105+00 FOR TEMPORARY ACCESS TO DRIVEWAYS
- WET REFLECTIVE TEMP. TAPE, TYPE III LINE 4" (SOLID WHITE)
- WET REFLECTIVE TEMP. TAPE, TYPE III LINE 4" (DOUBLE YELLOW)
- REMOVE EX. CRYSTAL RRPMS & INSTALL TEMPORARY RRPMS (AMBER)

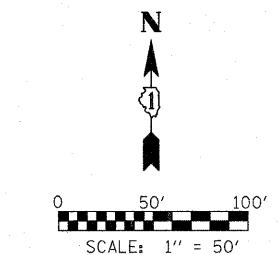

* UNLESS OTHERWISE NOTED, ALL SPECIAL SIGNS WILL BE 4" BLACK LETTERS ON AN ORANGE REFLECTIVE BACKGROUND

FILE NAME =	DESIGNED - ST	REVISED -
*FILE#	DRAWN - ST	REVISED -
USER NAME = #USER#	CHECKED - FML	REVISED -
PLOT DATE = #DATE#	DATE - 01/2010	REVISED -



**STATE OF ILLINOIS
DEPARTMENT OF TRANSPORTATION**

**MAINTENANCE OF TRAFFIC - STAGE II
LAKE STREET OVER ADDISON CREEK**

SCALE: 1" = 50' SHEET NO. 2 OF 2 SHEETS STA. 102+00 TO STA. 109+67

F.A.U. RTE.	SECTION	COUNTY	TOTAL SHEETS	SHEET NO.
3537	3264-T	COOK	110	22
FED. ROAD DIST. NO.			ILLINOIS FED. AID PROJECT	
			CONTRACT NO. 60H44	