

GENERAL NOTES:

1. SEE IDOT STANDARD 701321, LANE CLOSURE, 2L, 2W, BRIDGE REPAIR WITH BARRIER FOR ADDITIONAL INFORMATION.
2. SEE MOT TYPICAL SECTIONS FOR ADDITIONAL INFORMATION.
3. AGGREGATE SHOULDER SHALL BE PLACED ADJACENT TO THE TEMPORARY PAVEMENT AND BE PAID FOR AS ITEM 48101900, AGGREGATE WEDGE SHOULDER TYPE B.
4. DRIVEWAY ACCESS SHALL BE MAINTAINED AT ALL TIMES. ADJUSTMENTS NECESSARY TO TRAFFIC CONTROL ITEMS TO MAINTAIN ACCESS SHALL NOT BE PAID FOR BUT SHALL BE CONSIDERED INCLUDED IN THE COST OF TEMPORARY BARRIER WALL.

5. TYPE C BARRIER WALL MARKERS SHALL NOT BE MEASURED FOR PAYMENT BUT SHALL BE CONSIDERED INCLUDED IN THE COST OF TEMPORARY BARRIER WALL.
6. SEE MAINTENANCE OF TRAFFIC SHEET TEMPORARY BRIDGE TRAFFIC SIGNALS FOR TRAFFIC SIGNAL INFORMATION.

7. ONE CHANGEABLE MESSAGE SIGN SHALL BE REQUIRED AT EACH END OF THE PROJECT. SEE SPECIAL PROVISIONS. LOCATION SHALL BE AS DIRECTED BY RESIDENT ENGINEER.
8. CONTRACTOR TO PLACE TEMPORARY INFORMATION SIGNING PER DISTRICT 1 STANDARD TC-22.

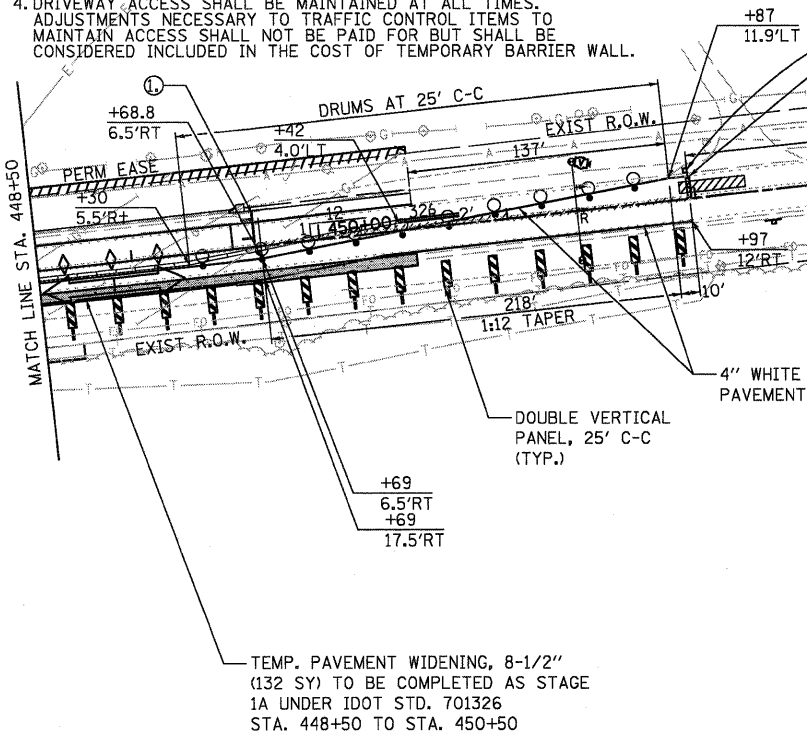

LEGEND

- | | | | |
|--|--|--|--|
| | TYPE III BARRICADE WITH FLASHING LIGHT | | TEMPORARY CONCRETE BARRIER W/ TYPE C MARKERS |
| | DETECTOR LOOPS | | DOUBLE VERTICAL PANEL |
| | IMPACT ATTENUATOR | | CRYSTAL BIDIRECTIONAL BARRIER WALL/ GUARDRAIL MARKER |
| | TEMPORARY PAVEMENT WIDENING, 8-1/2\"/> | | PERMANENT PAVEMENT MARKING REMOVAL |
| | SIGN (WORK ZONE) | | RAISED REFLECTOR REMOVAL |
| | DRUM WITH STEADY BURN LIGHT OR BARRICADE | | VIDEO DETECTION ZONE (35' X 6') |

STAGING PLAN NOTES:

1. TYPE III BARRICADE WITH ROAD CLOSED SIGN TO BE PLACED WHEN NO WORK IS BEING PERFORMED.
2. BARRIER WALL/GUARDRAIL MARKERS AT 25' cts. SEE STANDARDS 704001 & 635011.
3. WHEN TEMP. BRIDGE RAIL IS SPECIFIED, IT SHALL BE CONNECTED TO THE TEMP. CONC. BARRIER USING TRAFFIC BARRIER TERMINAL TYPE II.

END CONSTRUCTION
G20-2A(0)-3618
STA. 464+00, RT.
(NOT SHOWN)

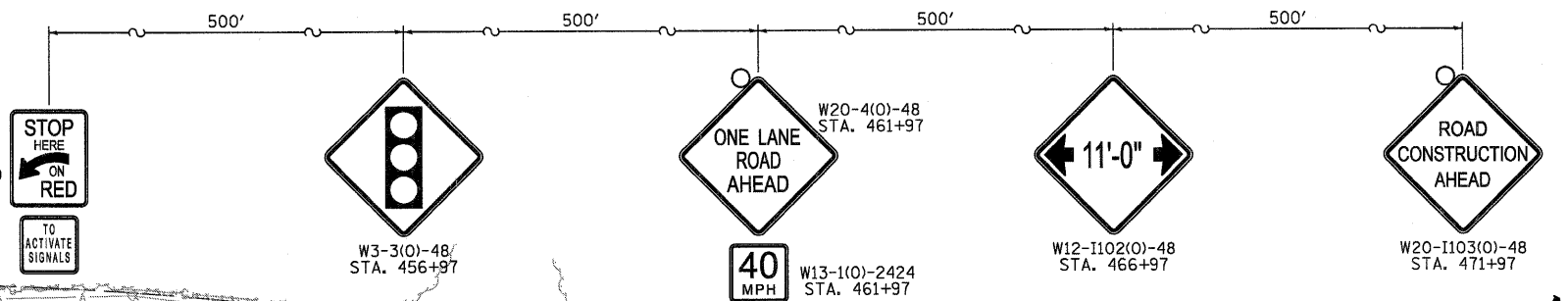

FILE NAME = F:\CBBEL_MEST_Proj\msta\2009\09-01-0147_IL173\Clv\1\09m\Sh\1\1616121-sh1-mo1-2.dgn

WILLS BURKE KELSEY ASSOCIATES LTD.
116 West Main Street, Suite 201
St. Charles, Illinois 60174
(630) 443-7755

USER NAME = #USER#	DESIGNED - SBP/KMA	REVISED -
PLOT SCALE =	DRAWN - AH	REVISED -
PLOT DATE = 1/5/2011	CHECKED - PJF	REVISED -
	DATE - 12/14/10	REVISED -

**STATE OF ILLINOIS
DEPARTMENT OF TRANSPORTATION**

**MAINTENANCE OF TRAFFIC
STAGE 1**

SCALE: SHEET NO. 26 OF 106 SHEETS STA. 442+50.0 TO STA. 452+15.0

F.A.P. RTE.	SECTION	COUNTY	TOTAL SHEETS	SHEET NO.
303	132 B-2	McHENRY	106	26
CONTRACT NO. 60129				
FED. ROAD DIST. NO. ILLINOIS FED. AID PROJECT				