

**TRAFFIC SIGNAL LEGEND**

	PROPOSED	EXISTING
DETECTOR LOOP	□	□
SIGNAL HEAD	—	□
G.S. CONDUIT IN TRENCH OR PUSHED	---	—
SIGNAL HEAD WITH BACKPLATE	—	—
RACEWAY FOR MAGNETIC DETECTOR, TYPE I OR II	—	—
VEHICLE DETECTOR, NON-COMPENSATED MAGNETIC TYPE	□	□

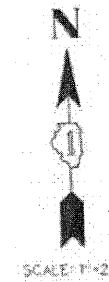

SCALE: 1"=20'

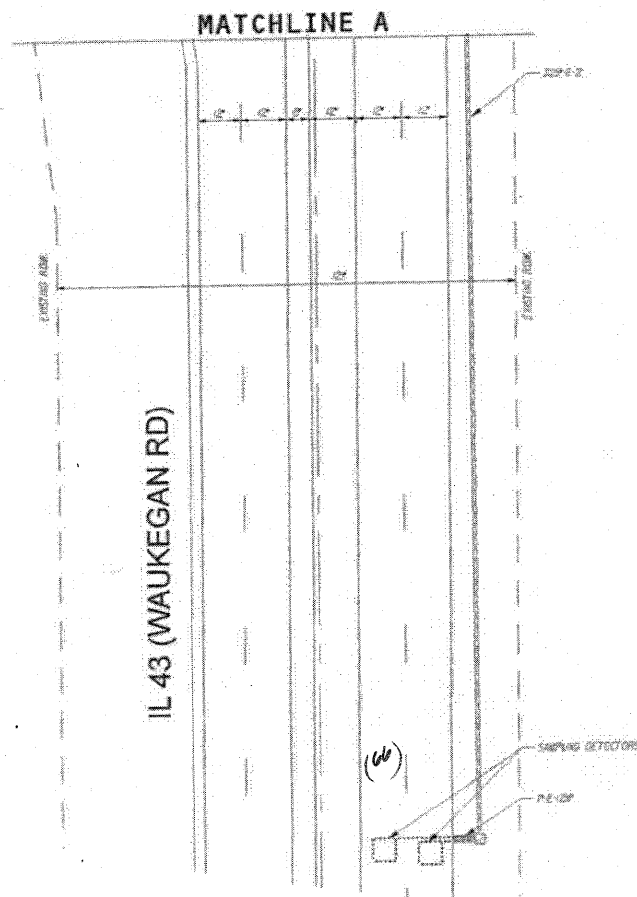
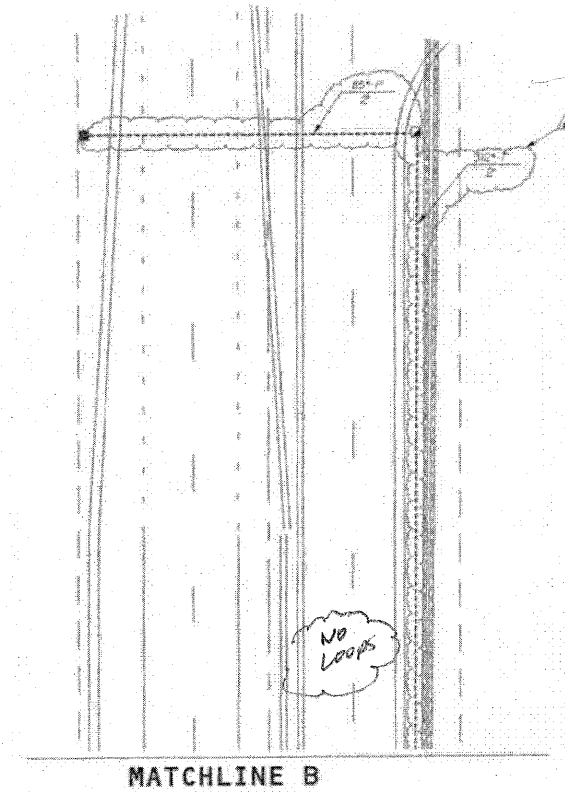
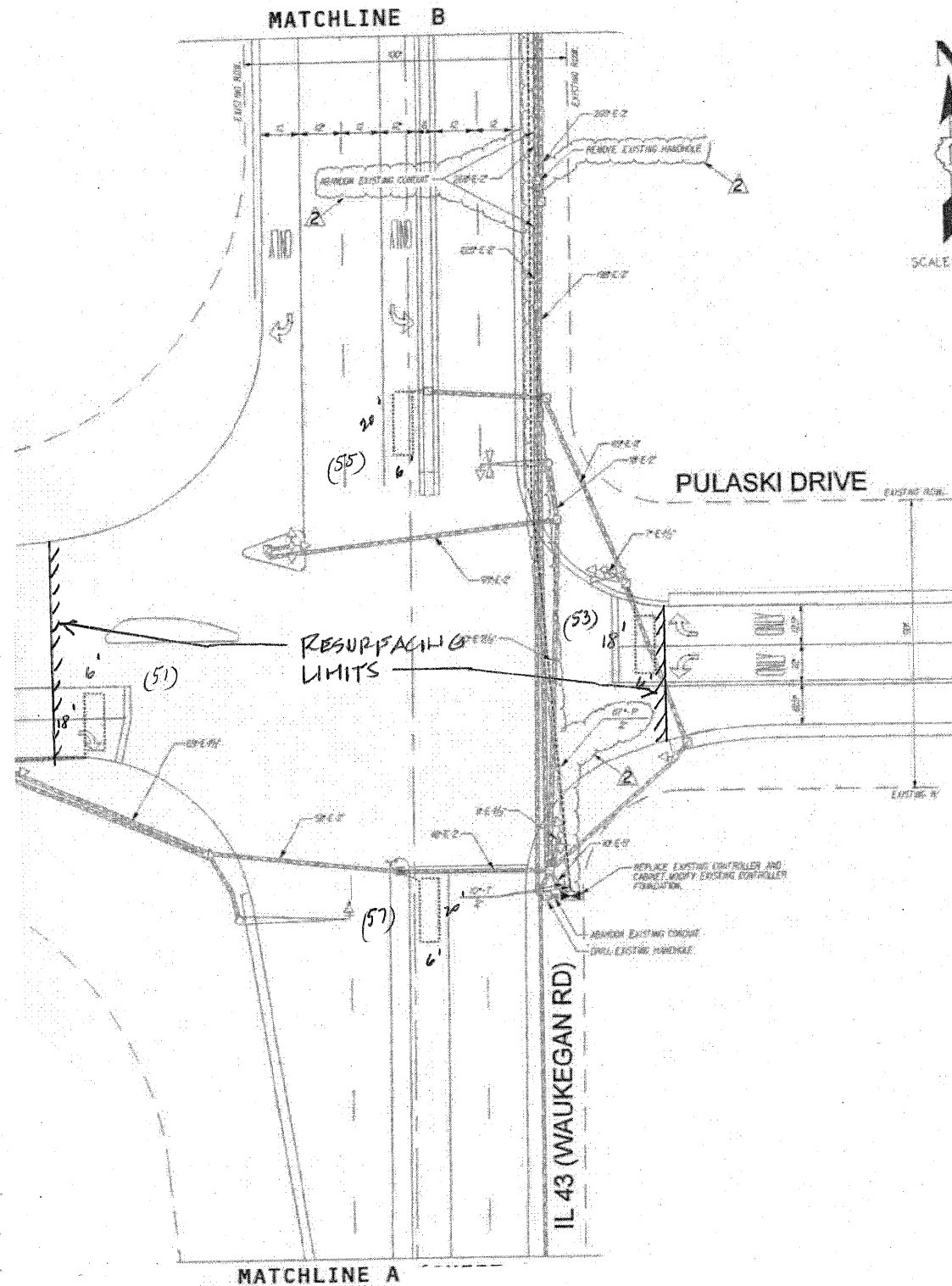

THIS PLAN IS FOR THE SOLE PURPOSE OF DETECTOR LOOP REPLACEMENTS ONLY

REPLACE ALL DETECTOR LOOPS AS SHOWN (WITHIN THE RESURFACING LIMITS)

CODE	QUANTITY	UNIT	ITEM
86600600	282	FOOT	DETECTOR LOOP, REPLACEMENT

FILE NAME =	USER NAME = kanthapxikeybo	DESIGNED - BCK	REVISED -
c:\pwork\FW100T\KANTHAPHIXAYBC\d81126	4\traffic.legend.v7.dgn	DRAWN - BCK	REVISED -
	PLOT SCALE = 3/4" = 1' IN.	CHECKED - DAD	REVISED -
	PLOT DATE = 4/3/2009	DATE -	REVISED -

STATE OF ILLINOIS  
DEPARTMENT OF TRANSPORTATION

DISTRICT ONE - DETECTOR LOOP REPLACEMENT  
IL, RTE. 43 @ PULASKI DR.

SCALE: NONE SHEET NO. OF SHEETS STA. TO STA.

F.A.M. RTE.	SECTION	COUNTY	TOTAL SHEETS	SHEET NO.
2706	126RS-6	LAKE	24	11
CONTRACT NO. 60K56				
FED. ROAD DIST. NO. [ILLINOIS] FED. AID PROJECT				