

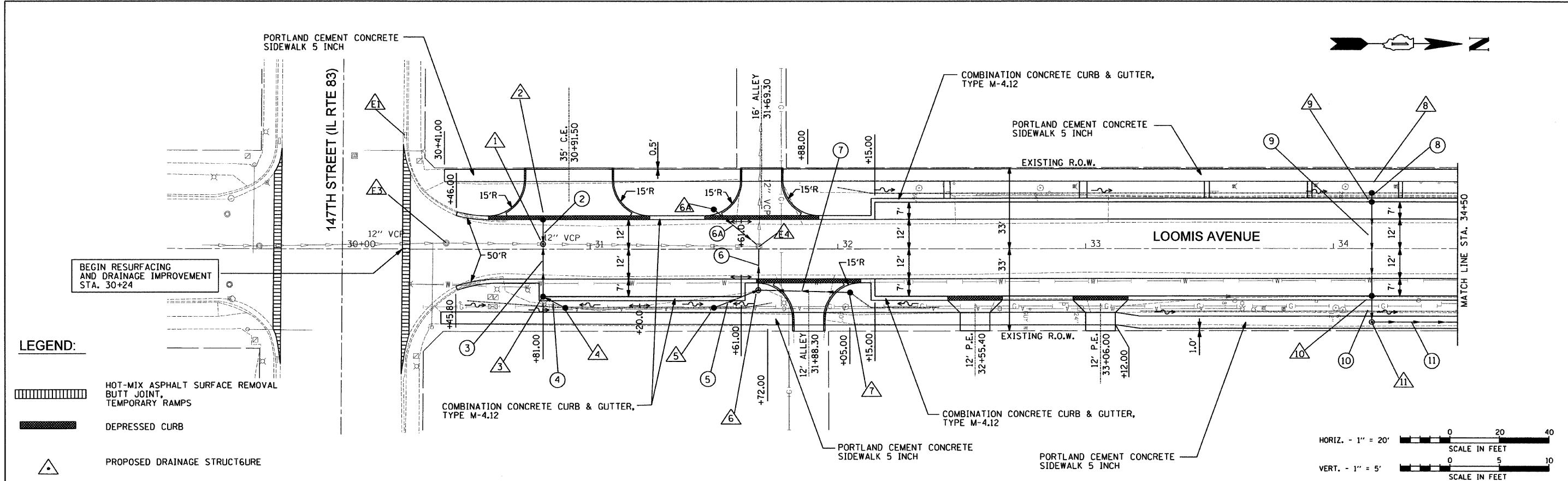







DATE	BY
DATE	BY

DATE	BY
DATE	BY



- LEGEND:**
-  HOT-MIX ASPHALT SURFACE REMOVAL BUTT JOINT, TEMPORARY RAMPS
  -  DEPRESSED CURB
  -  PROPOSED DRAINAGE STRUCTURE
  -  EXISTING DRAINAGE STRUCTURE
  -  PROPOSED STORM PIPE
  -  DRAINAGE STRUCTURE TO BE REMOVED
  -  STORM SEWER REMOVAL
  -  DRAINAGE & UTILITY STRUCTURE TO BE ADJUSTED
  -  TREE REMOVAL
  -  PROPOSED DRAINAGE SUMMIT

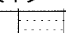
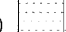
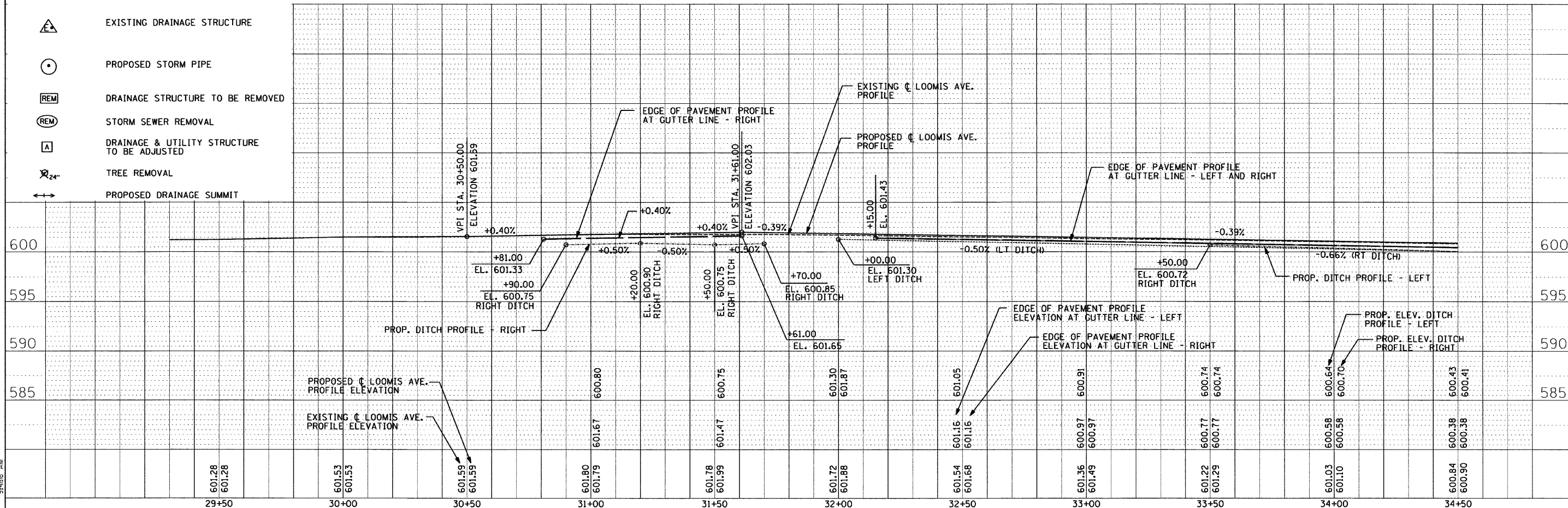
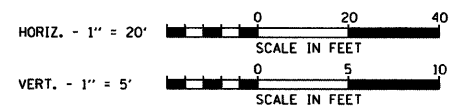

FILE NAME = S:\proj\2009\200903023-32\road\site\adgn\00\160K87-shr-plamp\plm.dwg 2/14/2011 9:41:16 AM	USER NAME = USER	DESIGNED - WS	REVISED -	<b>STATE OF ILLINOIS DEPARTMENT OF TRANSPORTATION</b>	<b>LOOMIS AVENUE FROM THORNTON RD. TO 150TH ST. ROADWAY AND DRAINAGE IMPROVEMENTS</b>	SBI RTE.	SECTION	COUNTY	TOTAL SHEETS	SHEET NO.
	PLOT SCALE = 20.0000' / IN.	DRAWN - WS	REVISED -			52	522 X-RS-1	COOK	44	15
PLOT DATE = 2/14/2011	CHECKED - RS	REVISED -	CONTRACT NO. 60K87							
DATE = 01-21-2010	REVISOR	REVISED -	ILLINOIS FED. AID PROJECT							

SCALE: 10H 5V    SHEET NO. 1 OF 4 SHEETS    STA. 30+24    TO STA. 34+50