

PLAN	SUBMITTED	DATE
	NOTE BOOK	
	ALIGNMENT CHECKED	
	BY: [Signature]	
	DATE	
	NO. OF SHEETS	
	NO. OF SHEETS CHECKED	
	NO. OF SHEETS NOTED	
	NO. OF SHEETS NOTED	

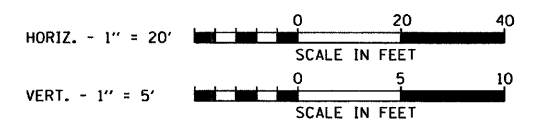

PROFILE	SUBMITTED	DATE
	NOTE BOOK	
	GRADES CHECKED	
	BY: [Signature]	
	DATE	
	NO. OF SHEETS	
	NO. OF SHEETS CHECKED	
	NO. OF SHEETS NOTED	
	NO. OF SHEETS NOTED	

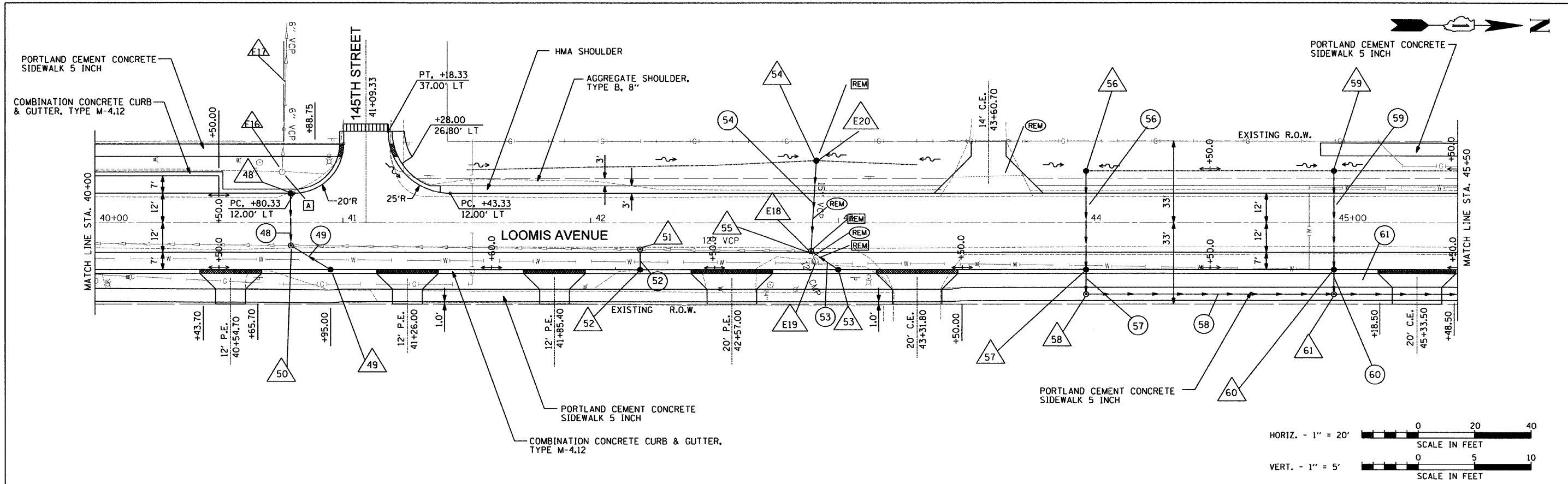
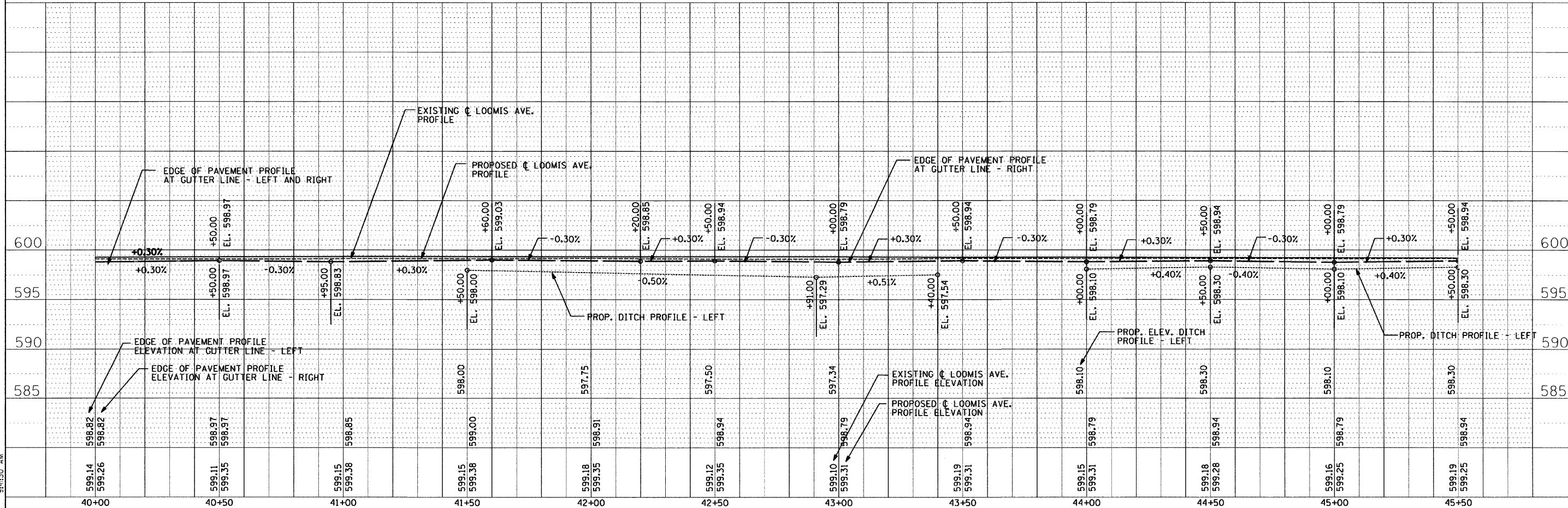

FILE NAME =	USER NAME = USER	DESIGNED - WS	REVISED -	STATE OF ILLINOIS DEPARTMENT OF TRANSPORTATION	LOOMIS AVENUE FROM THORNTON RD. TO 150TH ST. ROADWAY AND DRAINAGE IMPROVEMENTS	SBI	SECTION	COUNTY	TOTAL	SHEET	
#FILE#	PLOT SCALE = 20.0000' / IN.	DRAWN - WS	REVISED -			52	522 X-RS-1	COOK	44	17	
	PLOT DATE = 2/14/2011	CHECKED - RS	REVISED -			CONTRACT NO. 60K87					
		DATE - 01-21-2010	REVISED -			ILLINOIS FED. AID PROJECT					
FILE: h:\jobs\2009\20093021-32\cod\site\dgn\00\160487-sht-plonpr1.dgn 2/14/2011 9:41:30 AM						SCALE: 10H 5V SHEET NO. 3 OF 4 SHEETS STA. 40+00 TO STA. 45+50					