

PIER 17 - NORTH FACE ELEVATION

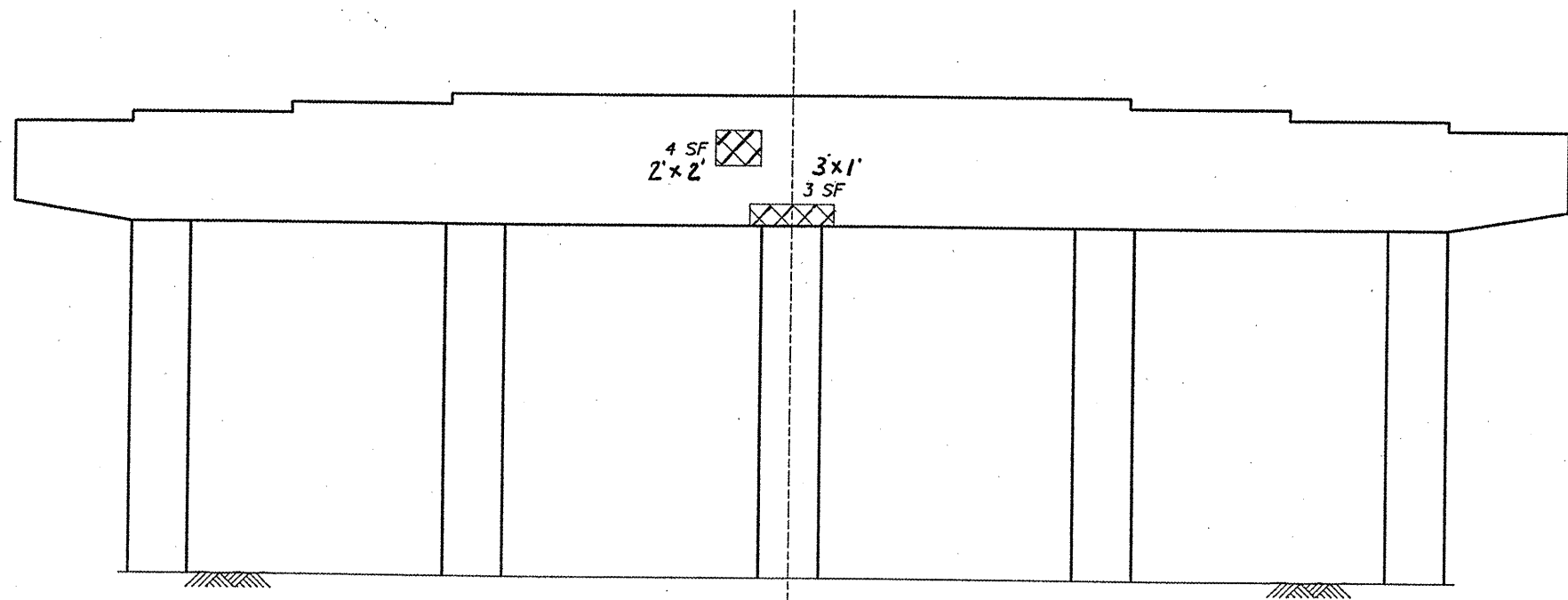

PIER 17 - SOUTH FACE ELEVATION

PIER 17 BILL OF MATERIAL	UNIT	QUANTITY
STRUCTURAL REPAIR OF CONCRETE $\leq 5''$	SQ. FT.	13



STRUCTURAL REPAIR OF CONCRETE $\leq 5''$

FILE NAME = c:\pwork\pwork\occonnell\td8228385\0	USER NAME = occonnellte 759518-sht-plan.dgn	DESIGNED - DRAWN -	REVISED - REVISED -	STATE OF ILLINOIS DEPARTMENT OF TRANSPORTATION	LOCATION 1 SN 016-0806	PIER 17	F.A. RTE.	SECTION	COUNTY	TOTAL SHEETS	SHEET NO.	
PLOT SCALE = 105.0928' / IN.	CHECKED -	REVISED -	SCALE:		SHEET NO. 35 OF 45 SHEETS		STA.	TO STA.	2010-068 BR	COOK	69	40
PLOT DATE = 9/1/2010	DATE -	REVISED -							CONTRACT NO. 60L51			
									ILLINOIS FED. AID PROJECT			