

MATCH LINE STA. 138 + 00

NOTE: SEE ALIGNMENT, TIES AND BENCHMARKS FOR RIGHT-OF-WAY AND EASEMENT STATION AND OFFSET. PLACE PERIMETER EROSION BARRIER 1' INSIDE RIGHT OF WAY OR PERMANENT EASEMENT WHERE PERIMETER EROSION BARRIER IS SHOWN PARALLEL TO PROPOSED RIGHT OF WAY OR TO PROPOSED PERMANENT EASEMENT.

- EROSION CONTROL LEGEND**
- STABILIZED CONSTRUCTION ENTRANCE
  - PERIMETER EROSION BARRIER
  - WORK ZONE (STAGE 2A)
  - WORK ZONE (STAGE 2B)
  - LIMITS OF GRADING
  - TEMPORARY DITCH CHECK

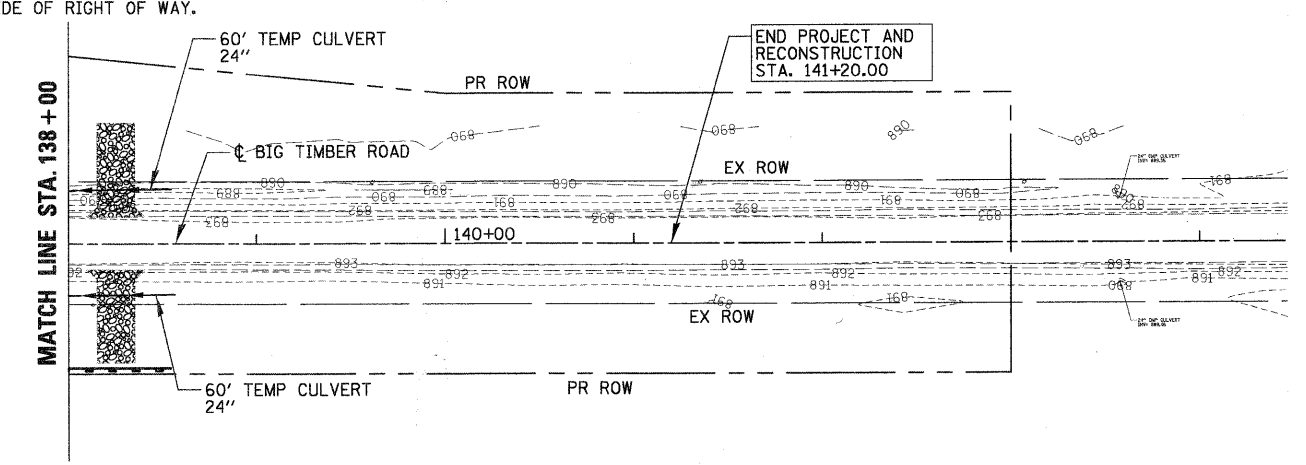

**CHRISTOPHER B. BURKE ENGINEERING, LTD.**  
 5575 W. Higgins Road, Suite 600  
 Rosemont, Illinois 60018  
 (847) 823-0500

|  |                   |                   |           |
|--|-------------------|-------------------|-----------|
| FILE NAME = N:\kane\county\04198\Civil\2\EC\04198-2-02.SHT | USER NAME = BLUKE | DESIGNED - BLL    | REVISED - |
| PLOT SCALE = 50'   |                   | DRAWN - PMM       | REVISED - |
| PLOT DATE = 2/7/2011                                       |                   | CHECKED - JGS     | REVISED - |
|  |                   | DATE - 02/07/2011 | REVISED - |

**STATE OF ILLINOIS  
DEPARTMENT OF TRANSPORTATION**

**FAS 0130 - BIG TIMBER ROAD  
EROSION AND SEDIMENT CONTROL PLANS - STAGE 2**

SCALE: 1"=50' SHEET NO. OF SHEETS STA. 124+50 TO STA. 144+50

|   |                        |             |                 |              |
|---|------------------------|-------------|-----------------|--------------|
| F.A.S. RTE. 0130  | SECTION 01-00266-00-BR | COUNTY KANE | TOTAL SHEETS 70 | SHEET NO. 12 |
| CONTRACT NO. 63196  |                        |             |                 |              |
| FED. ROAD DIST. NO. 1 ILLINOIS FED. AID PROJECT BRM-800310431 |                        |             |                 |              |