

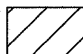

- LEGEND**
-  CONSTRUCTION ZONE
  -  TYPE II, 50' C-C BARRICADE
  -  SIGN (SEE LEGEND FOR DETAILS)

NOTE: PAVEMENT MARKING TAPE, TYPE III MUST BE USED ON THE PAVEMENT OUTSIDE OF THE PROJECT LIMITS IN ALL STAGES. FOR STAGE III, USE PAVEMENT MARKING TAPE, TYPE III ON THE NEW HMA SURFACE PRIOR TO THERMALPLASTIC PAVEMENT MARKINGS.

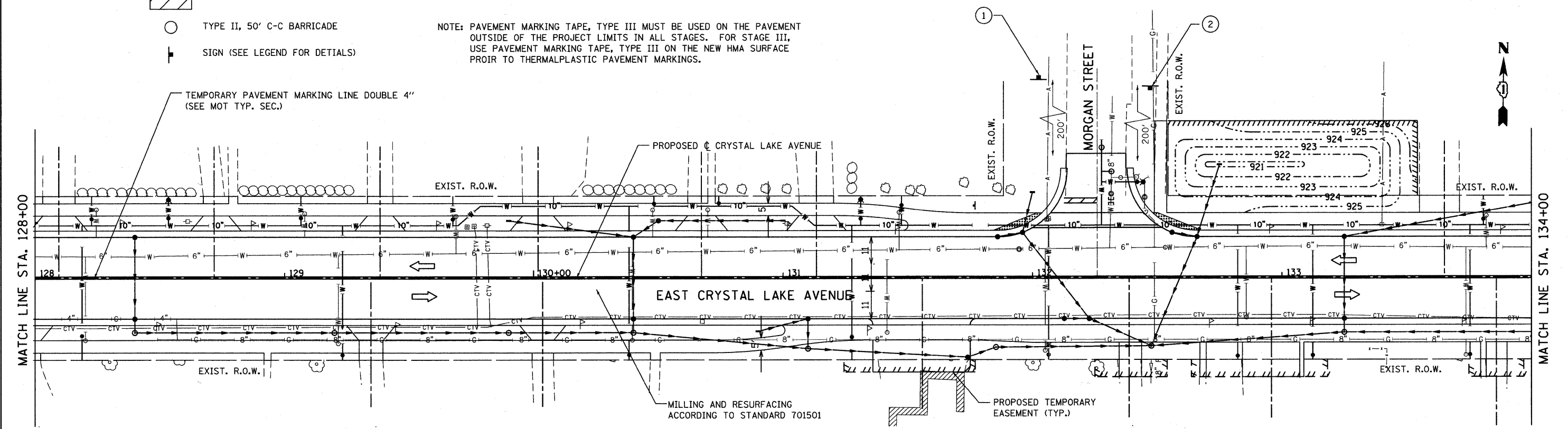

FILE NAME =	USER NAME = gollwenger	DESIGNED - GJE	REVISED -	<b>STATE OF ILLINOIS DEPARTMENT OF TRANSPORTATION</b>	<b>EAST CRYSTAL LAKE AVENUE SUGGESTED STAGES OF CONSTRUCTION AND TRAFFIC CONTROL - STAGE 3</b>			F.A.U. RTE.	SECTION	COUNTY	TOTAL SHEETS	SHEET NO.
F:\789-006 East Crystal Lake Ave SEGMENT	I:\CADD_Sheets\0163524-shr-staging3e.dgn	DRAWN - GJE	REVISED -		116	06-00104-01-WR	McHENRY	64	18			
	PLOT SCALE = 20,0000' / IN.	CHECKED - JP	REVISED -		SCALE: 1"=20'			SHEET NO. 18 OF 64 SHEETS		CONTRACT NO. 63524		
	PLOT DATE = 2/17/2011	DATE - 02/7/2011	REVISED -		STA. 125+10 TO STA. 134+00			ILLINOIS FED. AID PROJECT				