

FINAL SURVEY	DATE
SURVEYED	BY
TEMPLATE	
AREAS CHECKED	
NO.	

ORIGINAL SURVEY	DATE
SURVEYED	BY
TEMPLATE	
AREAS CHECKED	
NO.	

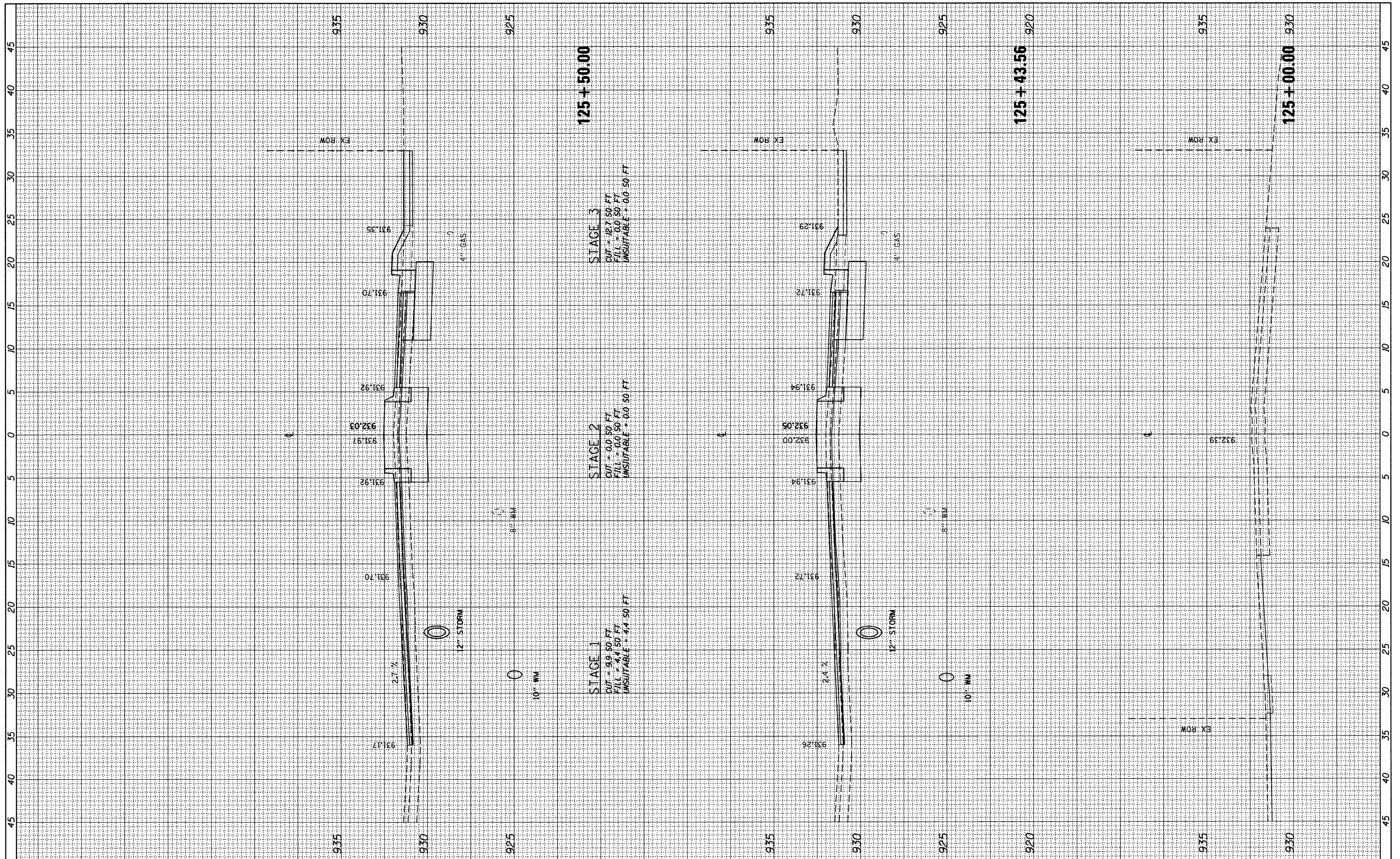

FILE NAME =	USER NAME = gellwenger	DESIGNED - GJE	REVISED -
F:\789-006 East Crystal Lake Ave SEGMENT 1\CADD_Sheets\0163524-sht-xsec.dgn		DRAWN - GJE	REVISED -
PLOT SCALE = 5.0000' / IN.		CHECKED - JP	REVISED -
PLOT DATE = 2/17/2011		DATE - 02/7/2011	REVISED -

DESIGNED - GJE	REVISED -
DRAWN - GJE	REVISED -
CHECKED - JP	REVISED -
DATE - 02/7/2011	REVISED -

**STATE OF ILLINOIS
DEPARTMENT OF TRANSPORTATION**

**EAST CRYSTAL LAKE AVENUE
CROSS SECTIONS**

HORZ. 1"=5'
SCALE: VERT. 1"=2.5' SHEET NO. 47 OF 64 SHEETS STA. 125+00.00 TO STA. 125+50.00

F.A.U. RTE.	SECTION	COUNTY	TOTAL SHEETS	SHEET NO.
116	06-00104-01-WR	MCHENRY	64	47
ILLINOIS FED. AID PROJECT			CONTRACT NO. 63524	