

FINAL SURVEY	SURVEYED	BY	DATE
NOTE BOOK	PLOTTED		
NO.	AREAS CHECKED		

ORIGINAL SURVEY	SURVEYED	BY	DATE
NOTE BOOK	PLOTTED		
NO.	AREAS CHECKED		

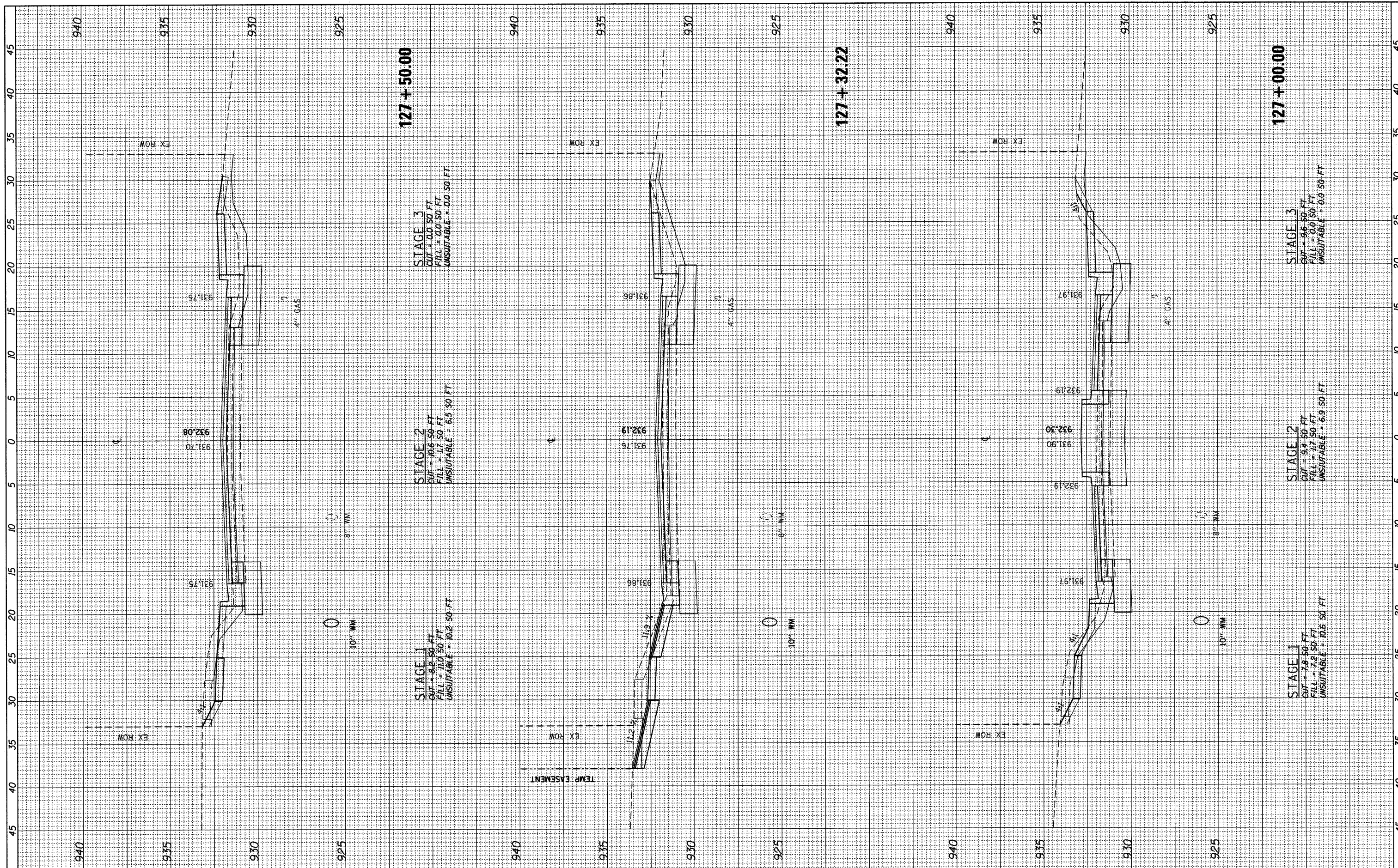

FILE NAME = F:\789-006 East Crystal Lake Ave SEGMENT 1\CADD_Sheets\DI63524-ahf-xsec.dgn

USER NAME = gellwanger
 DESIGNED - GJE
 DRAWN - GJE
 CHECKED - JP
 DATE - 02/7/2011

REVISIONS
 REVISED -
 REVISED -
 REVISED -
 REVISED -

**STATE OF ILLINOIS
 DEPARTMENT OF TRANSPORTATION**

**EAST CRYSTAL LAKE AVENUE
 CROSS SECTIONS**
 HORZ. 1"=5'
 SCALE: VERT. 1"=2.5' SHEET NO. 49 OF 64 SHEETS STA. 127+00.00 TO STA. 127+50.00

F.A.U. RTE.	SECTION	COUNTY	TOTAL SHEETS	SHEET NO.
116	06-00104-01-WR	MCHENRY	64	49
ILLINOIS FED. AID PROJECT			CONTRACT NO. 63524	