

FINAL SURVEY	SURVEYED	BY	DATE
NOTE BOOK	TEMPLATE		
NO.	AREAS CHECKED		

ORIGINAL SURVEY	SURVEYED	BY	DATE
NOTE BOOK	TEMPLATE		
NO.	AREAS CHECKED		

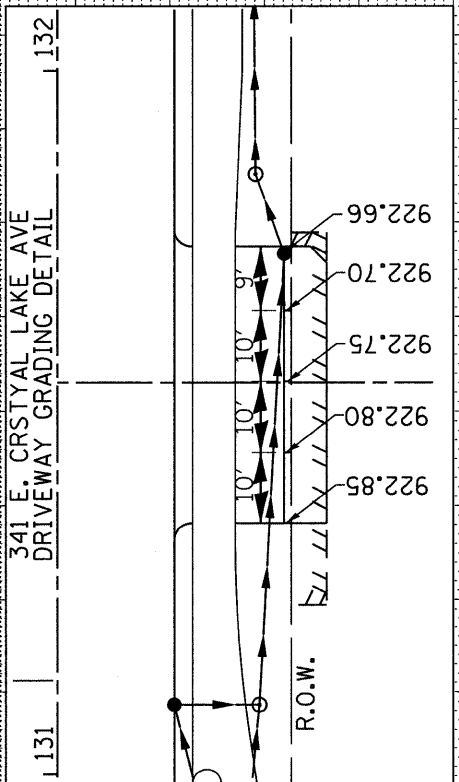
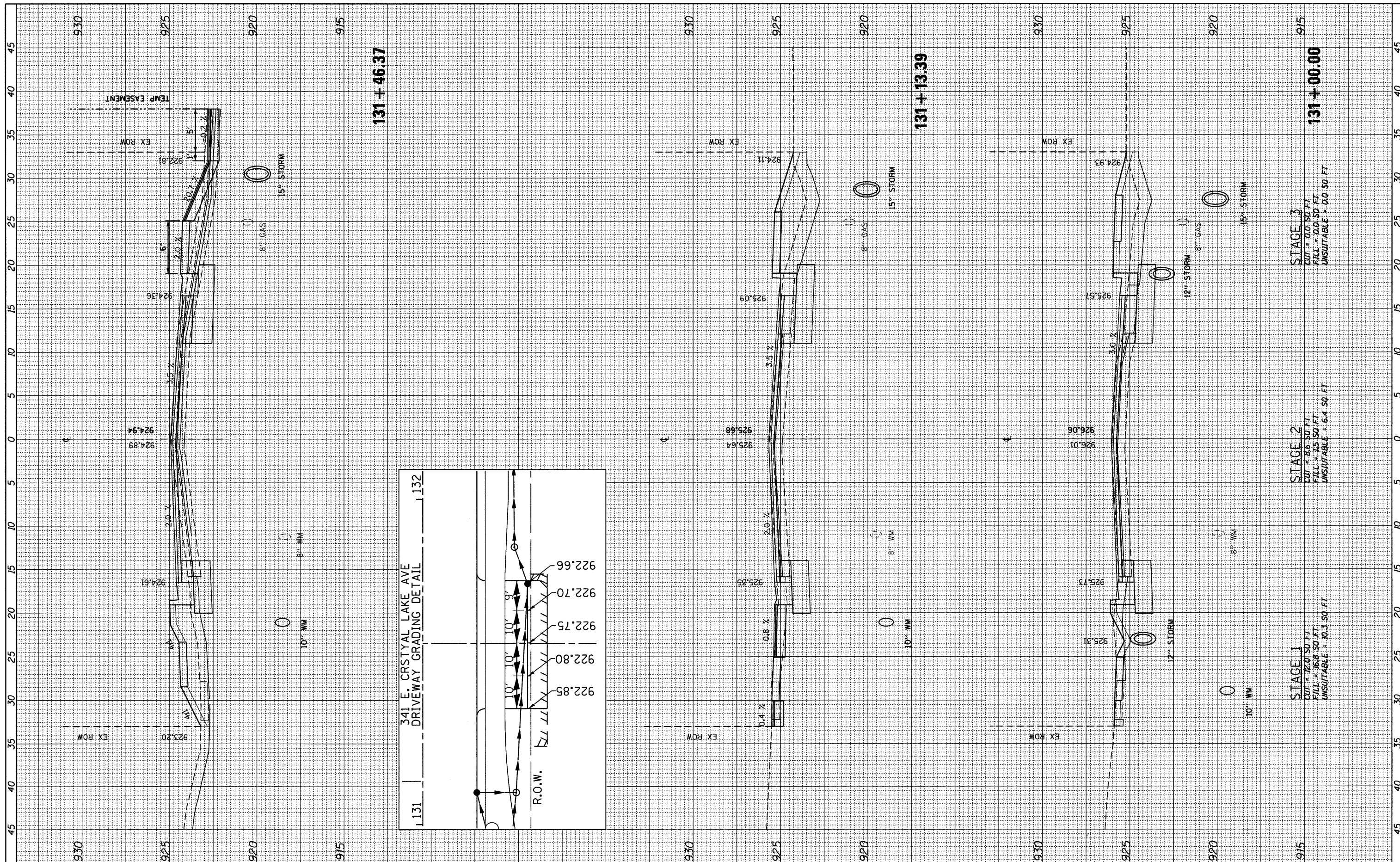

FILE NAME = F:\789-006 East Crystal Lake Ave SEGMENT 1\CADD_Sheets\0163924-sht-xsec.dgn	USER NAME = gellwanger	DESIGNED - GJE	REVISED -	STATE OF ILLINOIS DEPARTMENT OF TRANSPORTATION EAST CRYSTAL LAKE AVENUE CROSS SECTIONS HORZ. 1"=5' SCALE: VERT. 1"=2.5' SHEET NO. 55 OF 64 SHEETS STA. 131+00.00 TO STA. 131+46.37	F.A.U. RTE. 116	SECTION 06-00104-01-WR	COUNTY MCHENRY	TOTAL SHEETS 64	SHEET NO. 55
PLOT SCALE = 5,00000' / IN.	CHECKED - JP	DATE - 02/7/2011	REVISIONS		CONTRACT NO. 63524				
PLOT DATE = 2/17/2011					ILLINOIS FED. AID PROJECT				