

FINAL SURVEY	SURVEYED	BY	DATE
NOTE BOOK	TEMPLATE		
AREAS CHECKED			

ORIGINAL SURVEY	SURVEYED	BY	DATE
NOTE BOOK	TEMPLATE		
AREAS CHECKED			

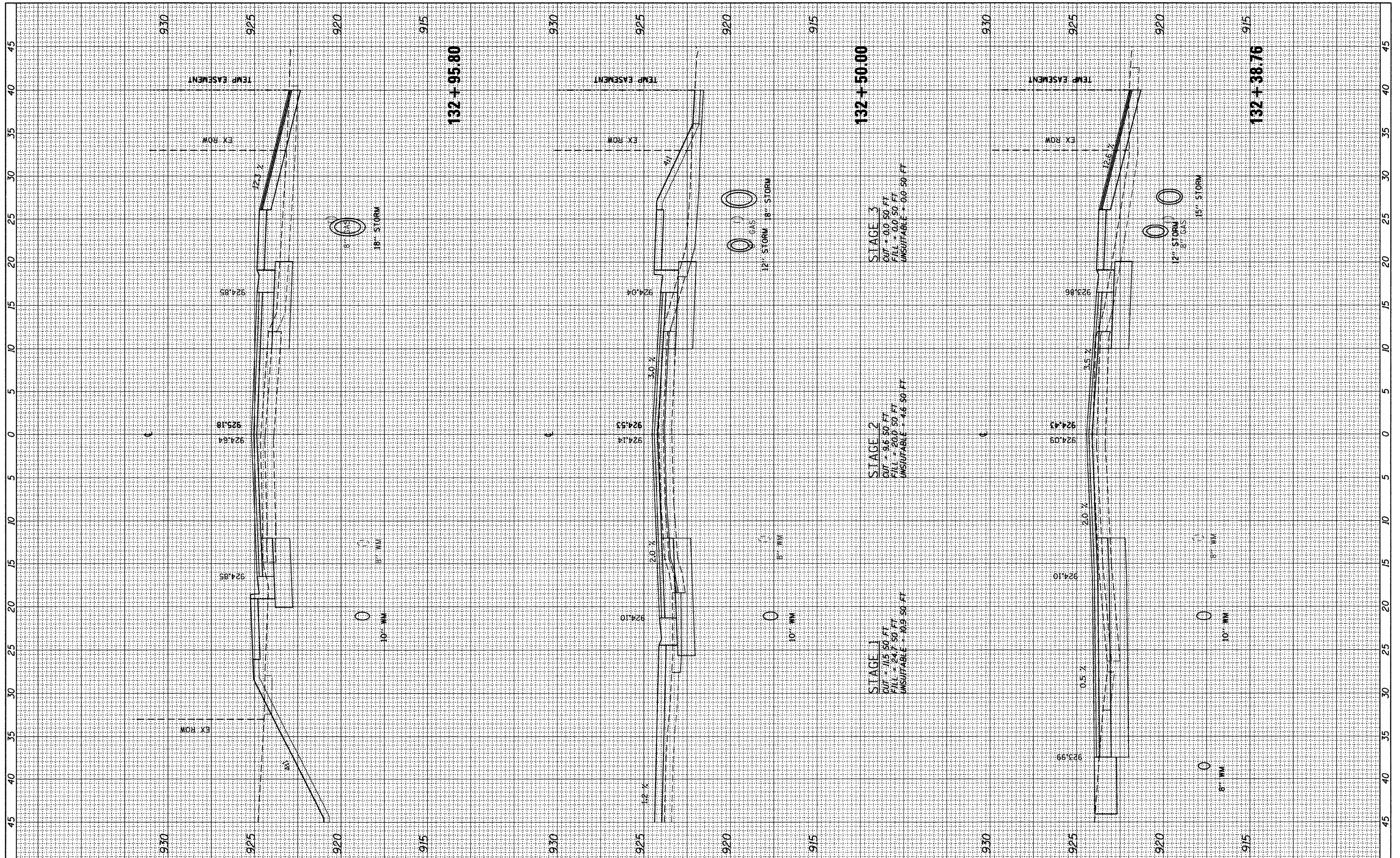

FILE NAME =	USER NAME = gollwanger	DESIGNED - GJE	REVISED -
F:\789-006 East Crystal Lake Ave SEGMENT 1\CAAD_Sheets\0163524-sht-xsec.dgn		DRAWN - GJE	REVISED -
		CHECKED - JP	REVISED -
		DATE - 02/7/2011	REVISED -

**STATE OF ILLINOIS  
DEPARTMENT OF TRANSPORTATION**

**EAST CRYSTAL LAKE AVENUE  
CROSS SECTIONS**

HORZ. 1"=5'  
SCALE: VERT. 1"=2.5' SHEET NO. 57 OF 64 SHEETS

F.A.U. RTE.	SECTION	COUNTY	TOTAL SHEETS	SHEET NO.
116	06-00104-01-WR	MCHENRY	64	57
			CONTRACT NO. 63524	
ILLINOIS FED. AID PROJECT				