

QUANTITY
4 (100) LINE = 64.1 ft. (19.7 m)
21.1 sq. ft. (1.97 sq. m)

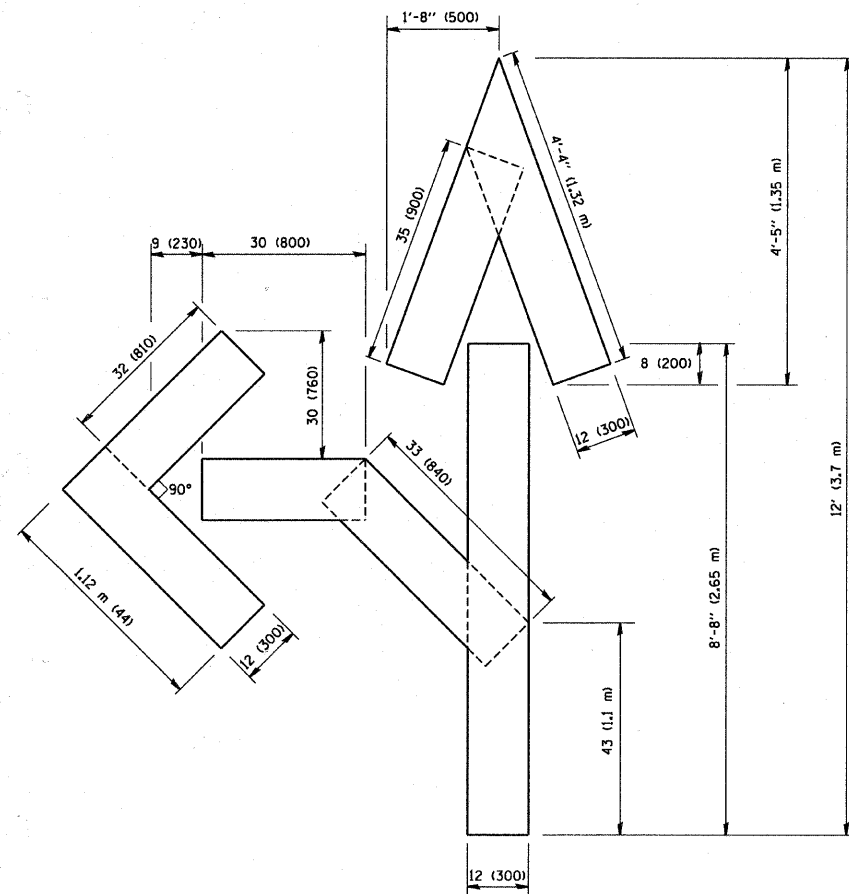

QUANTITY
4 (100) LINE = 82.5 ft. (25.3 m)
27.5 sq. ft. (2.53 sq. m)

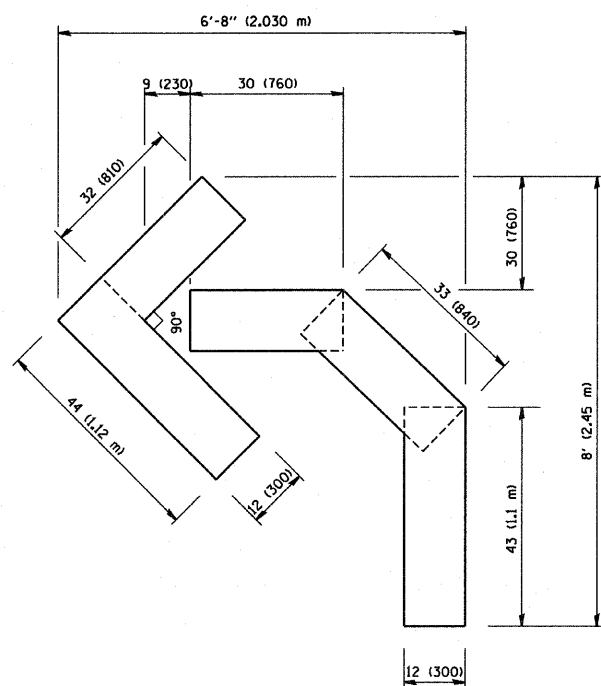

QUANTITY
4 (100) LINE = 45.5 ft. (13.9 m)
15.2 sq. ft. (1.39 sq. m)

All dimensions are in inches (millimeters) unless otherwise shown.

FILE NAME = W:\diststd\22x34\tbl6.dgn	USER NAME = gaglianobt	DESIGNED - DRAWN -	REVISED - REVISED - REVISED - REVISED -
		CHECKED -	T. RAMMACHER 06-05-96
		DATE - 09-18-94	T. RAMMACHER 11-04-97
			T. RAMMACHER 03-02-98
			E. GOMEZ 08-28-00

STATE OF ILLINOIS
DEPARTMENT OF TRANSPORTATION

PAVEMENT MARKING LETTERS AND SYMBOLS
FOR TRAFFIC STAGING

SCALE: NONE SHEET NO. 1 OF 1 SHEETS STA. TO STA.

F.A.S. RTE. 0028	SECTION 06-00320-01-BR	COUNTY MCHENRY	TOTAL SHEETS 70	SHEET NO. 62
TC-16			CONTRACT NO. 63535	
FED. ROAD DIST. NO. 1 ILLINOIS FED. AID PROJECT BRS-0028(107)				