

COPYRIGHT © 2011 BY BAXTER & WOODMAN, INC.  
 STATE OF ILLINOIS - PROFESSIONAL DESIGN FIRM  
 LICENSE NO. - BR-00021 - EXPIRES 4/30/2011  
 2/2/2011 E:\Motorway\10630\10630-Lawrence\10630-Phase 2\Lawrence\10630-Plat XS\Lawrence.plt  
 ...:\p10630\10630-Lawrence\10630-Plat XS\Lawrence.plt

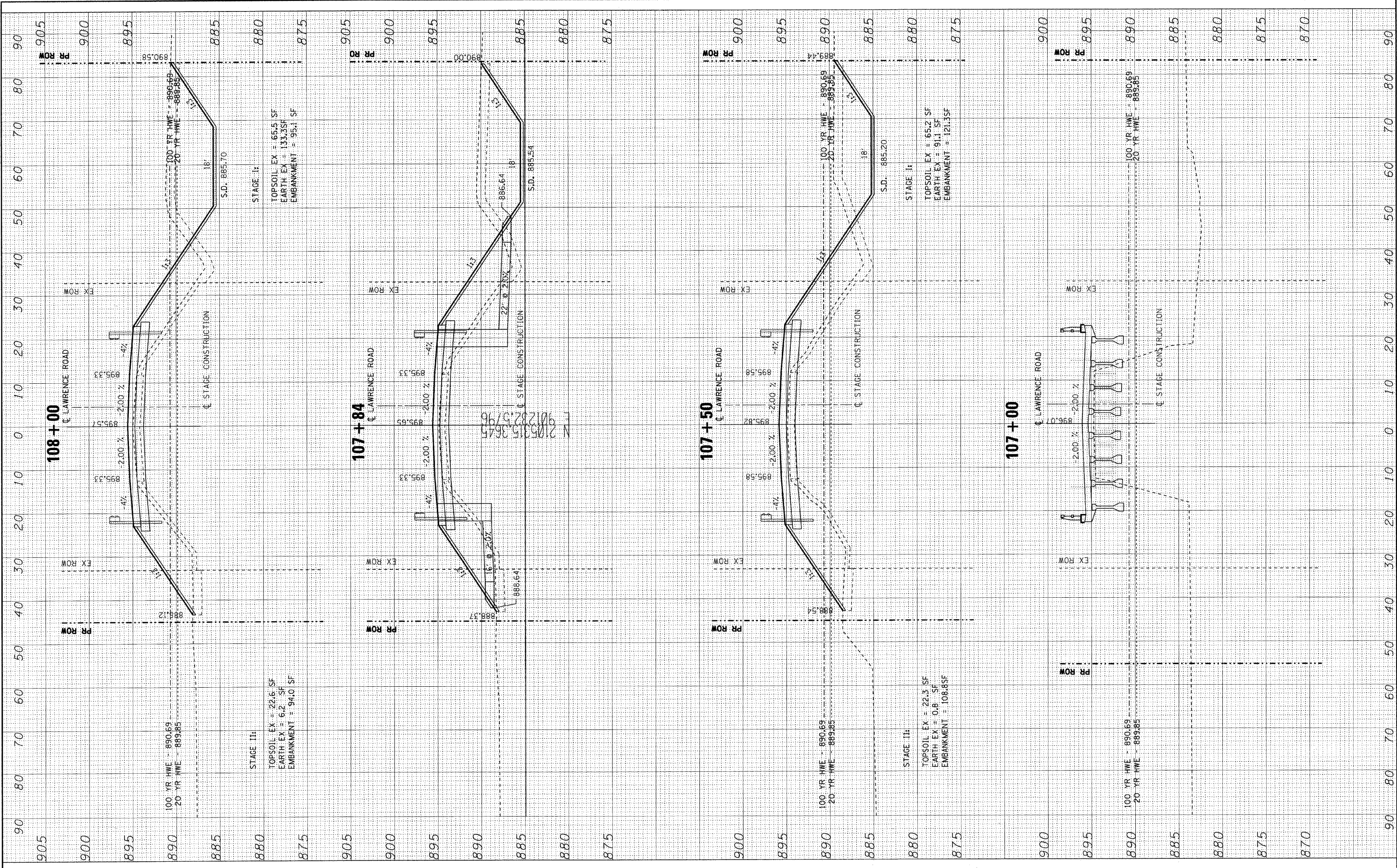

DESIGNED - CAC	REVISED -
DRAWN - BCD	REVISED -
CHECKED - TMS	REVISED -
DATE - 08-20-10	REVISED -

**MCHENRY COUNTY DIVISION OF TRANSPORTATION  
 LAWRENCE ROAD BRIDGE OVER  
 LAWRENCE CREEK**

SCALE: H: 1"=10' V: 1"=5'

**CROSS SECTIONS**

STA. TO STA.

F.A.S. RTE. 0028	SECTION 06-00320-01-BR	COUNTY MCHENRY	TOTAL SHEETS 70	SHEET NO. 68
JOB NO. C-91-139-11 ILLINOIS FED. AID PROJECT			CONTRACT NO. 63535	
			BRS-0028(107)	