



TOYOTA PARK

LEGEND:
 CONSTRUCTION WORK ZONE

PROJECT COMMITMENTS FOR ILLINOIS BRICK AND RESIDENCES:

1. THE EXISTING ILLINOIS BRICK DRIVEWAY OFF OF 71ST STREET WILL BE PERMANENTLY CLOSED PRIOR TO THE START OF CONSTRUCTION BY ILLINOIS BRICK.
2. TEMPORARY FENCING MUST BE PROVIDED TO RESTRICT ACCESS TO THE ILLINOIS BRICK PROPERTY AT ALL TIMES DURING CONSTRUCTION UNTIL THE PERMANENT FENCE IS INSTALLED.
3. FOR APPROVED DRIVEWAY CLOSURES, PROVIDE TEMPORARY PARKING FOR THE IMPACTED PROPERTY OWNER(S) AT A DESIGNATED LOCATION WITHIN 400 FEET OF THE PROPERTY. THE TEMPORARY PARKING LOCATION MUST BE APPROVED BY THE ENGINEER AND PROVIDE A MINIMUM OF ONE (1) PARKING SPACE PER PROPERTY. PEDESTRIAN ACCESS MUST BE MAINTAINED TO THE PROPERTY AT ALL TIMES. PROVIDE AN ADA COMPLIANT WALKWAY FOR THE SAFE TRAVEL OF PEDESTRIANS.

STAGING NOTES:

4. ALL WORK IN THIS STAGE SHALL BE DONE ACCORDING TO THE DETAILS IN THE PLANS AND USING THE APPROPRIATE HIGHWAY STANDARDS.

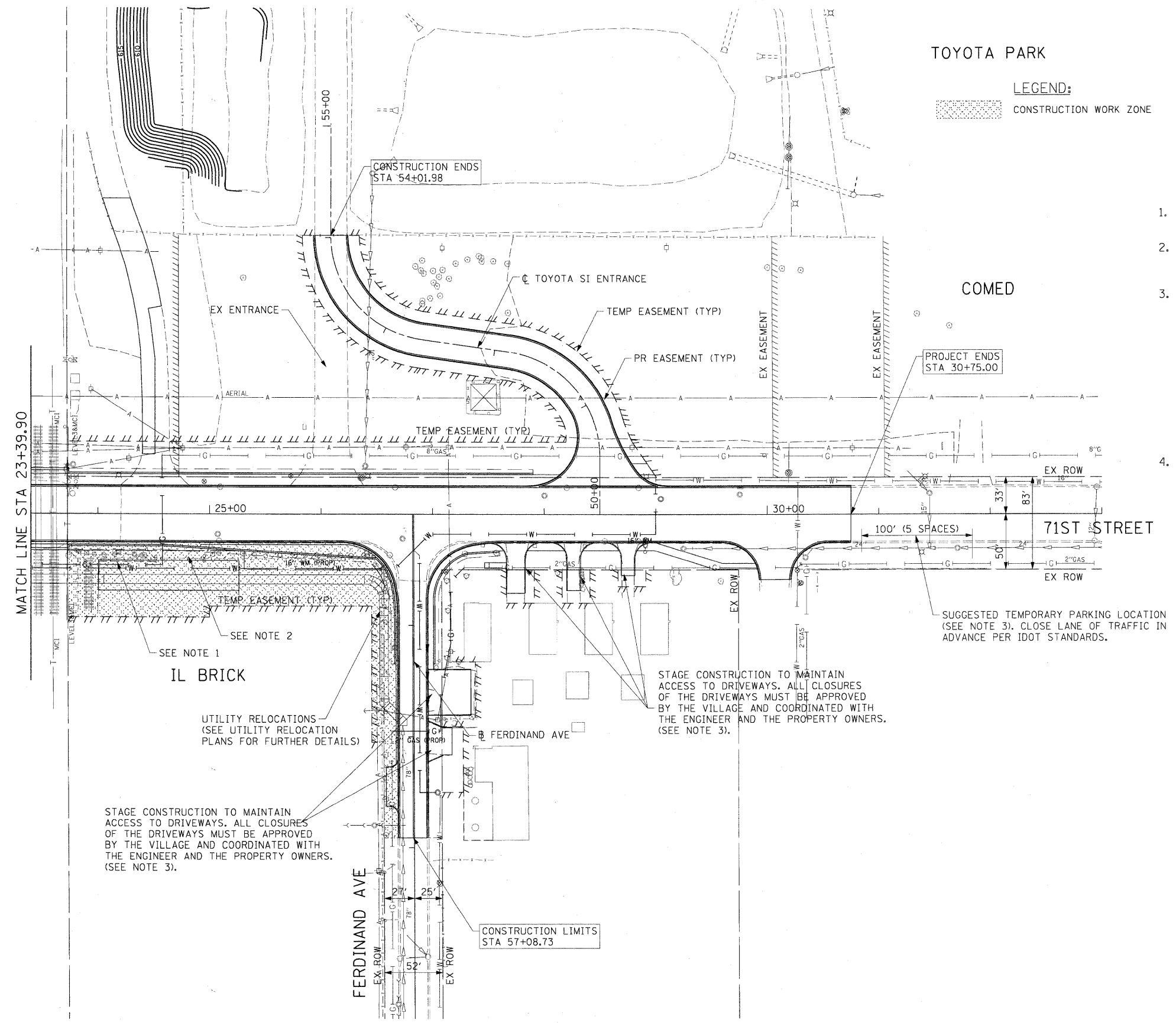

SUGGESTED ILLINOIS BRICK CONSTRUCTION AND TRAFFIC CONTROL

FILE NAME = P:\60155677\000 CAD\001 Drawings\Staging\Staging.dwg



USER NAME = manj	DESIGNED - TJW	REVISED -
PLOT SCALE = 50.000' / 1"	DRAWN - JWM	REVISED -
PLOT DATE = 3/15/2011	CHECKED - TJW	REVISED -
	DATE - March 17, 2011	REVISED -

CONSTRUCTION LIMITS STA 57+08.73

STATE OF ILLINOIS
 DEPARTMENT OF TRANSPORTATION

WORK ZONE AND STAGING REQUIREMENTS PLAN -
 ILLINOIS BRICK

SCALE: 1"=50' SHEET NO. 6 OF 10 SHEETS STA 25+00.00 TO STA 30+75.00

F.A.U. RTE.	SECTION	COUNTY	TOTAL SHEETS	SHEET NO.
1537	06-00050-00-GS	COOK	209	36
CONTRACT NO. 63556			FED. ROAD DIST. NO. 1 ILLINOIS FED. AID PROJECT CRE-90031709	