

TYPICAL WALL SECTION

*See Soldier Pile Plan & Elevation Sheets for pile size, spacing, length and top and bottom elevations.

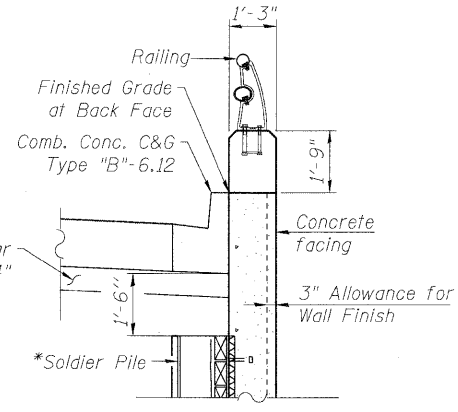

DETAIL A

Wall Section by Pepsico Driveway
Str. No. 016-7722 (Sta. 19+05 to Sta. 20+83)

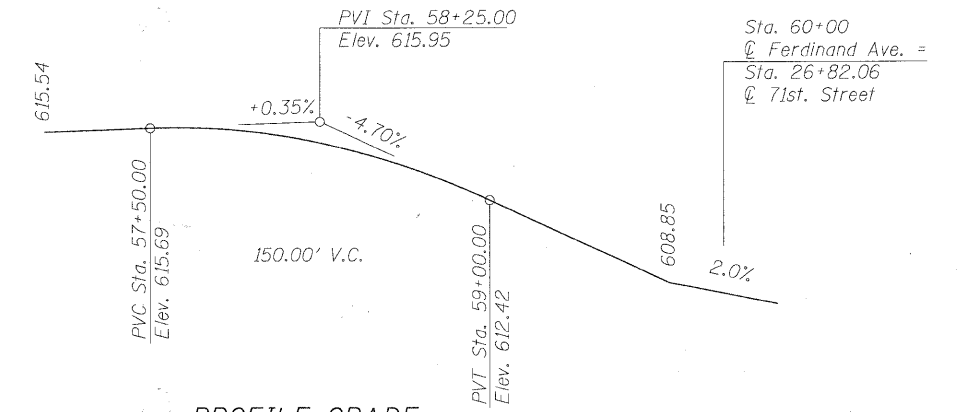

PROFILE GRADE

(along proposed Ferdinand Ave.)

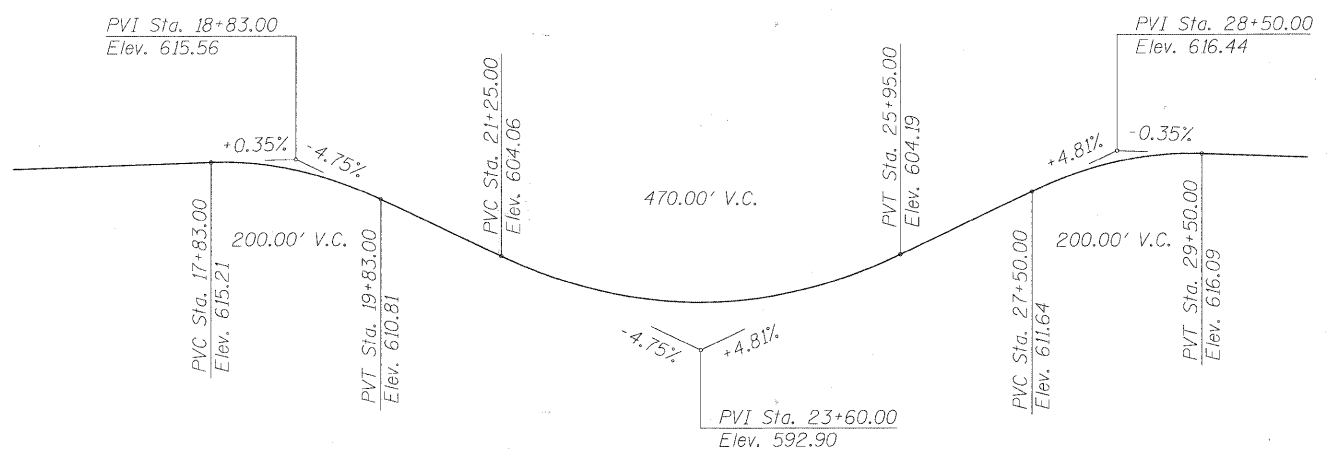

PROFILE GRADE

(along proposed 71st. Street)

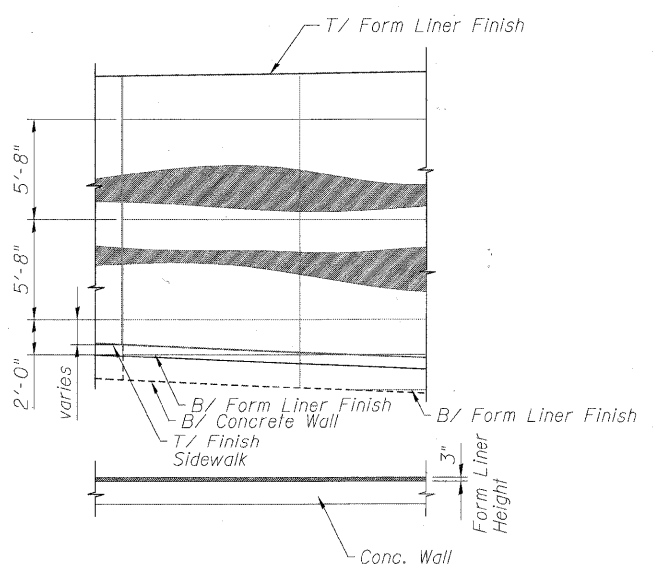

TYPICAL DETAIL FOR FORM LINER

NOTE:

The Contractor is responsible for the design and performance of the lagging using no less than a 3 in. normal rough-sawn thickness and timber with a minimum allowable bending stress of 1000 psi.

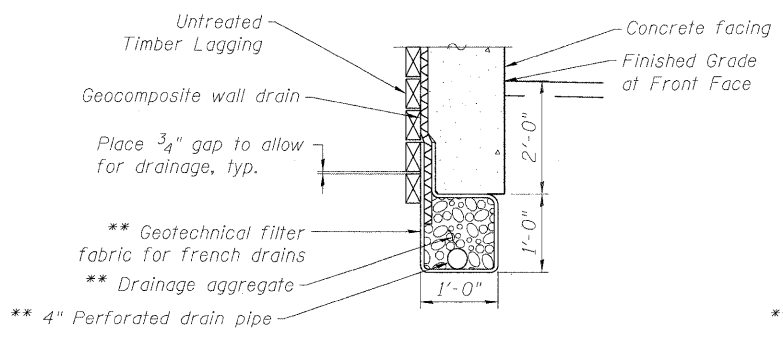

BETWEEN SOLDIER PILES

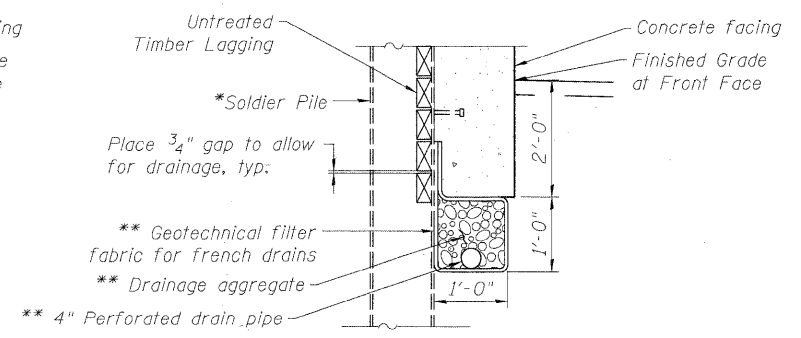

AT SOLDIER PILES

UNDERDRAIN DETAIL FOR SOLDIER PILE WALLS

** Included in the cost of Pipe Underdrains for Structures.

Note: See Sheet No. 56 of 65 for Railing Details.

FILE NAME = P:\AGP\15977\080_CAD\001_Drawings\Sheets\Structural\016-7722_IDDT-sh24-Typical Wall Section.dgn



USFR NAME = dabezicd	DESIGNED - DD	REVISED -
PLOT SCALE = 01.0000 '1' / 1"	DRAWN - DD	REVISED -
PLOT DATE = 2/17/2011	CHECKED - EJO	REVISED -
	DATE - 10/11/2010	REVISED -

**STATE OF ILLINOIS
DEPARTMENT OF TRANSPORTATION**

TYPICAL WALL SECTION

F.A.U. RTE.	SECTION	COUNTY	TOTAL SHEETS	SHEET NO.
1537	06-00050-00-G5	COOK	209	114
CONTRACT NO. 63556			ILLINOIS FED. AID PROJECT	

SCALE: SHEET NO. 24 OF 65 SHEETS STA. TO STA.