

P.A.U. RTE.	SECTION	COUNTY	TOTAL SHEETS	SHEET NO.
559	10-00101-00-LT	COOK	15	1
ILLINOIS		CONTRACT NO. 63563		

STATE OF ILLINOIS
DEPARTMENT OF TRANSPORTATION
DIVISION OF HIGHWAYS

PLANS FOR PROPOSED FEDERAL-AID HIGHWAY

FAU 559 (IL 58, GOLF ROAD)
BASSWOOD ROAD TO I-290
ROADWAY LIGHTING IMPROVEMENT
SECTION 10-00101-00-LT
PROJECT NO. M-9003 (769)
VILLAGE OF SCHAUMBURG
COOK COUNTY

C-91-352-11

INDEX OF SHEETS

SHEET NO.	DESCRIPTION
1.	COVER SHEET
2.	SUMMARY OF QUANTITIES, GENERAL NOTES AND LEGEND
3.	ELECTRIC CIRCUIT MAINTAINED BY VILLAGE OF SCHAUMBURG
4.	PROPOSED ORNAMENTAL LIGHTING
5.	PROPOSED ORNAMENTAL LIGHTING
6.	PROPOSED ORNAMENTAL LIGHTING
7.	PROPOSED ORNAMENTAL LIGHTING
8.	ONE LINE CIRCUIT DIAGRAM LIGHTING CONTROLLER AT COMMONS DRIVE
9.	ONE LINE CIRCUIT DIAGRAM LIGHTING CONTROLLER AT ROOSEVELT DRIVE
10.	ALUMINUM LIGHT POLE (47'-6") M.H.
11.	LIGHT POST FOUNDATION, METAL
12.	OFFSET FOUNDATION
13.	LIGHTING CONTROLLER, CONSOLE TYPE 200 AMP, 240/480 VOLT, 1 PHASE, 3 WIRE
14.	ELECTRIC SERVICE INSTALLATION TRANSFORMER MOUNTED ON PAD
15.	ELECTRICAL DETAILS

LIST OF STANDARDS:

000001-06 SYMBOLS, ABBREVIATIONS, AND PATTERNS
701501-06 URBAN LANE CLOSURE, 2L, 2W, UNDIVIDED
701606-07 URBAN LANE CLOSURE, MULTILANE, 2W WITH MOUNTABLE MEDIAN
701701-07 URBAN LANE CLOSURE, MULTILANE INTERSECTION
701901-01 TRAFFIC CONTROL DEVICES

DESIGN

POSTED SPEED LIMIT - 40 MPH
AVERAGE DAILY TRAFFIC (ADT): 45,900 (2005):
ILLUMINATING ENGINEERING SOCIETY (IES)
ROAD/AREA CLASSIFICATION: MAJOR MEDIUM

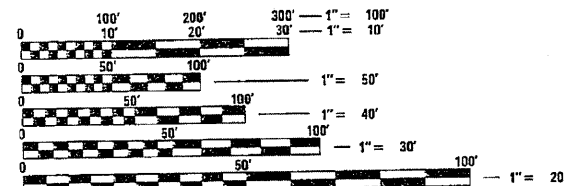

FULL SIZE PLANS HAVE BEEN PREPARED USING STANDARD ENGINEERING SCALES. REDUCED SIZED PLANS WILL NOT CONFORM TO STANDARD SCALES. IN MAKING MEASUREMENTS ON REDUCED PLANS, THE ABOVE SCALES MAY BE USED.

J.U.L.I.E.
JOINT UTILITY LOCATION INFORMATION FOR EXCAVATION
1-800-892-0123
OR 811

CONTRACT NO. 63563

GROSS LENGTH = 10,325 FT. = 1.96 MILE
NET LENGTH = 9075 FT. = 1.72 MILE
OMISSION = 1265 FT. = 0.239 MILE

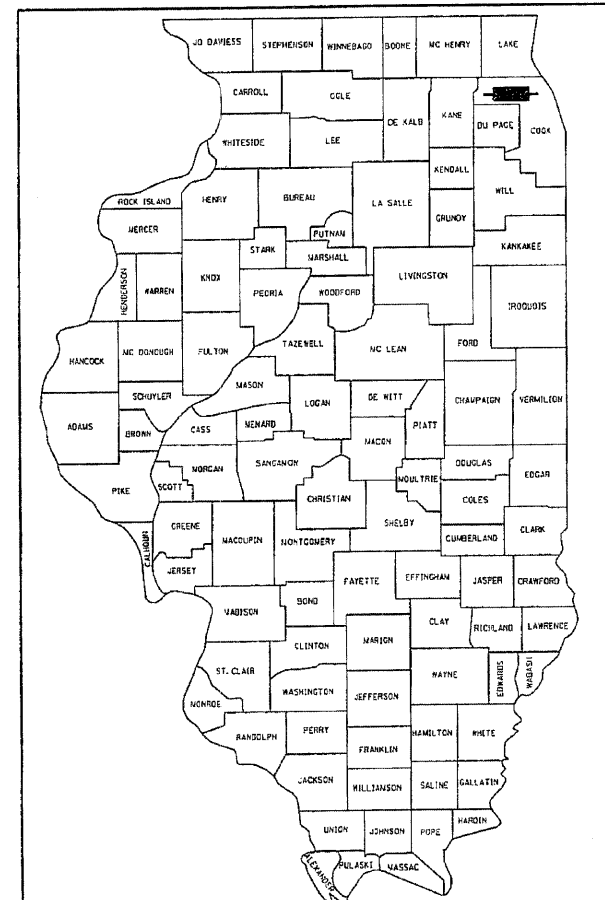

LOCATION OF SECTION INDICATED THUS: - [rectangle] -

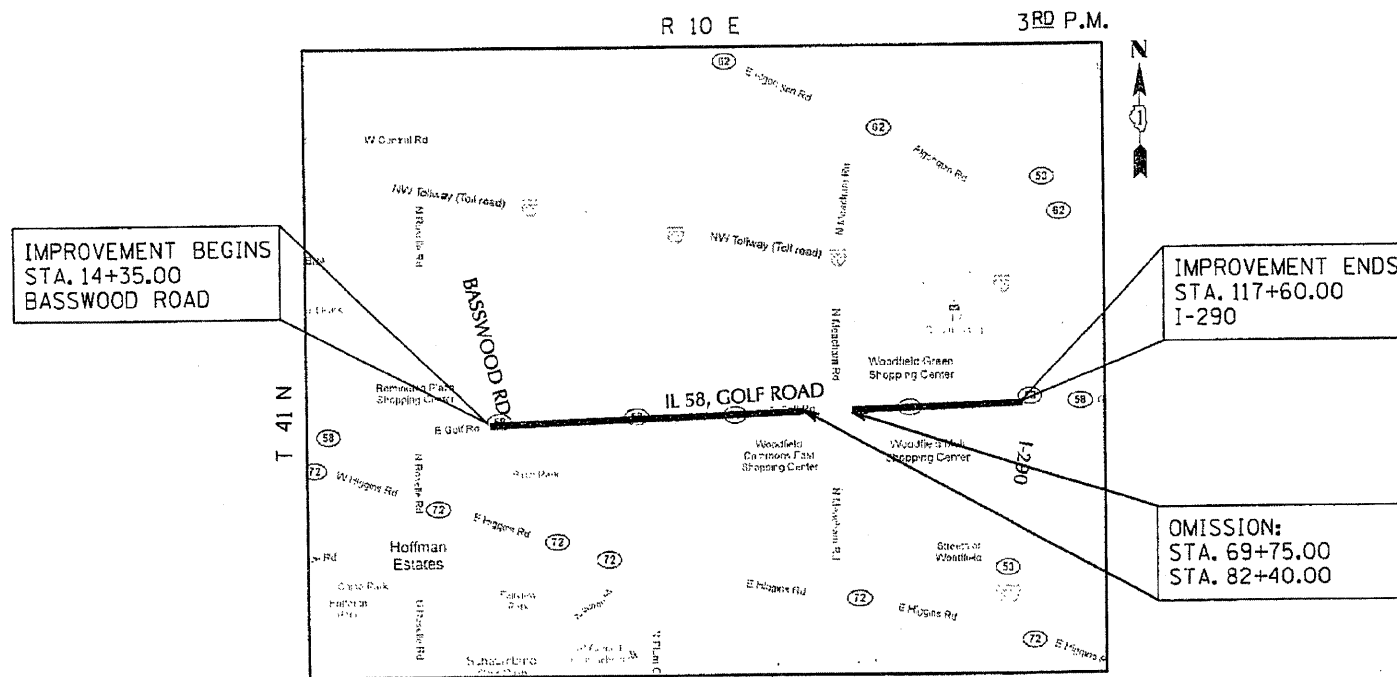

LOCATION MAP
NOT TO SCALE

STATE OF ILLINOIS
DEPARTMENT OF TRANSPORTATION
DIVISION OF HIGHWAYS

APPROVED March 10, 2011
Steven Rubenstein
VILLAGE OF SCHAUMBURG, DIRECTOR OF ENGINEER AND PUBLIC WORKS

PASSED _____ 20____
DISTRICT ONE ENGINEER OF LOCAL ROADS & STREETS

RELEASING FOR BID
BASED ON LIMITED REVIEW MARCH 10, 2011
Diana M. [Signature]
DEPUTY DIRECTOR OF HIGHWAYS, REGION ONE ENGINEER

PRINTED BY THE AUTHORITY
OF THE STATE OF ILLINOIS



212 TIMBERCREST DRIVE SCHAUMBURG, ILLINOIS 60193
TEL: 847-891-5486 - FAX: 847-891-5363
e-mail: sunjoy00@hotmail.com

PROGRAM AND OFFICE ENGINEER: CHARLES F. RIDDLE 847-705-4406, SCHAUMBURG, IL
CONSULTANT ENGINEER: JAGDISH SHAH SUNJOY INC.