

EAST EDGE OF SHOULDER

Location	Station	Offset	Theoretical Grade Elevations
N. End N. Appr. Slab	306+13.33	-16.33	887.63
A1	306+23.33	-16.33	887.74
A2	306+33.33	-16.33	887.82
S. End N. Appr. Slab	306+43.33	-16.33	887.89

EAST EDGE OF PAVEMENT

Location	Station	Offset	Theoretical Grade Elevations
N. End N. Appr. Slab	306+13.33	-12.00	887.72
A1	306+23.33	-12.00	887.83
A2	306+33.33	-12.00	887.91
S. End N. Appr. Slab	306+43.33	-12.00	887.98

Q ROADWAY & PROFILE GRADE

Location	Station	Offset	Theoretical Grade Elevations
N. End N. Appr. Slab	306+13.33	0.00	887.97
A1	306+23.33	0.00	888.08
A2	306+33.33	0.00	888.16
S. End N. Appr. Slab	306+43.33	0.00	888.23

WEST EDGE OF PAVEMENT

Location	Station	Offset	Theoretical Grade Elevations
N. End N. Appr. Slab	306+13.33	12.00	887.72
A1	306+23.33	12.00	887.83
A2	306+33.33	12.00	887.91
S. End N. Appr. Slab	306+43.33	12.00	887.98

WEST EDGE OF SHOULDER

Location	Station	Offset	Theoretical Grade Elevations
N. End N. Appr. Slab	306+13.33	16.33	887.63
A1	306+23.33	16.33	887.74
A2	306+33.33	16.33	887.82
S. End N. Appr. Slab	306+43.33	16.33	887.89

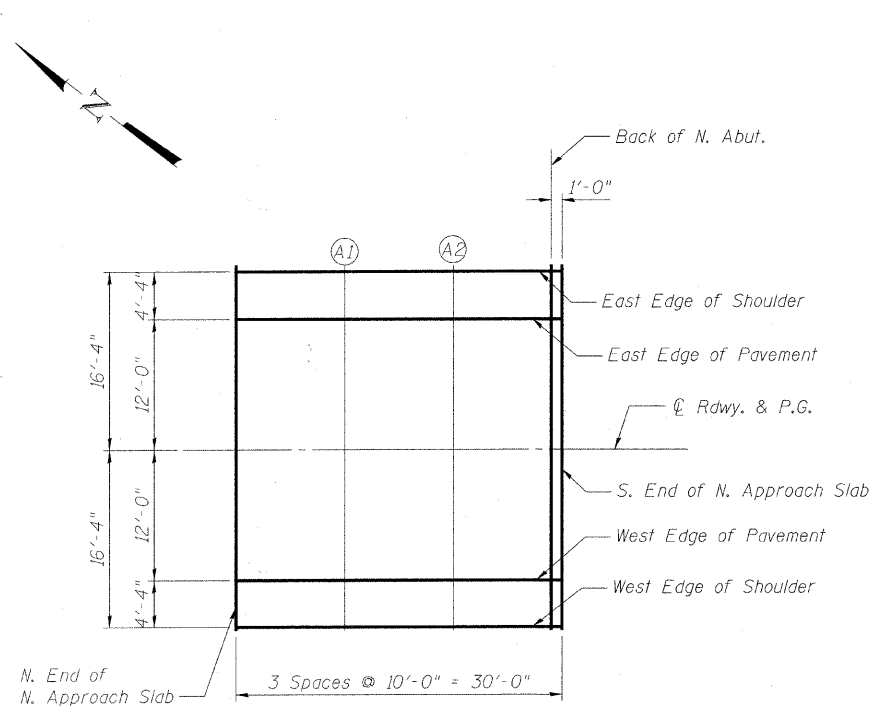

PLAN
North Approach

COPYRIGHT © 2010 BY BAXTER & WOODMAN, INC.
 ALL RIGHTS RESERVED. NO PART OF THIS DOCUMENT MAY BE REPRODUCED OR TRANSMITTED IN ANY FORM OR BY ANY MEANS, ELECTRONIC OR MECHANICAL, INCLUDING PHOTOCOPYING, RECORDING, OR BY ANY INFORMATION STORAGE AND RETRIEVAL SYSTEM.
 LICENSE NO. 184-00121 - EXPIRES 4/30/2011
 2/7/2011 5:28:17 PM
 C:\Mekeno\Projects\07224 - Graf Road Bridges\040-SURF\Drawings\056-3182-Top of North Approach.dwg

FILE NAME =	USER NAME =	DESIGNED - BLB	REVISED - PER MCDOT 12/31/10	MCHENRY COUNTY DIVISION OF TRANSPORTATION GRAF ROAD BRIDGE OVER LAWRENCE CREEK	TOP OF NORTH APPROACH SLAB ELEVATIONS STRUCTURE NO. 056-3182	TR	SECTION	COUNTY	TOTAL	SHEET
		CHECKED - BAB	REVISED -			0037	06-00322-00-BR	MCHENRY	54	32
PLOT SCALE =		DRAWN - BCD	REVISED -			C-91-358-06		CONTRACT NO. 63569		
PLOT DATE =		CHECKED - BLB	REVISED -			SHEET NO. 9 OF 19 SHEETS		FED. ROAD DIST. NO. 1 ILLINOIS FED. AID PROJECT		BROS-0001(683)