

F.A.P. RTE.	SECTION	COUNTY	TOTAL SHEETS	SHEET NO.
642	(10BR-3)M	JODAVIESS	12	1
		ILLINOIS	CONTRACT NO. 64G90	

\* 12 + 1 = 13

STATE OF ILLINOIS  
DEPARTMENT OF TRANSPORTATION  
DIVISION OF HIGHWAYS

**PROPOSED  
HIGHWAY PLANS**

FAP ROUTE 642 (IL 78)  
SECTION (10BR-3)M

BRIDGE REPAIRS  
JODAVIESS COUNTY

C-92-073-11

FOR INDEX OF SHEETS, SEE SHEET NO. 2

Project Location  
Structure No. 043-0040

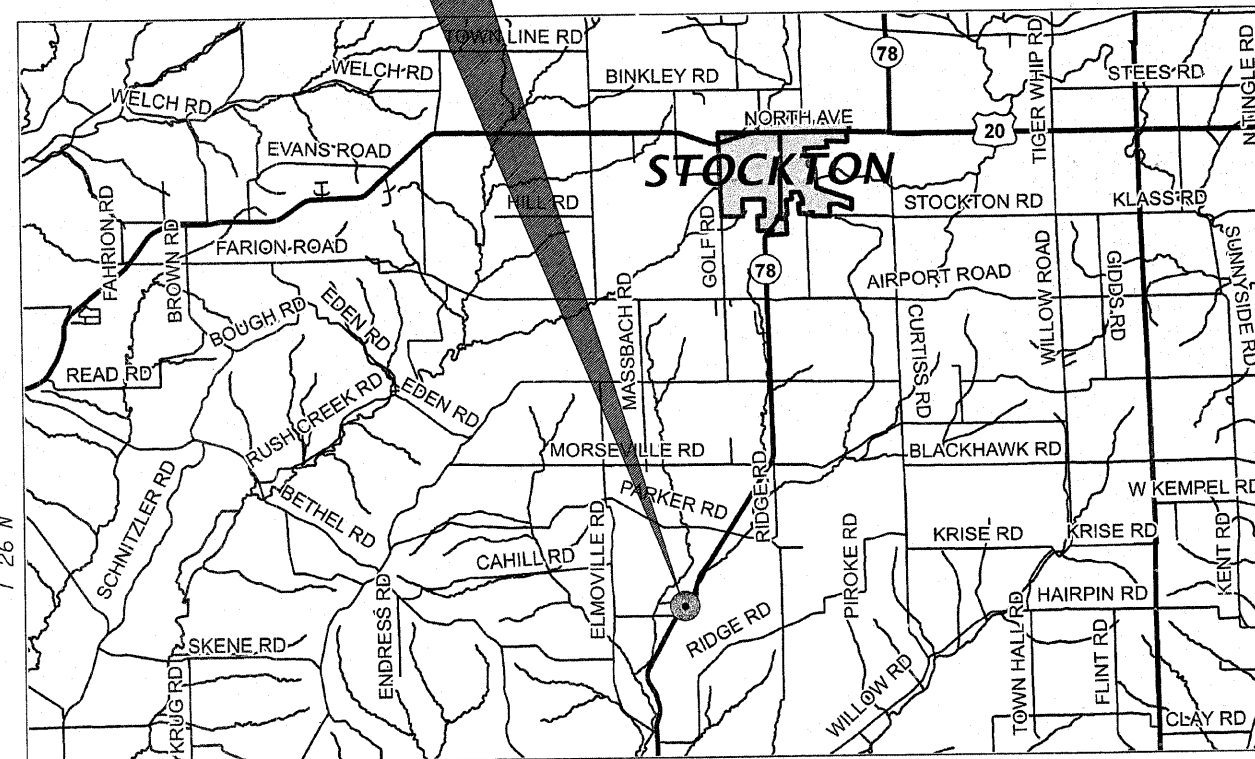

T 26 N

R 4 E

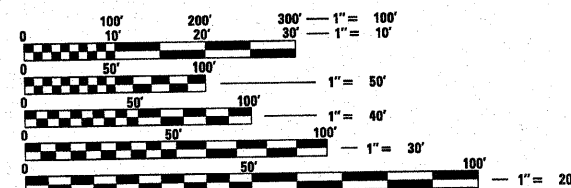

FULL SIZE PLANS HAVE BEEN PREPARED USING STANDARD ENGINEERING SCALES. REDUCED SIZED PLANS WILL NOT CONFORM TO STANDARD SCALES. IN MAKING MEASUREMENTS ON REDUCED PLANS, THE ABOVE SCALES MAY BE USED.

J.U.L.E.  
JOINT UTILITY LOCATION INFORMATION FOR EXCAVATION  
1-800-892-0123  
OR 811

BRIDGE MAINTENANCE ENGINEER: Mahmoud Etemadi 815/284-5393  
PLAN TECHNICIAN: Dan Link 815/284-5416  
TOWNSHIPS: Pleasant  
CONTRACT NO. 64G90

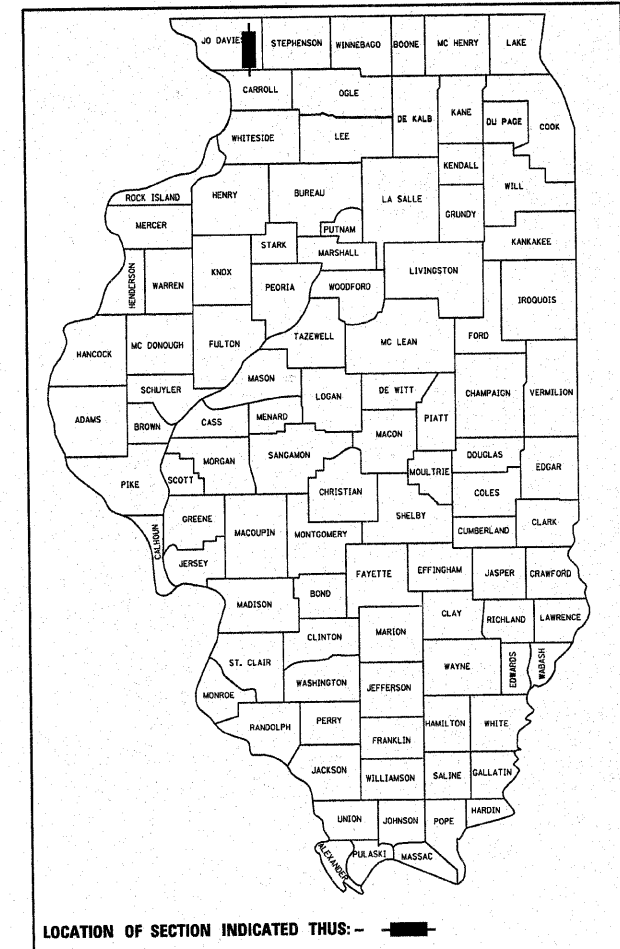

LOCATION OF SECTION INDICATED THIS: - [black rectangle] -

STATE OF ILLINOIS  
DEPARTMENT OF TRANSPORTATION  
DIVISION OF HIGHWAYS

SUBMITTED January 27 2011  
Eric S. Theibildhan  
DEPUTY DIRECTOR OF HIGHWAYS, REGION ENGINEER  
March 25 2011  
Scott E. Stett P.E. Ia  
Acting ENGINEER OF DESIGN AND ENVIRONMENT  
March 25 2011  
Christine M. Reed Ia  
DIRECTOR OF HIGHWAYS, CHIEF ENGINEER

PRINTED BY THE AUTHORITY  
OF THE STATE OF ILLINOIS