

I-57 CURVE DATA:	RAMP "H" CURVE DATAS:	RAMP "E" CURVE DATAS:
PROP. CURVE I57PCL-1 PI STA. = 300+42.42 Δ = 59° 17' 30" (LT) D = 2° 00' 00" R = 2,864.79' T = 1,630.46' L = 2,964.58' E = 431.48' e = 5.44% T.R. = 90' S.E. RUN = 327' P.C. STA. = 284+11.96 P.T. STA. = 313+76.54	PROP. CURVE RMPHPBL-2 PI STA. = 63+79.88 Δ = 12° 44' 31" (RT) D = 2° 03' 46" R = 2,777.66' T = 310.14' L = 617.72' E = 17.26' e = 5.44% T.R. = ----- S.E. RUN = 256' P.C. STA. = 60+69.74 P.T. STA. = 66+87.46	PROP. CURVE RMPHPBL-1 PI STA. = 57+94.32 Δ = 43° 28' 11" (RT) D = 7° 29' 23" R = 765.00' T = 304.97' L = 580.40' E = 58.55' e = 5.44% T.R. = 41' S.E. RUN = 150' P.C. STA. = 54+89.35 P.T. STA. = 60+69.74
	PROP. CURVE RMPEPBL-1 PI STA. = 10+30.37 Δ = 1° 11' 42" (LT) D = 1° 58' 03" R = 2,912.00' T = 30.37' L = 60.73' E = 0.16' e = ----- T.R. = ----- S.E. RUN = ----- P.C. STA. = 10+00.00 P.T. STA. = 10+60.73	PROP. CURVE RMPEPBL-2 PI STA. = 20+15.10 Δ = 33° 23' 43" (RT) D = 7° 29' 23" R = 765.00' T = 229.48' L = 445.89' E = 33.68' e = 8.00% T.R. = ----- S.E. RUN = 256' P.C. STA. = 17+85.63 P.T. STA. = 22+31.51
	PROP. CURVE RMPEPBL-3 PI STA. = 27+08.34 Δ = 35° 56' 45" (LT) D = 11° 14' 04" R = 510.00' T = 165.44' L = 319.96' E = 26.16' e = 6.00% T.R. = 42' (IN) T.R. = 62' (OUT) S.E. RUN = 165' (IN) S.E. RUN = 186' (OUT) P.C. STA. = 25+42.90 P.T. STA. = 28+62.86	

NOTES:

- FOR SURVEY CONTROL POINTS (ASC) LOCATION SEE DRAWING NOS. TB-3 TO TB-5.
- FOR BENCHMARKS SEE DRAWING NO. TB-5.

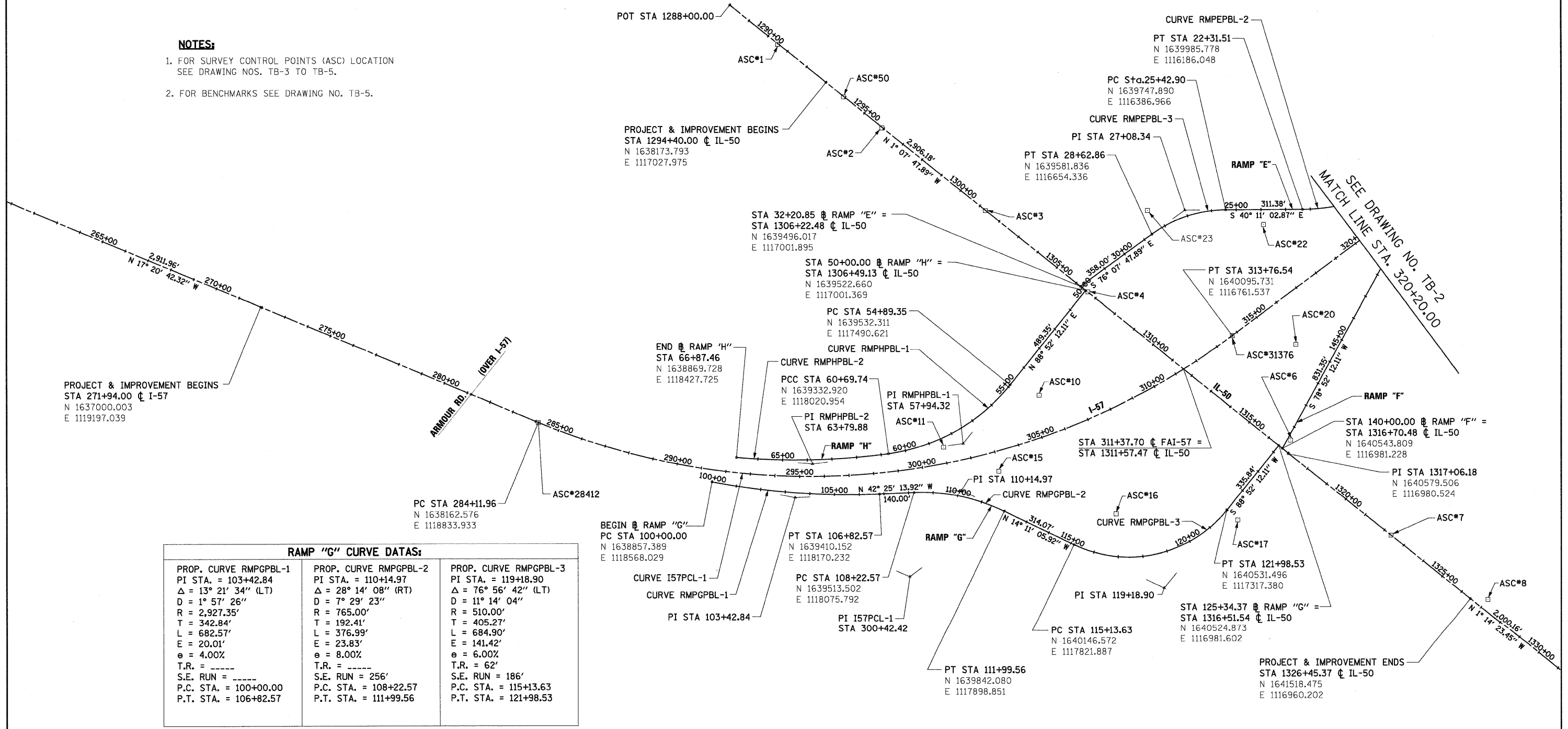

RAMP "G" CURVE DATAS:		
PROP. CURVE RMPGPBL-1 PI STA. = 103+42.84 Δ = 13° 21' 34" (LT) D = 1° 57' 26" R = 2,927.35' T = 342.84' L = 682.57' E = 20.01' e = 4.00% T.R. = ----- S.E. RUN = ----- P.C. STA. = 100+00.00 P.T. STA. = 106+82.57	PROP. CURVE RMPGPBL-2 PI STA. = 110+14.97 Δ = 28° 14' 08" (RT) D = 7° 29' 23" R = 765.00' T = 192.41' L = 376.99' E = 23.83' e = 8.00% T.R. = ----- S.E. RUN = 256' P.C. STA. = 108+22.57 P.T. STA. = 111+99.56	PROP. CURVE RMPGPBL-3 PI STA. = 119+18.90 Δ = 76° 56' 42" (LT) D = 11° 14' 04" R = 510.00' T = 405.27' L = 684.90' E = 141.42' e = 6.00% T.R. = 62' S.E. RUN = 186' P.C. STA. = 115+13.63 P.T. STA. = 121+98.53

FILE NAME = I:\Dgn\sheet\tb001.dgn	USER NAME = EricG	DESIGNED - JTF	REVISED -	STATE OF ILLINOIS DEPARTMENT OF TRANSPORTATION	ALIGNMENT AND TIES			F.A.I. RTE. = 57	SECTION = (46-2) I, HBR, VBR	COUNTY = KANKAKEE	TOTAL SHEETS = 558	SHEET NO. = 38
PLOT SCALE = 1:200	CHECKED - EJG	REVISED -	REVISED -		SCALE:	SHEET NO. OF SHEETS	STA. TO STA.	CONTRACT NO. 66409				
PLOT DATE = 12/22/2010	DATE = 12/17/10	REVISED -	REVISED -		FED. ROAD DIST. NO. 3 ILLINOIS FED. AID PROJECT							