

STA 300+99.68 (I-57) OFFSET 65.04' LT
 STA 58+52.22 (RAMP "H") OFFSET 36.30' LT
 NORTHING : 1639487.374
 EASTING : 1117857.576
 ELEVATION : 682.36

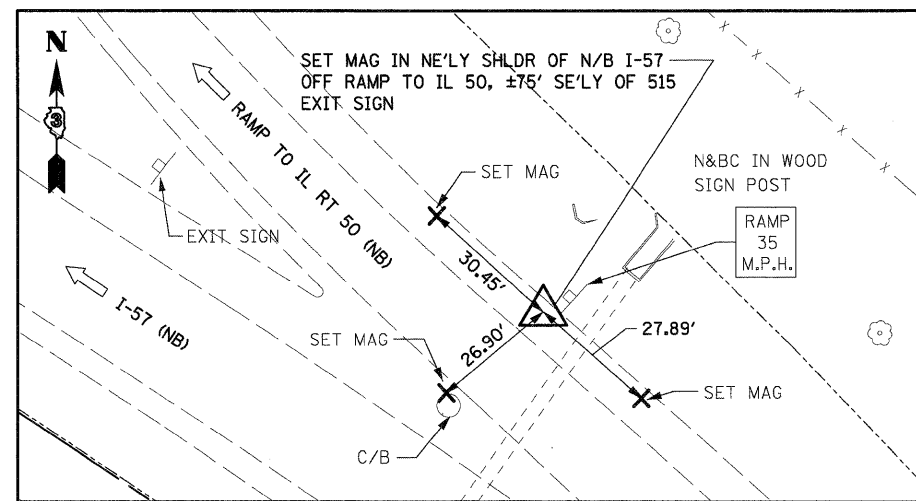

STA 302+95.17 (I-57) OFFSET 80.43' RT
 STA 111+23.50 (RAMP "G") OFFSET 141.21' LT
 NORTHING : 1639721.368
 EASTING : 1117788.331
 ELEVATION : 687.33

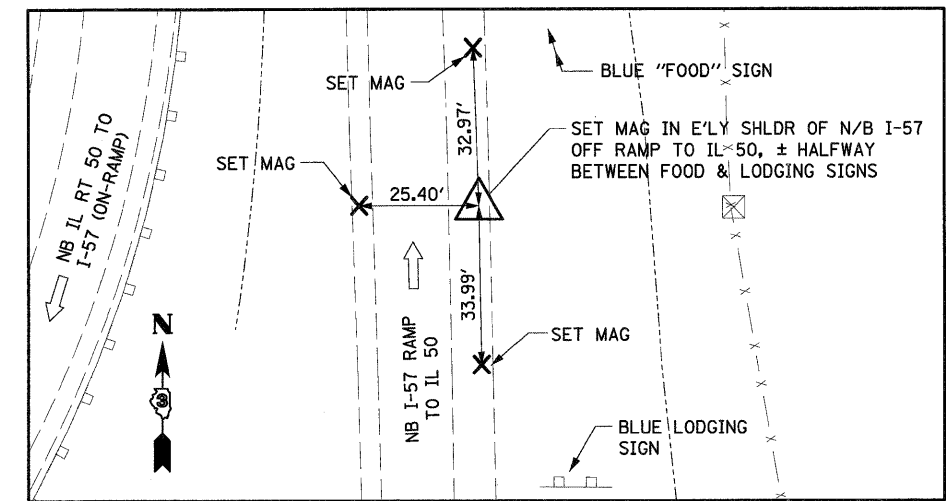

STA 116+65.86 (RAMP "G") OFFSET 171.54' LT
 NORTHING : 1640197.367
 EASTING : 1117616.676
 ELEVATION : 691.39

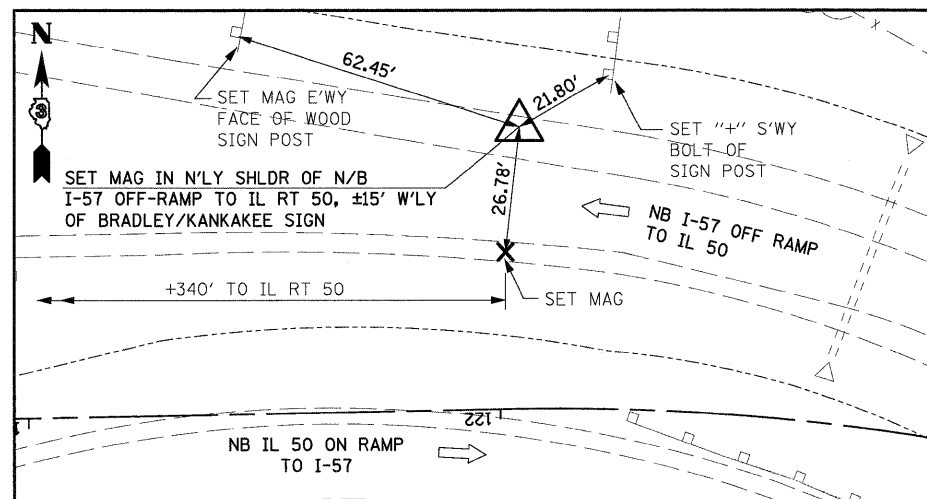

STA 121+95.15 (RAMP "G") OFFSET 59.76' RT
 NORTHING : 1640591.303
 EASTING : 1117319.978
 ELEVATION : 686.70

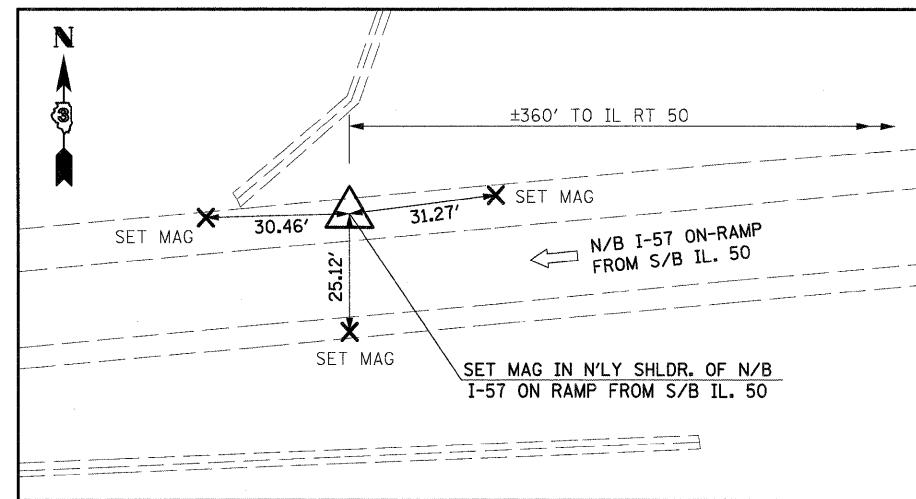

STA 315+61.62 (I-57) OFFSET 182.58' RT
 STA 143+94.78 (RAMP "F") OFFSET 154.36' LT
 NORTHING : 1640316.145
 EASTING : 1116623.673
 ELEVATION : 698.84

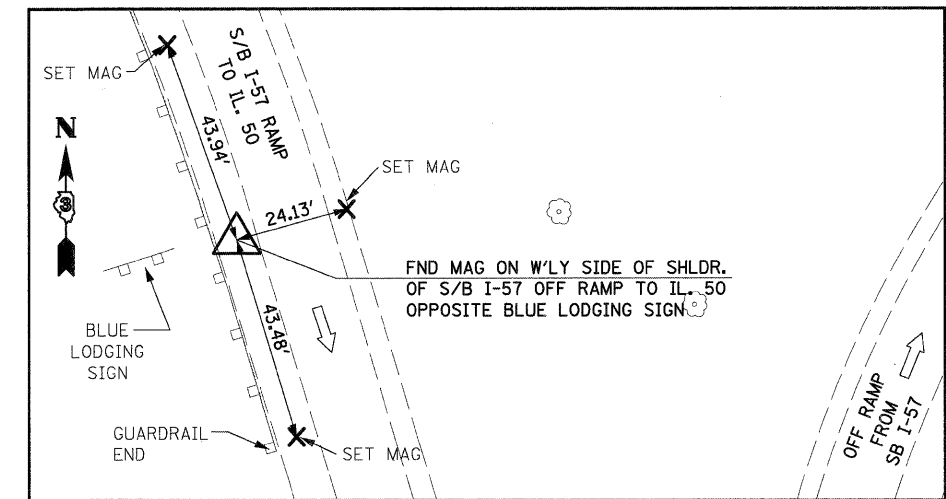

STA 23+89.83 (RAMP "E") OFFSET 60.55' LT
 NORTHING : 1639903.900
 EASTING : 1116334.460
 ELEVATION : 703.60

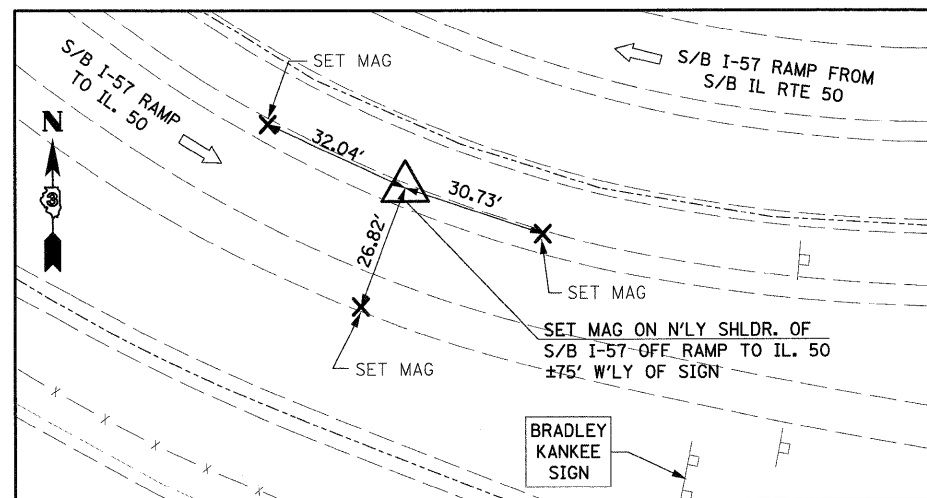

STA 28+26.57 (RAMP "E") OFFSET 89.51' RT
 NORTHING : 1639506.621
 EASTING : 1116591.863
 ELEVATION : 689.15

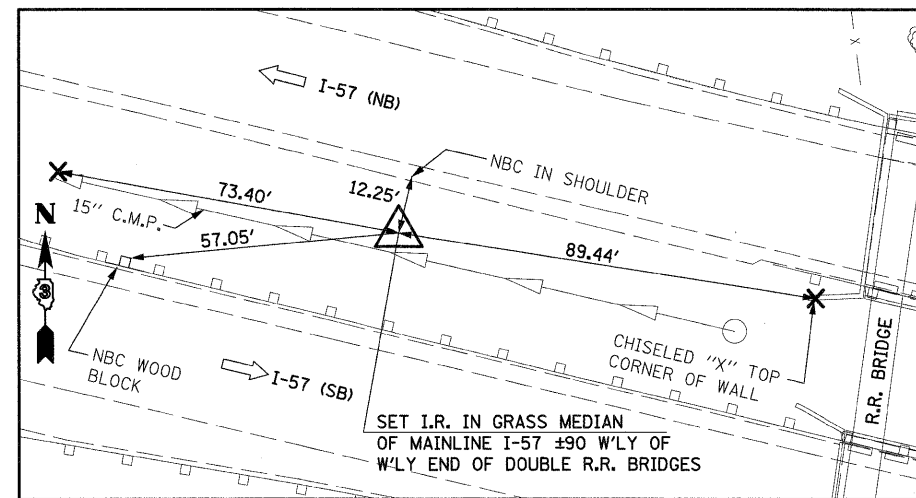

STA 327+81.84 (I-57) OFFSET 4.65' RT
 NORTHING : 1640425.052
 EASTING : 1115395.362
 ELEVATION : 705.90

FILE NAME = I:\Dgn\sheets\1b\204.dgn

USER NAME = EricG	DESIGNED - JTF	REVISED -
PLCT SCALE = 1:20	DRAWN - JTF	REVISED -
PLOT DATE = 12/22/2010	CHECKED - EJG	REVISED -
	DATE - 12/17/10	REVISED -

STATE OF ILLINOIS
 DEPARTMENT OF TRANSPORTATION

ALIGNMENT, TIES AND BENCHMARKS

SCALE: SHEET NO. OF SHEETS STA. TO STA.

F.A.I. RTE.	SECTION	COUNTY	TOTAL SHEETS	SHEET NO.
57	(46-2) I, HBR, VBR	KANKAKEE	558	41
CONTRACT NO. 66409				
FED. ROAD DIST. NO. 3 ILLINOIS FED. AID PROJECT				