

DRAINAGE REMOVALS

STORM SEWER REMOVAL 24"					TRENCH BACKFILL	
FROM STATION	OFFSET	TO STATION	OFFSET	QUANTITY FOOT	QUANTITY CU YD	
337+99.4	11.7 LT	337+99.4	73.2 LT	61.5	16.0	
				TOTAL	61.5	16.0

EXISTING DRAINAGE LEGEND

[R] DRAINAGE STRUCTURE REMOVAL
 [F] DRAINAGE STRUCTURE TO BE FILLED
 NOTE: **XXX** DRAINAGE PIPE OR PAVED DITCH REMOVAL
 REMOVAL OF EXISTING END SECTIONS AND CONCRETE HEADWALLS SHALL NOT BE MEASURE FOR PAYMENT, BUT SHALL BE CONSIDERED INCIDENTAL TO THE COST OF REM. OF STORM SEWERS & CULVERTS.

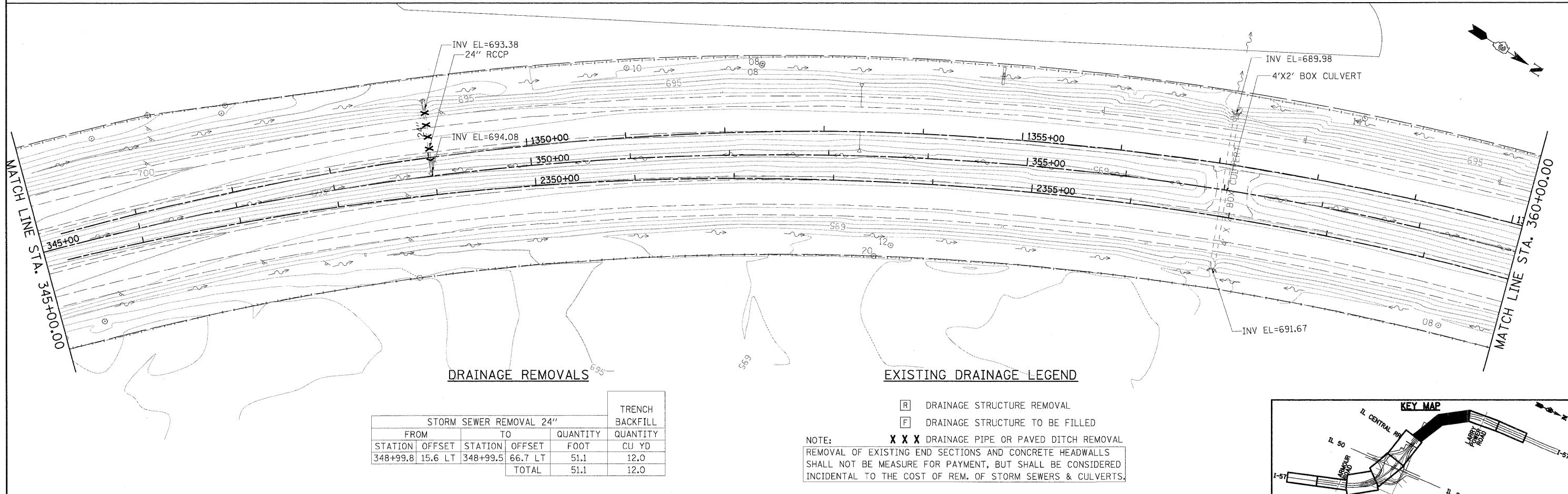

DRAINAGE REMOVALS

STORM SEWER REMOVAL 24"					TRENCH BACKFILL	
FROM STATION	OFFSET	TO STATION	OFFSET	QUANTITY FOOT	QUANTITY CU YD	
348+99.8	15.6 LT	348+99.5	66.7 LT	51.1	12.0	
				TOTAL	51.1	12.0

EXISTING DRAINAGE LEGEND

[R] DRAINAGE STRUCTURE REMOVAL
 [F] DRAINAGE STRUCTURE TO BE FILLED
 NOTE: **XXX** DRAINAGE PIPE OR PAVED DITCH REMOVAL
 REMOVAL OF EXISTING END SECTIONS AND CONCRETE HEADWALLS SHALL NOT BE MEASURE FOR PAYMENT, BUT SHALL BE CONSIDERED INCIDENTAL TO THE COST OF REM. OF STORM SEWERS & CULVERTS.

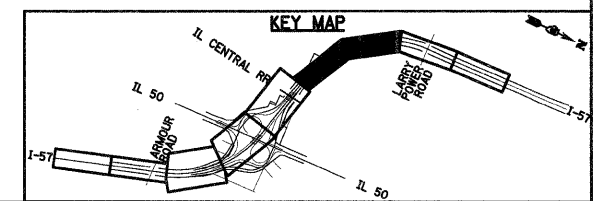

FILE NAME = I:\Dgn\sheeta\dl05.dgn	USER NAME = Er10G	DESIGNED - JWM	REVISED -	STATE OF ILLINOIS DEPARTMENT OF TRANSPORTATION	EXISTING DRAINAGE AND UTILITY PLAN			F.A.I. RTE. 57	SECTION (46-2) I, HBR, VBR	COUNTY KANKAKEE	TOTAL SHEETS 558	SHEET NO. 137			
	PLOT SCALE = 1:500	DRAWN - JWM	REVISED -					SCALE:	SHEET NO. OF SHEETS	STA. TO STA.	FED. ROAD DIST. NO. 3 ILLINOIS FED. AID PROJECT				
	PLOT DATE = 12/22/2010	CHECKED - EJG	REVISED -					CONTRACT NO. 66409							
		DATE - 12/17/10	REVISED -												