

TEMPORARY CABLE DIAGRAM LEGEND:

- TEMPORARY TRAFFIC SIGNAL SECTION OR PEDESTRIAN SIGNAL SECTION 12" (300 mm)
- TEMPORARY CONTROLLER CABINET
- TEMPORARY SERVICE INSTALLATION
- INDICATES NUMBER OF CONDUCTORS IN CABLE. ALL CONDUCTORS TO BE NUMBER 14 AWG WIRE UNLESS OTHERWISE NOTED.
- 5
- EMERGENCY VEHICLE LIGHT DETECTOR
- CONFIRMATION BEACON
- PEDESTRIAN PUSHBUTTON DETECTOR
- VEHICLE DETECTOR, INDUCTION LOOP
- 12" TEMPORARY PEDESTRIAN SIGNAL HEAD
- VIDEO DETECTION CAMERA
- TEMPORARY BATTERY BACK-UP UPS SYSTEM

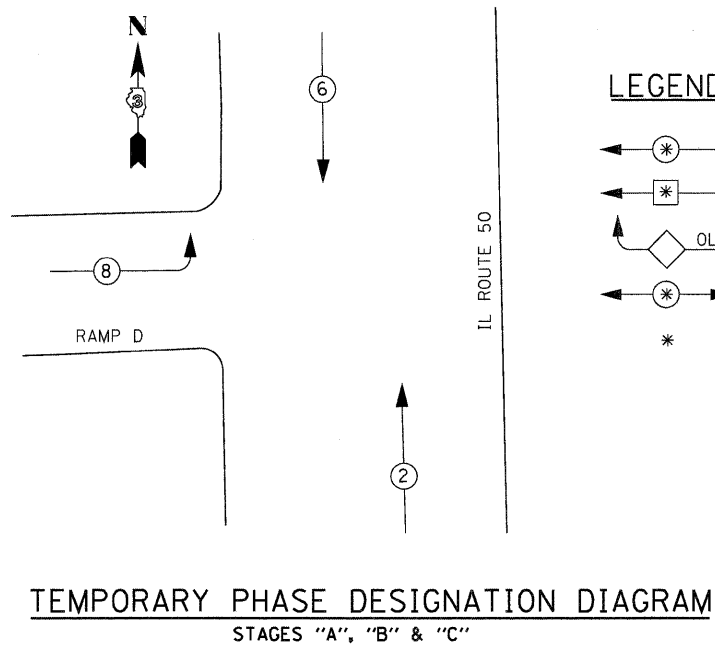

- LEGEND:**
- DUAL ENTRY PHASE
 - SINGLE ENTRY PHASE
 - OVER LAP
 - PEDESTRIAN PHASE
 - * NUMBER REFERS TO ASSOCIATED PHASE

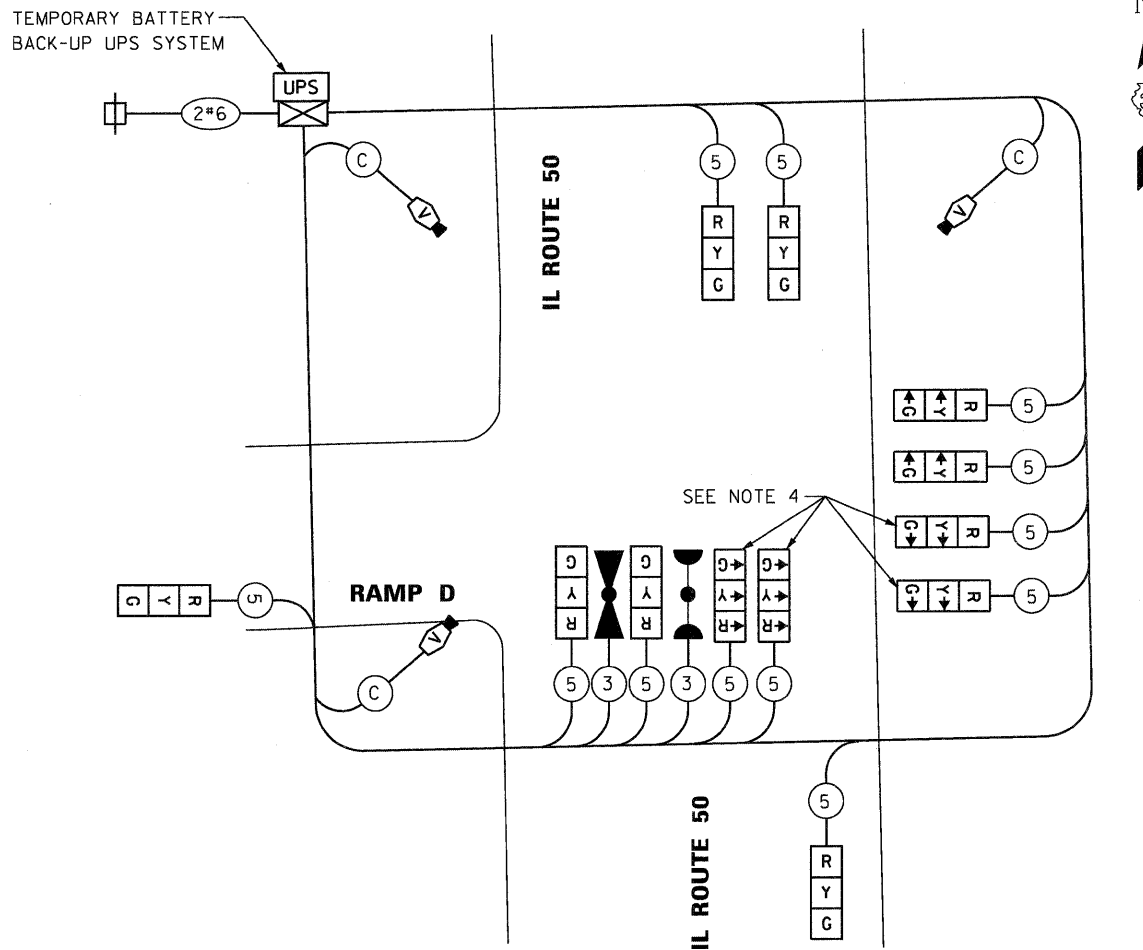

CONSTRUCTION NOTES:

- THE EXISTING TRAFFIC RESPONSIVE CLOSED LOOP SYSTEM OPERATION SHALL BE MAINTAINED DURING CONSTRUCTION. THE CONTRACTOR SHALL CONTACT THE SIGNAL SYSTEM ENGINEER, OF DISTRICT 3 AT LEAST 72 HOURS PRIOR TO THE START OF WORK TO REQUEST MODIFICATION OF THE EXISTING TRAFFIC RESPONSIVE PROGRAM. UPON COMPLETION AND ACCEPTANCE OF THE TRAFFIC SIGNAL MODIFICATIONS, THE CONTRACTOR SHALL CONTACT THE SIGNAL SYSTEM ENGINEER TO REQUEST RESTORATION OF THE ORIGINAL TRAFFIC RESPONSIVE PROGRAM.
- THE CONTRACTOR SHALL MAINTAIN THE EXISTING SIGNAL SYSTEM INTERCONNECT DURING TEMPORARY SIGNAL OPERATION. THE INSTALLATION OF THE TEMPORARY INTERCONNECT CABLE SHALL BE NON-DESTRUCTIVE. THE INSTALLATION AND MAINTENANCE OF THE TEMPORARY INTERCONNECT CABLE SHALL BE INCIDENTAL TO THE COST OF TEMPORARY TRAFFIC SIGNAL INSTALLATION.
- THE EMERGENCY VEHICLE PREEMPTION SEQUENCE SHALL BE MODIFIED AS REQUIRED DURING CONSTRUCTION STAGING.
- THIS TRAFFIC SIGNAL SECTIONS SHALL BE DEACTIVATED AND BAGGED DURING STAGE "A, B & C" AND AS REQUIRED DURING CONSTRUCTION STAGING. THE TRAFFIC SECTIONS SHALL BE UNBAGGED AT THE END OF STAGE "C" CONSTRUCTION.
- THE SIGN SHALL BE BAGGED DURING STAGE "A, B & C" AND AS REQUIRED DURING CONSTRUCTION STAGING. THE SIGN SHALL BE UNBAGGED AT THE END OF CONSTRUCTION "C" CONSTRUCTION.
- TEMPORARY SIGNAL HEADS SHALL BE L.E.D.

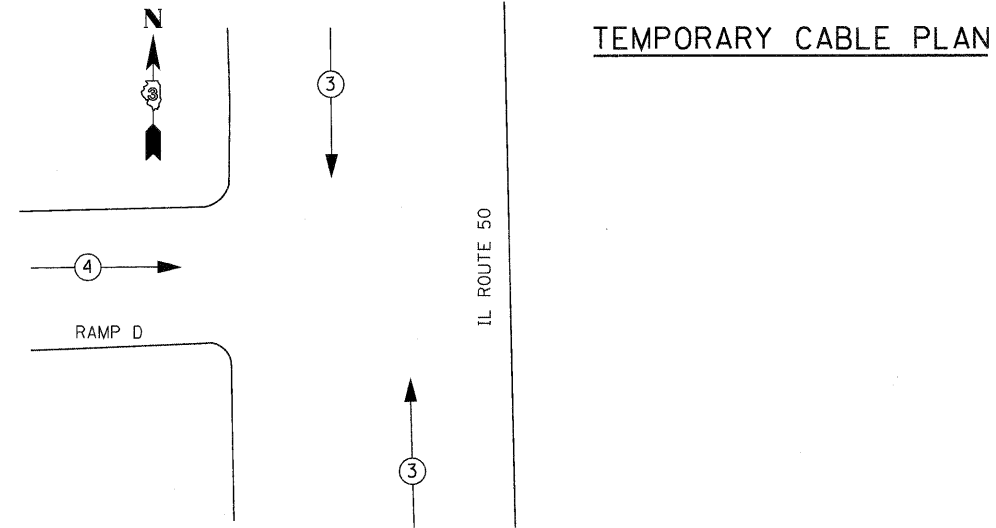
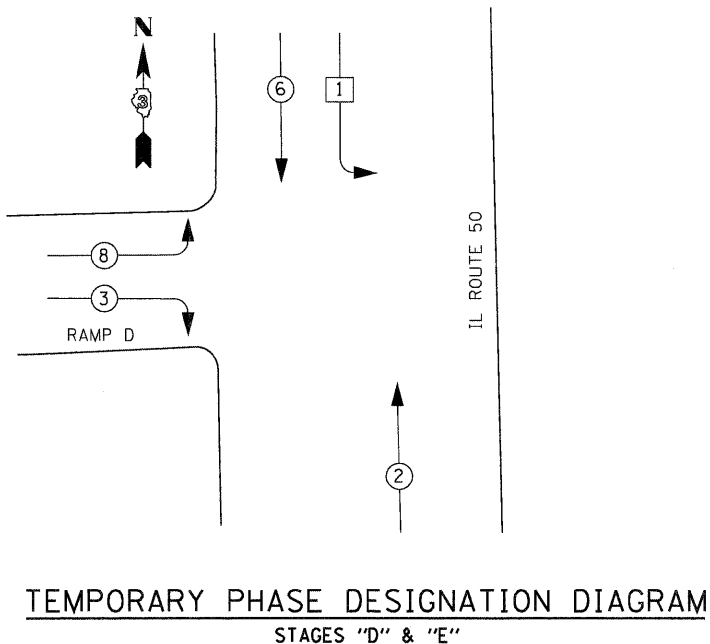

| I.D.O.T TRAFFIC SIGNAL INSTALLATION ELECTRICAL SERVICE REQUIREMENTS | | | | | TOTAL WATTAGE |
|---|-----------|---------|-----|------------|------------------|
| TYPE | NO. LAMPS | WATTAGE | | %OPERATION | |
| | | INCAND. | LED | | |
| SIGNAL (RED) | 10 | | 17 | 0.50 | 85.0 |
| (YELLOW) | 10 | | 12 | 0.25 | 30.0 |
| (GREEN) | 10 | | 12 | 0.25 | 30.0 |
| ARROW | 6 | | 8 | 0.10 | 4.80 |
| CONTROLLER | 1 | | 100 | 1.00 | 100.0 |
| FLASHER | | | | | 0.50 |
| ENERGY COSTS TO: | | | | | TOTAL = 249.80 |
| XXXXXXXXXXXXXXXXXXXX | | | | | |
| ENERGY SUPPLY CONTACT: XXXXXX | | | | | |
| PHONE: XXXXXX | | | | | |
| COMPANY: COM. EDISON | | | | | |

| FOUNDATION (DEPTH) | FT. (m) | CABLE SLACK | FT. (m) | VERTICAL | FT. (m) |
|--------------------|----------|------------------|-----------|-------------------|-----------------------|
| TYPE A - POST | 4 (1.2) | HANDHOLE | 6.5 (2.0) | ALL FOUNDATIONS | 3.5 (1.0) |
| D - CONTROLLER | 4 (1.2) | DOUBLE HANDHOLE | 13 (4.0) | MAST ARM (L) POLE | 20'+L-2'=(6m+L-0.6m)= |
| E - M. ARM POLE | | SIGNAL POST | 2 (0.6) | BRACKET MOUNTED | 13 (4.0) |
| 24" (600mm) | 10 (3.0) | CONTROLLER CAB. | 1 (0.5) | PED. PUSHBUTTON | 4 (1.2) |
| 30" (750mm) | 15 (4.6) | FIBER OPTIC | 13 (4.0) | ELECTRIC SERVICE | 13.5 (4.1) |
| | | ELECTRIC SERVICE | 1 (0.5) | SERVICE TO GROUND | 13.5 (4.1) |
| | | GROUND CABLE | 1 (0.5) | POST MOUNTED | 6 (1.8) |

| | | | | | | | | | | | | |
|---------------------------------|-------------------|---------------|--------------------|---|--|---------------------|----------------------------|---|------------------|---------------|--|--|
| FILE NAME = g:\z\48483\ts-5.dgn | USER NAME = kkhan | DESIGNED - JA | REVISED - | STATE OF ILLINOIS DEPARTMENT OF TRANSPORTATION | TRAFFIC SIGNAL TEMPORARY CABLE PLAN & PHASE DESIGNATION DIAGRAM-RAMP EH & IL 50 | F.A.I. RTE. 57 | SECTION (46-2) 1, HBR, VBR | COUNTY KANKAKEE | TOTAL SHEETS 558 | SHEET NO. 230 | | |
| PLOT SCALE = NONE | CHECKED - HS | REVISIONS | SCALE: | | | SHEET NO. OF SHEETS | STA. TO STA. | FED. ROAD DIST. NO. 3 ILLINOIS FED. AID PROJECT | | | | |
| PLOT DATE = 12/17/2010 | DATE - 12-17-2010 | REVISIONS | CONTRACT NO. 66409 | | | | | | | | | |
| TS-5 | | | | | | | | | | | | |

Delta Engineering, Inc.
 CONSULTING ENGINEERS, CONSTRUCTION MANAGERS, SURVEYORS
 111 West Jackson Blvd. Suite 910 Chicago, IL 60604-2001