

STATE OF ILLINOIS
DEPARTMENT OF TRANSPORTATION

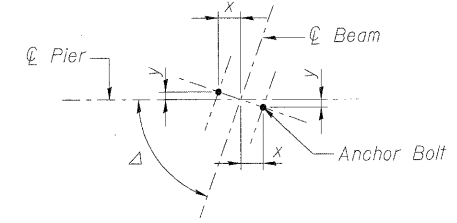

Beam No.	Δ	x	y
10	70°36'19.7"	7'8"	2'2"
11 thru 17	70°43'48"	7'8"	2'2"
18	70°1'55.6"	7'8"	2'2"

DETAIL "I"
ANCHOR BOLT LAYOUT

PIER 2 BILL OF MATERIAL

Bar	Stage 1	Stage 2	Stage 3	Size	Length	Shape
h ₁ (E)		6	6	#9	41'-1"	—
h ₂ (E)	16			#6	40'-9"	—
h ₃ (E)	6			#9	40'-9"	—
h ₈ (E)		16	16	#6	41'-1"	—
h ₉ (E)		12	12	#5	25'-1"	—
h ₁₀ (E)	6			#5	21'-3"	—
h ₁₁ (E)	6			#5	19'-1"	—
n ₄ (E)		40		#10	15'-1"	—
n ₅ (E)	20	20		#10	17'-3"	—
n ₆ (E)	20		20	#10	17'-10"	—
n ₇ (E)			40	#10	19'-7"	—
p ₃₅ (E)		9		#11	18'-8"	—
p ₄₃ (E)		8		#11	41'-4"	—
p ₄₄ (E)			9	#11	48'-3"	—
p ₄₅ (E)			8	#11	41'-9"	—
p ₄₆ (E)	16			#11	12'-1"	—
p ₄₇ (E)	18			#11	23'-3"	—
p ₄₈ (E)	18			#11	21'-1"	—
p ₄₉ (E)		8		#11	18'-11"	—
p ₅₀ (E)			8	#11	18'-1"	—
p ₅₁ (E)	8			#11	22'-9"	—
p ₅₂ (E)	8			#11	20'-6"	—
s ₅ (E)	28	24		#4	7'-8"	—
s ₆ (E)	42	43	43	#6	12'-10"	—
s ₇ (E)	42	43	43	#6	17'-2"	—
s ₈ (E)	16	24	24	#4	7'-10"	—
s ₉ (E)	22	24	46	#4	9'-2"	—
s ₁₀ (E)	68	112	114	#5	10'-7"	—
s ₁₁ (E)	32	24	20	#4	8'-2"	—
s ₁₂ (E)	80		24	#4	8'-10"	—
s ₁₃ (E)			2	#4	11'-8"	—
t(E)	42	44	44	#7	9'-8"	—
u ₁ (E)	6	12	12	#6	9'-4"	—
w(F)		11	11	#6	42'-1"	—
w ₁ (E)	11			#7	40'-9"	—
Braced Excavation				Cu. Yd.	868	
Reinforcement Bars, Epoxy Coated				Pound	51,710	
Concrete Structures				Cu. Yd.	291	

BARS s₅(E), s₆(E), s₇(E), s₈(E) & s₉(E)

A & B DIMENSIONS

Bar	A	B
s ₅ (E)	2'-10"	2'-5"
s ₆ (E)	2'-10"	5'-0"
s ₇ (E)	2'-10"	7'-2"
s ₈ (E)	2'-6"	2'-8"
s ₉ (E)	2'-6"	3'-4"
s ₁₁ (E)	2'-10"	2'-8"
s ₁₂ (E)	2'-10"	3'-0"
s ₁₃ (E)	2'-6"	4'-7"

BARS p₄₉(E), p₅₀(E), p₅₁(E) & p₅₂(E)

X & Y DIMENSIONS

Bar	X	Y
p ₄₉ (E)	5'-3 ³ / ₈ "	5'-4"
p ₅₀ (E)	4'-5 ¹ / ₄ "	4'-6"
p ₅₁ (E)	9'-1 ⁵ / ₈ "	9'-2"
p ₅₂ (E)	6'-10 ¹ / ₂ "	6'-11"

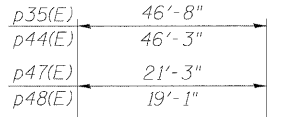

BARS p₃₅(E), p₄₄(E), p₄₇(E) & p₄₈(E)

BARS n₄(E), n₅(E), n₆(E) & n₇(E)

C DIMENSIONS

Bar	C
n ₄ (E)	13'-8"
n ₅ (E)	15'-10"
n ₆ (E)	16'-5"
n ₇ (E)	18'-2"

PIER 2 (NB)

STRUCTURE NO. 046-0144 (S.B.)
& STRUCTURE NO. 046-0145 (N.B.)

SHEET NO.	F.A.I. RTE.	SECTION	COUNTY	TOTAL SHEETS	SHEET NO.
SH-46	57	(46-2) HBR	KANKAKEE	558	317
SH-56					
CONTRACT NO. 66409					
FED. ROAD DIST. NO. 3 ILLINOIS FED. AID PROJECT					

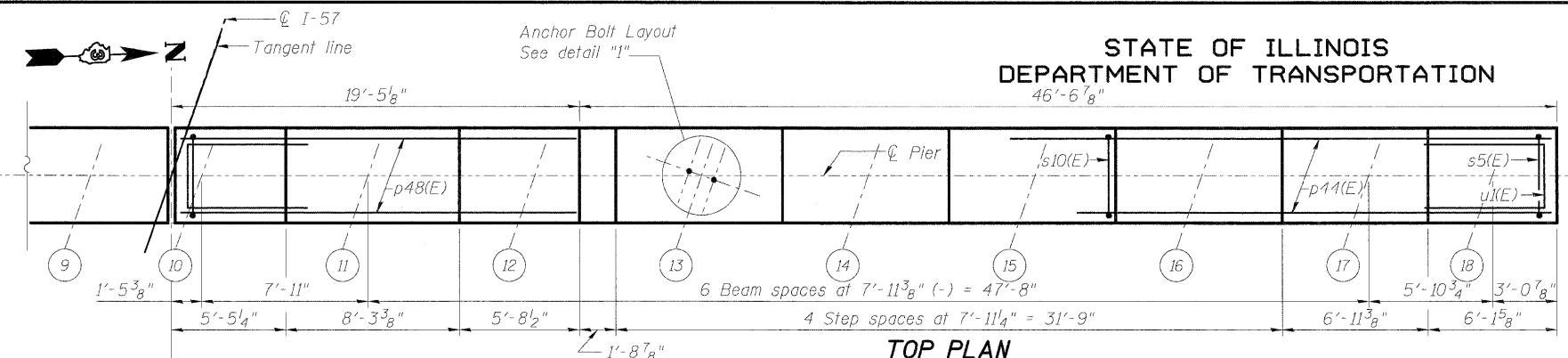

TOP PLAN

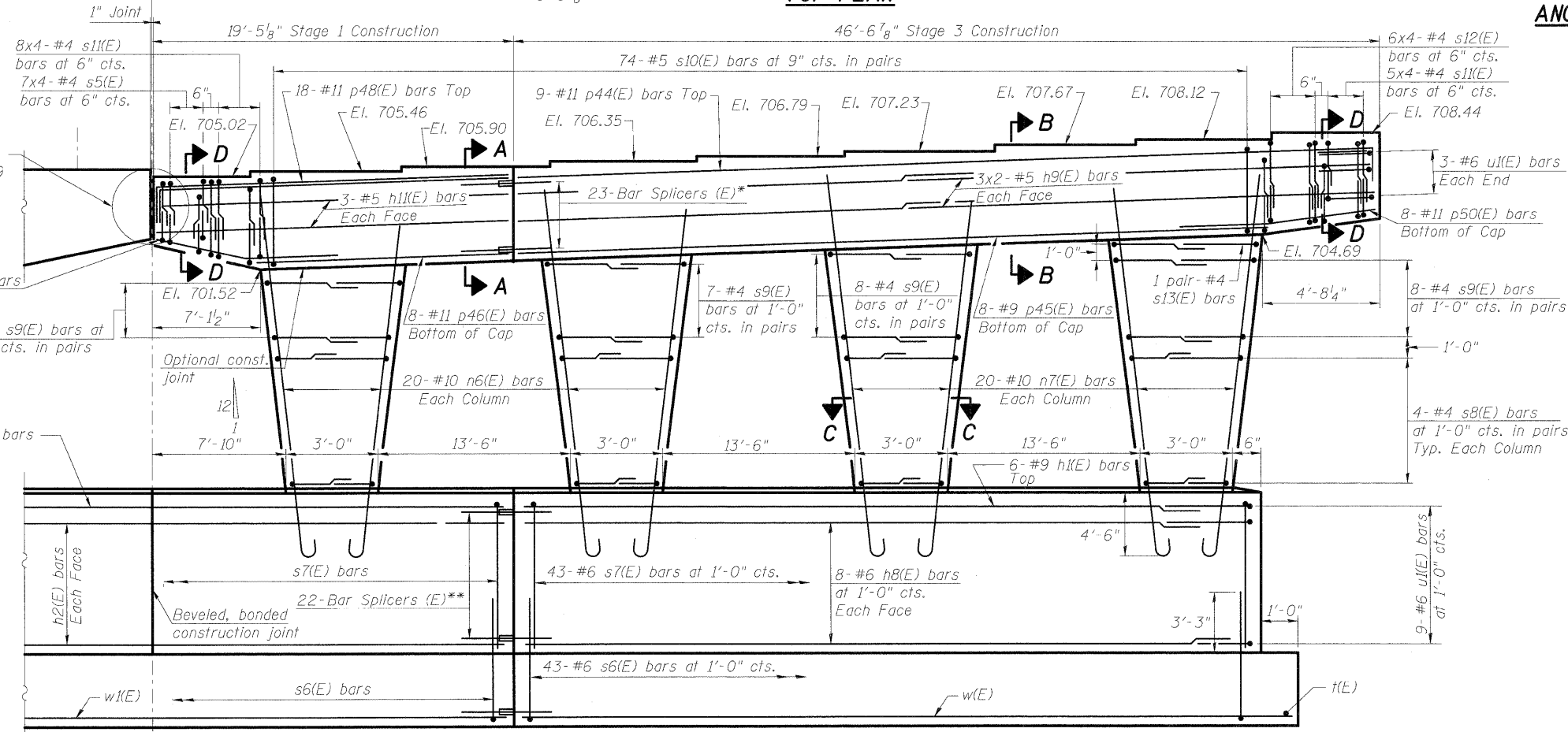

ELEVATION
(Looking West)

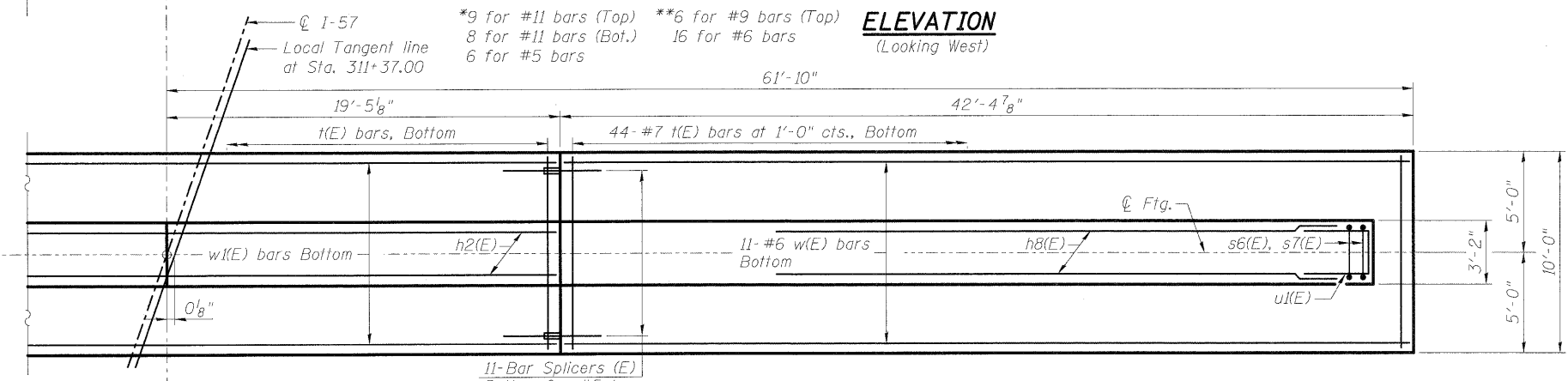

FOOTING PLAN

Maximum Applied Service Bearing Pressure = 3.53 ksf

Notes:
Space reinforcement in cap to miss anchor bolts.
Pour steps monolithically with cap.
For Sections A-A, B-B, C-C and D-D and End View see sheet SH-45.

McDonough Associates Inc.
Engineers / Architects
130 East Randolph Street
Chicago, Illinois 60601
(312) 946-8600

DESIGNED	PMH
CHECKED	MGB
DRAWN	PMH
CHECKED	MJL