

STATE OF ILLINOIS
DEPARTMENT OF TRANSPORTATION

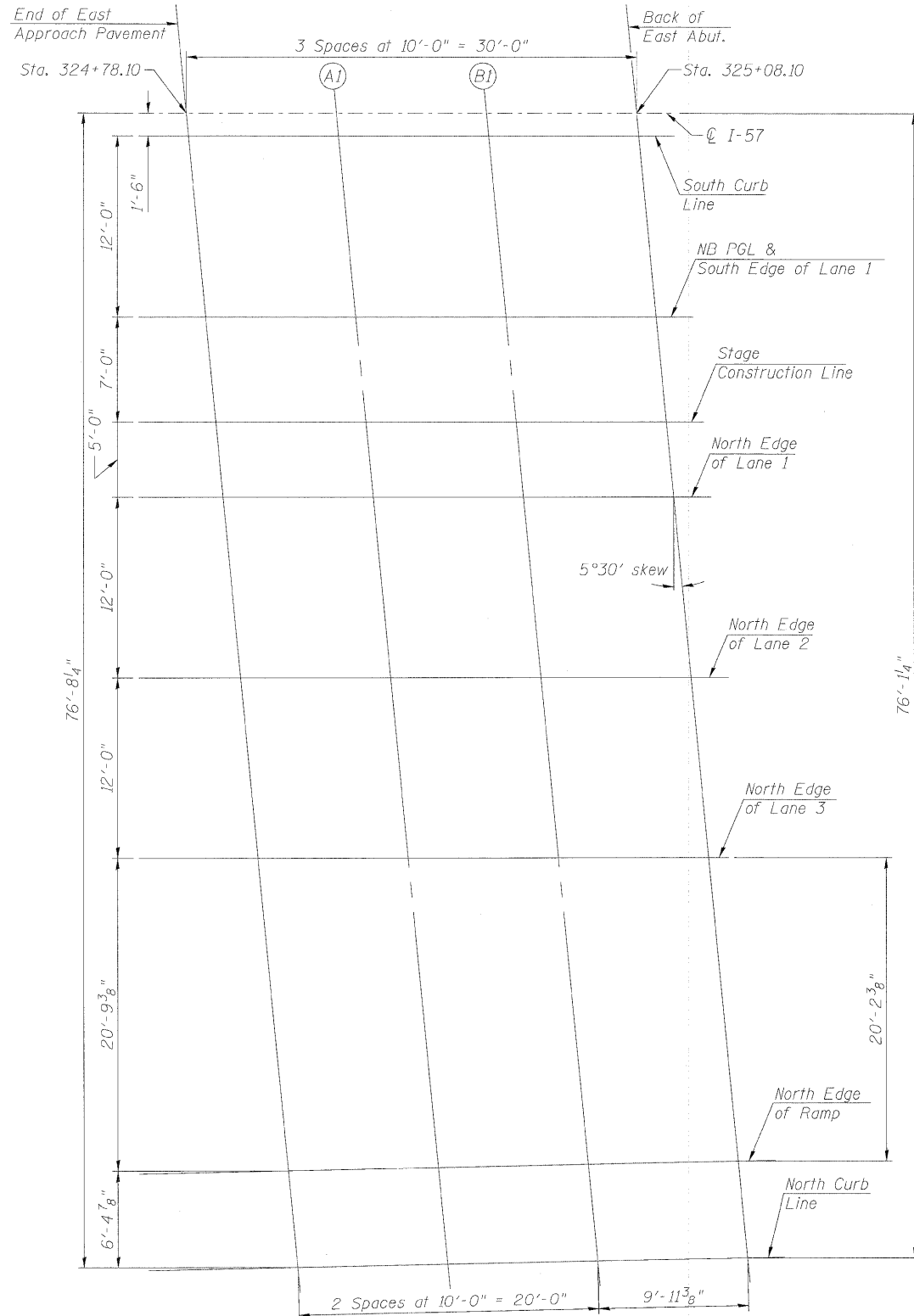

PLAN
(East Approach NB)

DESIGNED	PMH
CHECKED	MJL
DRAWN	PMH
CHECKED	MJL

SOUTH CURB LINE

Location	Station	Offset	Theoretical Grade Elevations
End E. App. Pavt	324+78.25	1.50	708.61
A1	324+88.25	1.50	708.56
B1	324+98.25	1.50	708.51
Back E. Abut.	325+08.25	1.50	708.46

NORTH EDGE OF LANE 2

Location	Station	Offset	Theoretical Grade Elevations
End E. App. Pavt	324+81.71	37.50	709.50
A1	324+91.71	37.50	709.45
B1	325+01.71	37.50	709.40
Back E. Abut.	325+11.71	37.50	709.35

NB PGL & SOUTH EDGE OF LANE 1

Location	Station	Offset	Theoretical Grade Elevations
End E. App. Pavt	324+79.40	13.50	709.09
A1	324+89.40	13.50	709.04
B1	324+99.40	13.50	708.99
Back E. Abut.	325+09.40	13.50	708.94

NORTH EDGE OF LANE 3

Location	Station	Offset	Theoretical Grade Elevations
End E. App. Pavt	324+82.87	49.50	709.31
A1	324+92.87	49.50	709.26
B1	325+02.87	49.50	709.21
Back E. Abut.	325+12.87	49.50	709.16

STAGE CONSTRUCTION LINE

Location	Station	Offset	Theoretical Grade Elevations
End E. App. Pavt	324+80.07	20.50	709.22
A1	324+90.07	20.50	709.17
B1	325+00.07	20.50	709.12
Back E. Abut.	325+10.07	20.50	709.07

NORTH EDGE OF RAMP

Location	Station	Offset	Theoretical Grade Elevations
End E. App. Pavt	324+84.87	70.28	708.88
A1	324+94.87	70.09	708.84
B1	325+04.86	69.89	708.79
Back E. Abut.	325+14.81	69.70	708.75

NORTH EDGE OF LANE 1

Location	Station	Offset	Theoretical Grade Elevations
End E. App. Pavt	324+80.56	25.50	709.32
A1	324+90.56	25.50	709.27
B1	325+00.56	25.50	709.22
Back E. Abut.	325+10.56	25.50	709.17

NORTH CURB LINE

Location	Station	Offset	Theoretical Grade Elevations
End E. App. Pavt	324+85.48	76.68	708.75
A1	324+95.48	76.49	708.71
B1	325+05.48	76.30	708.66
Back E. Abut.	325+15.43	76.11	708.61

**TOP OF EAST APPROACH
SLAB ELEVATIONS (NB)
STRUCTURE NO. 046-0146 (S.B.)
& STRUCTURE NO. 046-0147 (N.B.)**



McDonough Associates Inc.
Engineers / Architects
130 East Randolph Street
Chicago, Illinois 60601
(312) 946-8600

SHEET NO. SR-11 SHEETS SR-48	F.A.I. RTE.	SECTION	COUNTY	TOTAL SHEETS	SHEET NO.
	57	(46-2) VBR	KANKAKEE	558	338
CONTRACT NO. 66409					
FED. ROAD DIST. NO. 3 ILLINOIS FED. AID PROJECT					