

STATE OF ILLINOIS
DEPARTMENT OF TRANSPORTATION

Notes:
See sheet SR-27 of SR-48 for Sections B-B & C-C and View D-D.
a78(E), a79(E) & a81(E) to a84(E) bar spacings measured along C Rdwy.

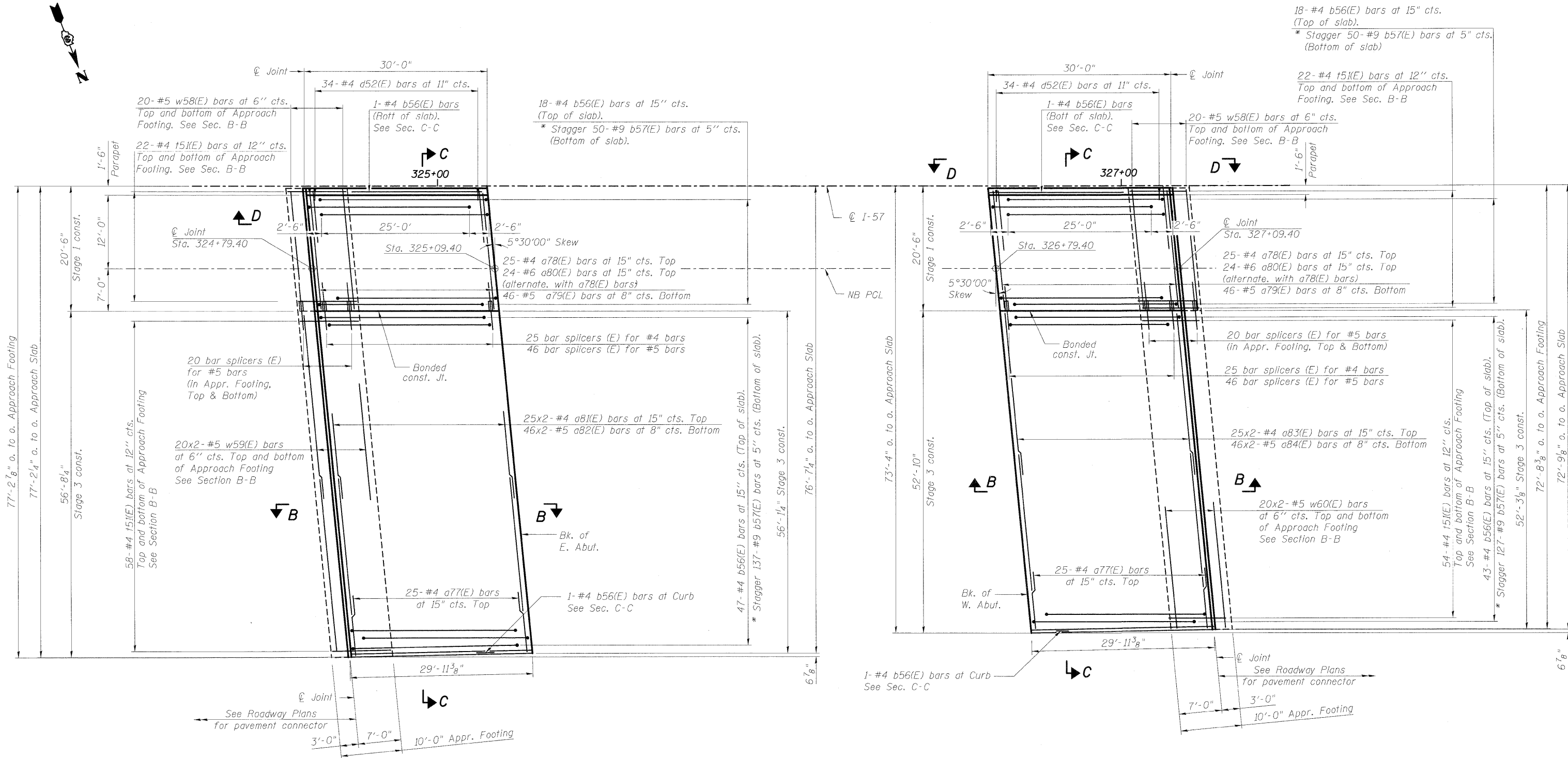

EAST APPROACH

WEST APPROACH

PLAN-(NB)

* Tilt #9 b57(E) bars as required to maintain clearance.

APPROACH SLAB PLAN (NB)
STRUCTURE NO. 046-0146 (S.B.)
& STRUCTURE NO. 046-0147 (N.B.)

DESIGNED	RJ/PMH
CHECKED	M.J.L.
DRAWN	RJ/PMH
CHECKED	M.J.L.

MIN. BAR LAP
#4 Bar = 2'-4" (Top bars)
#5 Bar = 2'-7" (Bottom bars)

McDonough Associates Inc.
Engineers / Architects
130 East Randolph Street
Chicago, Illinois 60601
(312) 946-8600

SHEET NO. SR-26 SHEETS SR-48	F.A.I. RTE.	SECTION	COUNTY	TOTAL SHEETS	SHEET NO.
	57	(46-2) VBR	KANKAKEE	558	353
CONTRACT NO. 66409					
FED. ROAD DIST. NO. 3 ILLINOIS FED. AID PROJECT					