

DATE	
BY	
SURVEYED	
PLOTTED	
NOTE BOOK	
AREAS CHECKED	
NO.	

DATE	
BY	
SURVEYED	
PLOTTED	
NOTE BOOK	
AREAS CHECKED	
NO.	

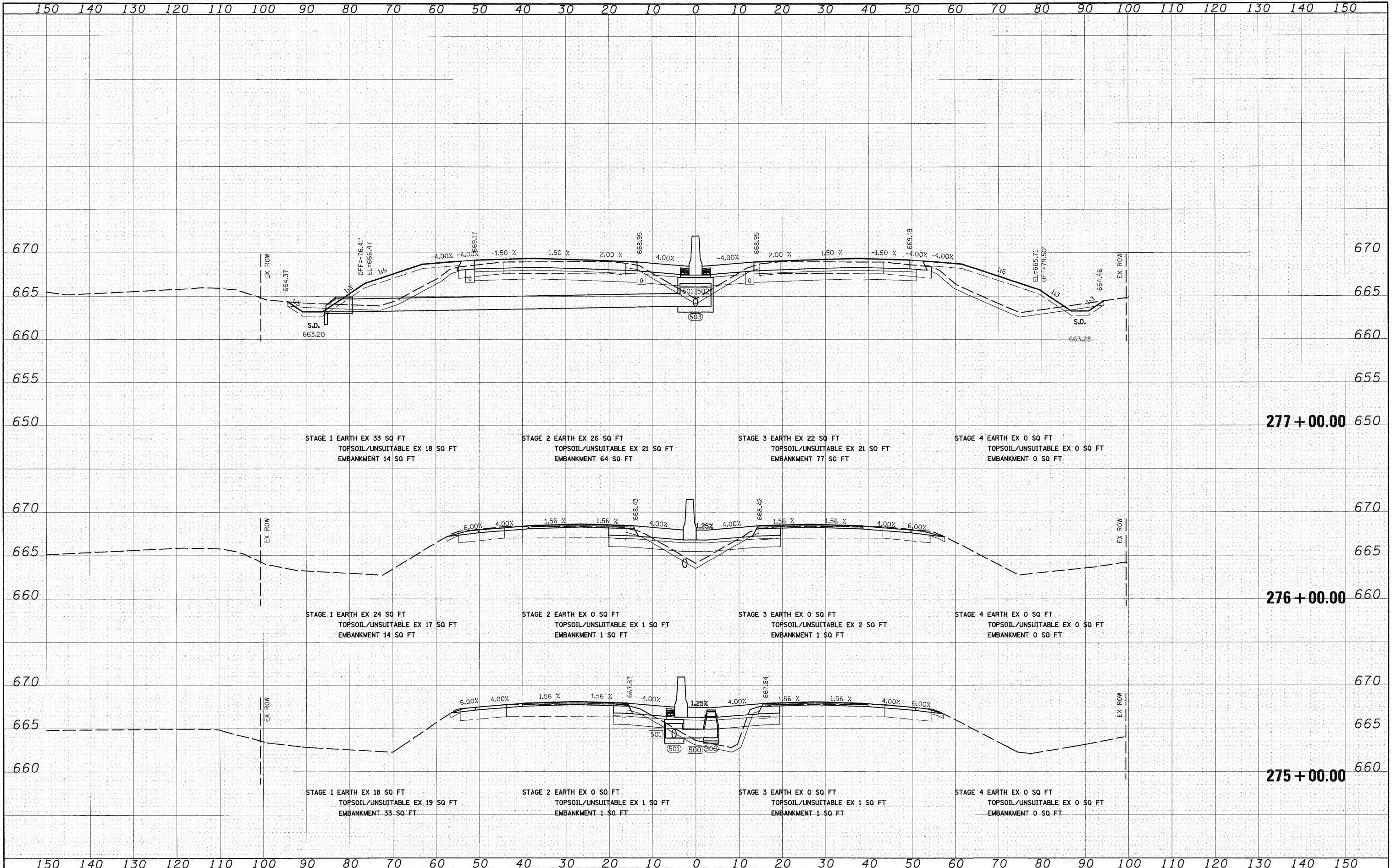

FILE NAME = J:\Dgn\sheet\xs001.dgn

USER NAME = EricG	DESIGNED - JCL	REVISED -
	DRAWN - JCL	REVISED -
	CHECKED - EUG	REVISED -
	DATE - 12/17/10	REVISED -

**STATE OF ILLINOIS  
DEPARTMENT OF TRANSPORTATION**

**I-57 CROSS SECTIONS**

SCALE: 1"=10'H; 1"=5'V SHEET NO. 2 OF 53 SHEETS STA. 275+00.00 TO STA. 277+00.00

F.A.I. RTE.	SECTION	COUNTY	TOTAL SHEETS	SHEET NO.
57	(46-2) I, HBR, VBR	KANKAKEE	558	453
<b>XS-157-02</b>		CONTRACT NO. 66409		
FED. ROAD DIST. NO. 3 ILLINOIS FED. AID PROJECT				