

|               |  |
|---------------|--|
| DATE          |  |
| BY            |  |
| SURVEYED      |  |
| PLOTTED       |  |
| NOTE BOOK     |  |
| AREAS CHECKED |  |
| NO.           |  |

|               |  |
|---------------|--|
| DATE          |  |
| BY            |  |
| SURVEYED      |  |
| PLOTTED       |  |
| NOTE BOOK     |  |
| AREAS CHECKED |  |
| NO.           |  |

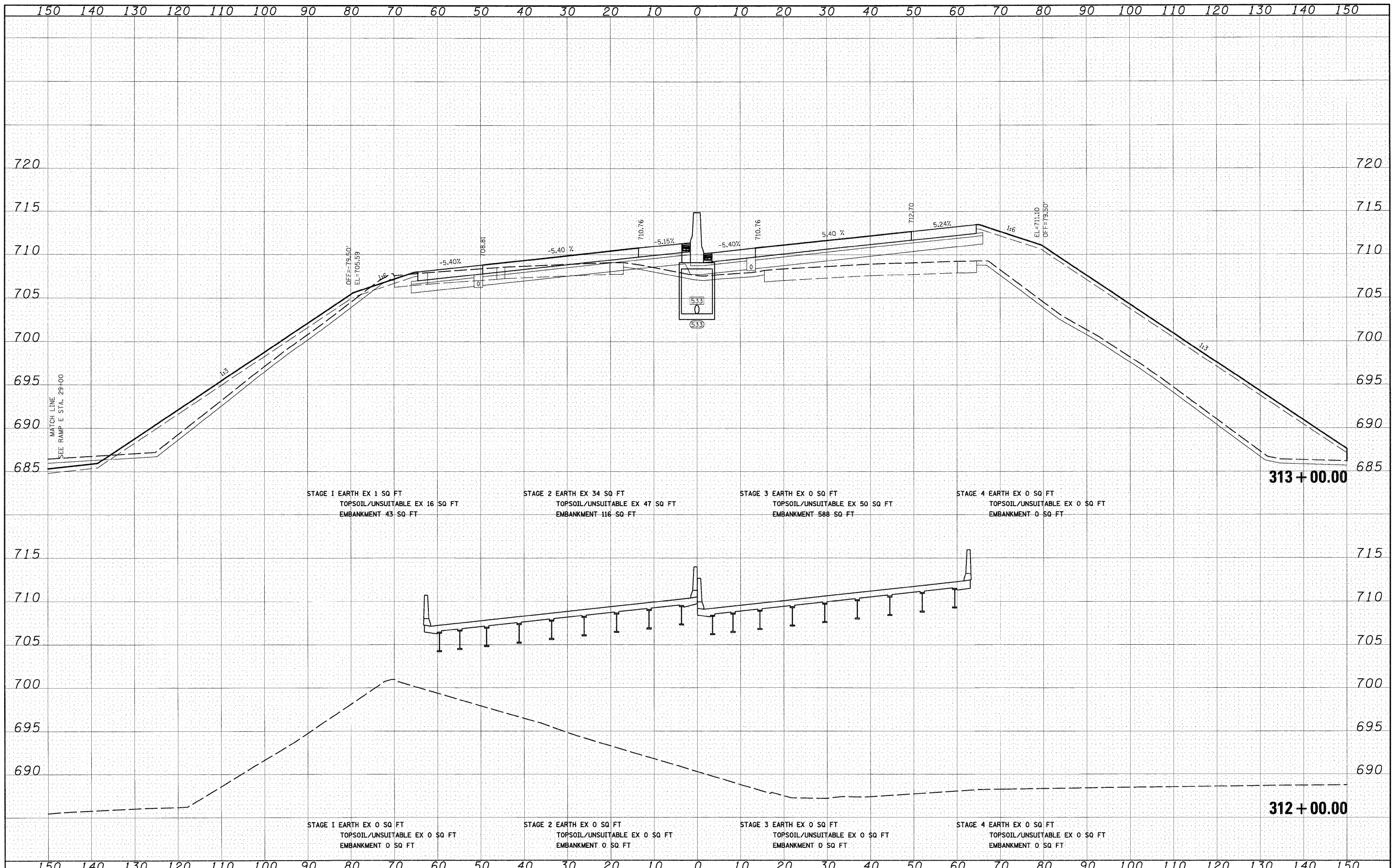

FILE NAME = I:\Dgn\Sheets\XS021.dgn

USER NAME = EricG  
 PLLOT SCALE = 1:10  
 PLOT DATE = 12/21/2010

DESIGNED - JCL  
 DRAWN - JCL  
 CHECKED - EJG  
 DATE - 12/17/10

REVISED -  
 REVISED -  
 REVISED -  
 REVISED -

**STATE OF ILLINOIS  
 DEPARTMENT OF TRANSPORTATION**

**I-57 CROSS SECTIONS**  
 SCALE: 1"=10'H; 1"=5'V SHEET NO. 22 OF 53 SHEETS STA. 312+00.00 TO STA. 313+00.00

| F.A.I. RTE.                                     | SECTION            | COUNTY             | TOTAL SHEETS | SHEET NO. |
|---|--------------------|--------------------|--------------|-----------|
| 57  | (46-2) I, HBR, VBR | KANKAKEE           | 558          | 473       |
| <b>XS-157-22</b>                                |                    | CONTRACT NO. 66409 |              |           |
| FED. ROAD DIST. NO. 3 ILLINOIS FED. AID PROJECT |                    |                    |              |           |