

FINAL SURVEY	BY	DATE
SURVEYED		
PLOTTED		
NOTE BOOK		
AREAS CHECKED		
NO.		

ORIGINAL SURVEY	BY	DATE
SURVEYED		
PLOTTED		
NOTE BOOK		
AREAS CHECKED		
NO.		

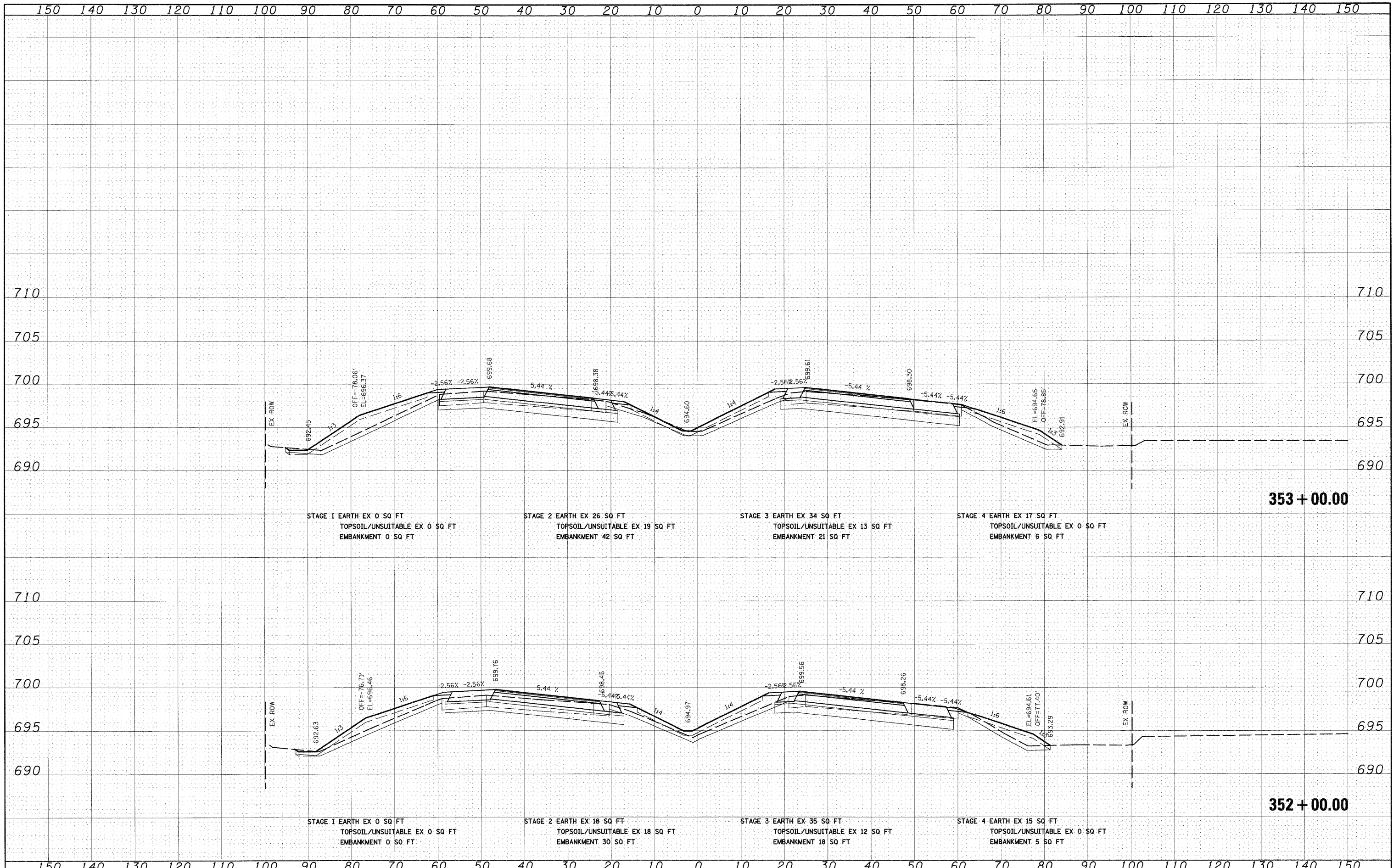

FILE NAME = I:\Dgn\sheets\xs021.dgn

USER NAME = EricG	DESIGNED - JCL	REVISED -
	DRAWN - JCL	REVISED -
	CHECKED - E.JG	REVISED -
	DATE - 12/17/10	REVISED -

**STATE OF ILLINOIS
DEPARTMENT OF TRANSPORTATION**

I-57 CROSS SECTIONS

SCALE: 1"=10'H; 1"=5'V SHEET NO. 44 OF 53 SHEETS STA. 352+00.00 TO STA. 353+00.00

F.A.I. RTE.	SECTION	COUNTY	TOTAL SHEETS	SHEET NO.
57	(46-2) I, HBR, VBR	KANKAKEE	558	495
XS-157-44		CONTRACT NO. 66409		
FED. ROAD DIST. NO. 3 ILLINOIS FED. AID PROJECT				