

**INDEX OF SHEETS**

- 1 COVER SHEET
- 2 GENERAL NOTES
- 3-4 LOCATION MAP
- 5 SUMMARY OF QUANTITIES
- 6-10 TYPICAL SECTIONS
- 11-16 SCHEDULE OF QUANTITIES
- 17-42 PAVEMENT MARKING SHEETS
- 43-46 DETECTOR LOOPS SHEETS
- 47-55 DETAILS

**STANDARDS**

- 000001-06 STANDARD SYMBOLS, ABBREVIATIONS AND PATTERNS
- 001006 DECIMAL OF AN INCH AND OF A FOOT
- 406201-01 MAILBOX TURNOUT
- 424001-05 CURB RAMPS FOR SIDEWALK
- 442101-07 CLASS B PATCHES
- 606001-04 CONCRETE CURB TYPE B AND COMBINATION CONCRETE CURB AND GUTTER
- 667101-01 PERMANENT SURVEY MARKERS
- 701001-02 OFF-ROAD OPERATIONS 2L, 2W, MORE THAN 15' (4.5 m) AWAY
- 701006-03 OFF-ROAD OPERATIONS 2L, 2W, 15' (4.5 m) TO 24" (600 mm) FROM PAVEMENT EDGE
- 701011-02 OFF-ROAD MOVING OPERATIONS 2L, 2W, DAY ONLY
- 701301-04 LANE CLOSURE, 2L, 2W, SHORT TIME OPERATIONS
- 701306-03 LANE CLOSURE, 2L, 2W, SLOW MOVING OPERATIONS DAY ONLY, FOR SPEEDS ≥ 45 MPH
- 701501-06 URBAN LANE CLOSURE, 2L, 2W, UNDIVIDED
- 701502-04 URBAN LANE CLOSURE 2L, 2W, WITH BIDIRECTIONAL LEFT TURN LANE
- 701606-07 URBAN LANE CLOSURE, MULTILANE, 2W WITH MOUNTABLE MEDIAN
- 701801-04 LANE CLOSURE, MULTILANE 1W OR 2W CROSSWALK OR SIDEWALK CLOSURE
- 701901-01 TRAFFIC CONTROL DEVICES
- 780001-02 TYPICAL PAVEMENT MARKINGS
- 781001-03 TYPICAL APPLICATIONS RAISED REFLECTIVE PAVEMENT MARKERS
- 886001-01 DETECTOR LOOP INSTALLATIONS
- 886006-01 TYPICAL LAYOUT FOR DETECTION LOOPS

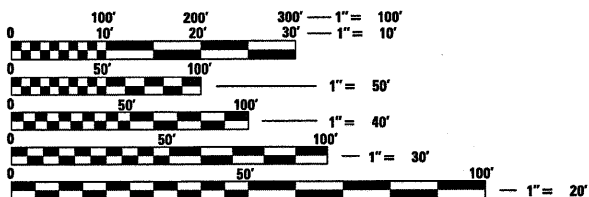

FULL SIZE PLANS HAVE BEEN PREPARED USING STANDARD ENGINEERING SCALES. REDUCED SIZED PLANS WILL NOT CONFORM TO STANDARD SCALES. IN MAKING MEASUREMENTS ON REDUCED PLANS, THE ABOVE SCALES MAY BE USED.

**J.U.L.I.E.**  
**JOINT UTILITY LOCATION INFORMATION FOR EXCAVATION**  
 1-800-892-0123  
 OR 811

**PROJECT ENGINEER: JOE KANNEL**  
**UNIT CHIEF: PAT BRABOY**

**CONTRACT NO. 66A10**

**STATE OF ILLINOIS**  
**DEPARTMENT OF TRANSPORTATION**  
**DIVISION OF HIGHWAYS**  
**PROPOSED**  
**HIGHWAY PLANS**

**FAP ROUTE 623 (US 6)**  
**SECTION 17RS-3; 33RS-5; (34R)RS**  
**PROJECT : F-0623(029)**  
**TYPE of IMPROVEMENT-3P RESURFACING**  
**BUREAU AND LASALLE COUNTY**

**C-93-084-10**

OMIT SN 050-0027

PROJECT ENDS WEST ABUT. LITTLE  
 VERMILLION RIVER BR. STA 332+56

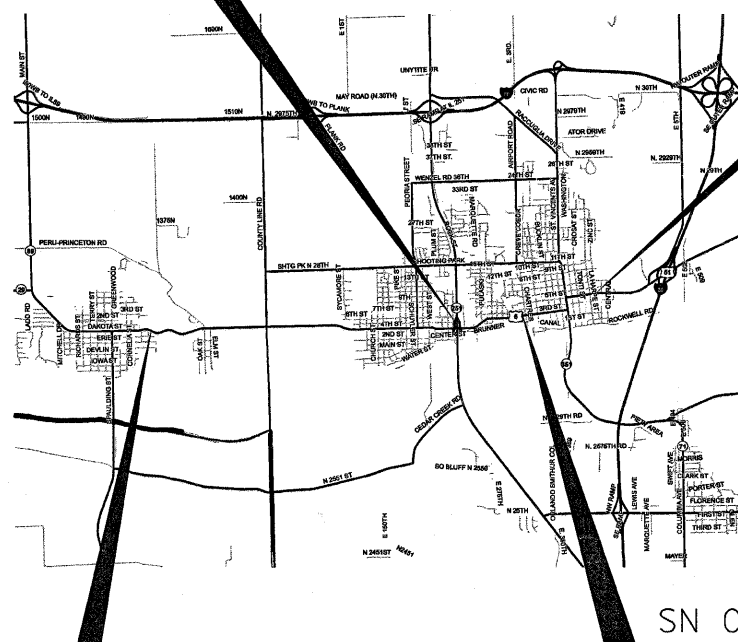

SN 050-2026

PROJECT BEGINS STA. 30+47.30

BRIDGE OMISSION STA. 216+48.79 TO STA. 217+97.29

GROSS LENGTH = 30,208.7 FT. = 5.72 MILE  
 NET LENGTH = 30,060.2 FT. = 5.69 MILE

F.A.P. RTE.	SECTION	COUNTY	TOTAL SHEETS	SHEET NO.
623	17RS-3; 33RS-5; (34R)RS	ILLINOIS	55	1

CONTRACT NO. 66A10

\*BUREAU/LASALLE

**D-93-035-10**

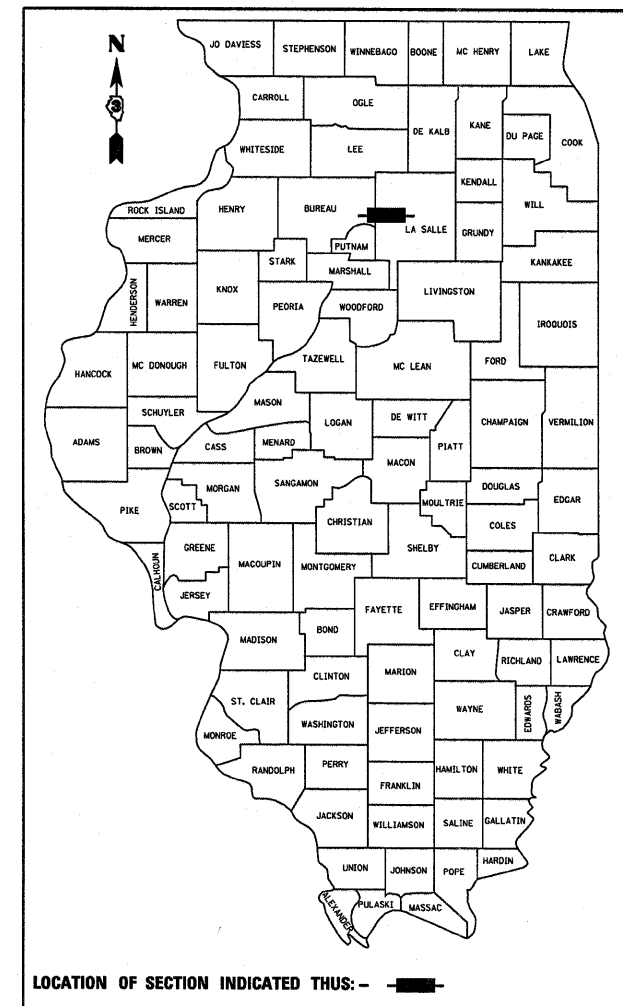

**FUNCTIONAL CLASSIFICATION**  
**OTHER PRINCIPAL ARTERIAL-EAST OF IL 251**  
**MINOR ARTERIAL-WEST OF IL 251**  
**2009 ADT-13400**  
**PV = 95.7% MU = 1.5% SU = 2.8%**

**STATE OF ILLINOIS**  
**DEPARTMENT OF TRANSPORTATION**  
**DIVISION OF HIGHWAYS**

SUBMITTED February 15, 20 11  
Eric S. Trinkel  
 DEPUTY DIRECTOR OF HIGHWAYS, REGION ENGINEER

March 25, 20 11  
Scott E. Stitt P.E./a  
 acting ENGINEER OF DESIGN AND ENVIRONMENT

March 25, 20 11  
Christine M. Reed/a  
 DIRECTOR OF HIGHWAYS, CHIEF ENGINEER

**PRINTED BY THE AUTHORITY**  
**OF THE STATE OF ILLINOIS**